

Legal Description
Bosenberg Alley Closure

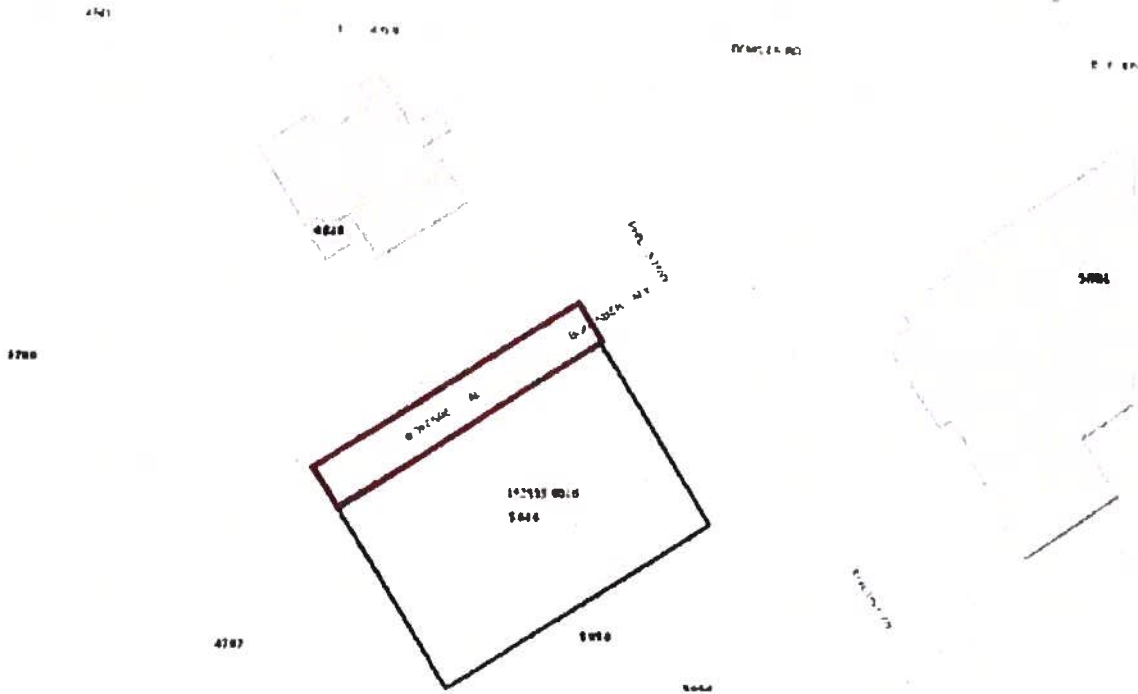

THAT PORTION OF BOSENBERG ALLEY, AS SHOWN ON THE REPLAT OF BOWDENDALE, AS RECORDED IN PLAT BOOK 12 PAGE 54 OF THE CURRENT PUBLIC RECORDS OF DUVAL COUNTY, FLORIDA; LYING NORTHWEST OF LOT 20, OF BLOCK TWO, OF THE AFOREMENTIONED PLAT, AND BEING BOUNDED ON THE NORTHEAST BY PHILLIPS HIGHWAY (FORMERLY KNOWN AS TERMINAL AVENUE), AND ON THE SOUTHWEST BY THE SOUTHWESTERLY LINE OF SAID BLOCK 2.

APPROVED
DESCRIPTION AGREES
WITH MAP
CITY ENGINEERS OFFICE
TOPO/SURVLY BRANCH
By *DW* Date *6-25-21*

Street Map – Bosenberg Alley Closure



Satellite Aerial – Bosenberg Alley ROW Closure

