

STRUCTURES AND VUA PROHIBITED
IN THIS AREA NOTED AS "STORMWATER
FACILITY."

PLANT MATERIAL PER CH. 656, PART 12
IN 10 FT. BUFFER

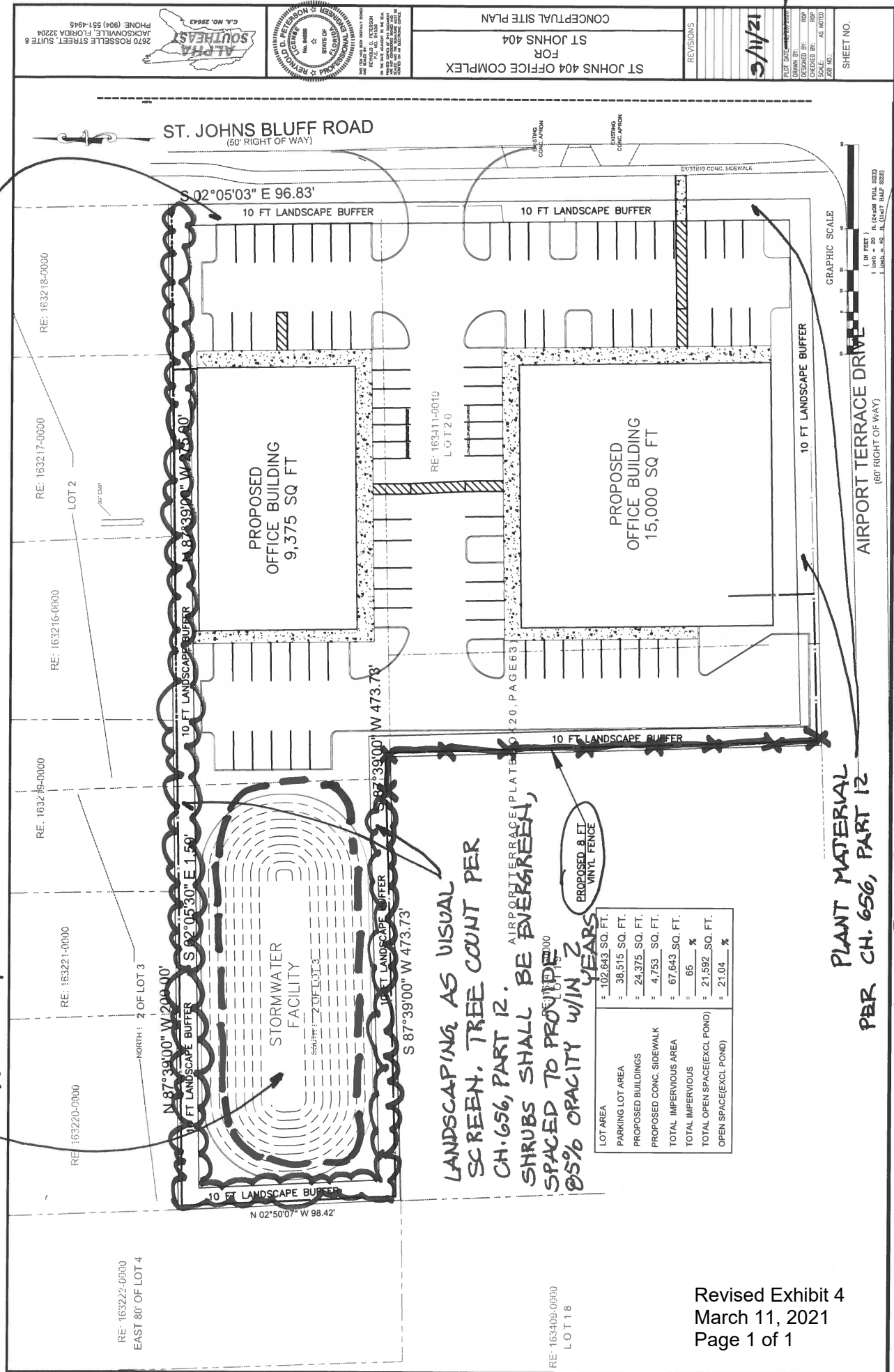

LANDSCAPING AS VISUAL
SCREEN. TREE COUNT PER
CH. 656, PART 12.
SHRUBS SHALL BE EVERGREEN,
SPACED TO PROVIDE
85% OPACITY w/in 2
YEARS

AIRPORT TERRACE DRIVE PLANTING
PROPOSED 8 FT
VINYL FENCE

LOT AREA	= 102,643 SQ. FT.
PARKING LOT AREA	= 38,515 SQ. FT.
PROPOSED BUILDINGS	= 24,375 SQ. FT.
PROPOSED CONC. SIDEWALK	= 4,753 SQ. FT.
TOTAL IMPERVIOUS AREA	= 67,643 SQ. FT.
TOTAL IMPERVIOUS	= 65 %
TOTAL OPEN SPACE(EXCL POND)	= 21,592 SQ. FT.
OPEN SPACE(EXCL POND)	= 21.04 %

Revised Exhibit 4
March 11, 2021
Page 1 of 1

2670 ROSSELLE STREET, SUITE 8
JACKSONVILLE, FLORIDA 32204
PHONE (904) 551-4945



ST JOHNS 404 OFFICE COMPLEX
FOR
ST JOHNS 404
CONCEPTUAL SITE PLAN

NO.	DATE	DESCRIPTION
1		
2		
3		
4		
5		
6		
7		
8		
9		
10		
11		
12		

SHEET NO.

2020-607



GRAPHIC SCALE
1" = 40'
1" = 40' (US 1/4" HALF SIZE)

PLANT MATERIAL
PAR CH. 656, PART 12
IN 10 FT. BUFFER