

NOTES:  
 1. DRIVEWAYS, SIDEWALKS, LANDSCAPING, DRIVEWAYS AND/OR PARKING AREAS MAY BE MODIFIED, IF NECESSARY, BASED ON FINAL SURVEY, DESIGN AND PERMITTING, OR TO COMPLY WITH LANDSCAPING REQUIREMENTS OR TO IMPROVE OR ADD TO THE AESTHETICS OF THE SITE.  
 2. ALL THE FACILITIES AND ELEMENTS OF THE SITE SHALL MEET THE REQUIREMENTS OF THE FLORIDA ACCESSIBILITY CODE FOR BUILDING CONSTRUCTION (FAC) AND THE FLORIDA ACCESSIBILITY STANDARDS FOR ACCESSIBLE DESIGN AND THE FAIR HOUSING ACT, IF APPLICABLE.

**LAND USE TABLE**

TOTAL GROSS ACREAGE:	4.33 AC.	100%
SINGLE FAMILY:	0 AC.	0%
TOTAL NUMBER OF DWELLING UNITS:	0 D.U.	
MULTIPLE FAMILY:	0.70 AC.	16%
TOTAL NUMBER OF DWELLING UNITS:	35 D.U.	
INDUSTRIAL:	0 AC.	0%
OTHER LAND USE (PARCEL A):	2.28 AC.	53%
COMMERCIAL (UP TO 62,000 S.F. PER PUD):		
ACTIVE RECREATION AND/OR OPEN SPACE:	0 AC.	0%
PASSIVE OPEN SPACE:	1.06 AC.	25%
PUBLIC AND PRIVATE RIGHT-OF-WAY:	0 AC.	0%
MAXIMUM IMPERVIOUS SURFACE COVERAGE OF BUILDINGS AND STRUCTURES:	3.95 AC.	90%
PARCEL A = 62,000 S.F.	1.42 AC.	32.8%

**LAND OWNER:** EAST SAN MARCO, LLC  
 JACKSONVILLE, FLORIDA 32202  
**ATTN:** CHRIS RUIEN/PATRICK MCKINLEY

**DEVELOPER:** REGENCY CENTERS  
 1 INDEPENDENT DRIVE, SUITE 114  
 JACKSONVILLE, FLORIDA 32202  
**ATTN:** CHRIS RUIEN/PATRICK MCKINLEY

**ARCHITECT:** TORI GALLAS & PARTNERS  
 1300 SPRING STREET, 4TH FLOOR  
 SUITE 3000, WORTLAND 20910  
**ATTN:** MICHAEL ROLLISON

**ENGINEER:** ENGLAND-THOMAS & MILLER, INC.  
 14725 OLD ST. AUGUSTINE RD.  
 JACKSONVILLE, FL 32238  
 (904) 842-8890

**SURVEYOR:** A & J LAND SURVEYORS, INC.  
 5847 LUELLA STREET  
 JACKSONVILLE, FLORIDA 32207  
 (904) 346-1733

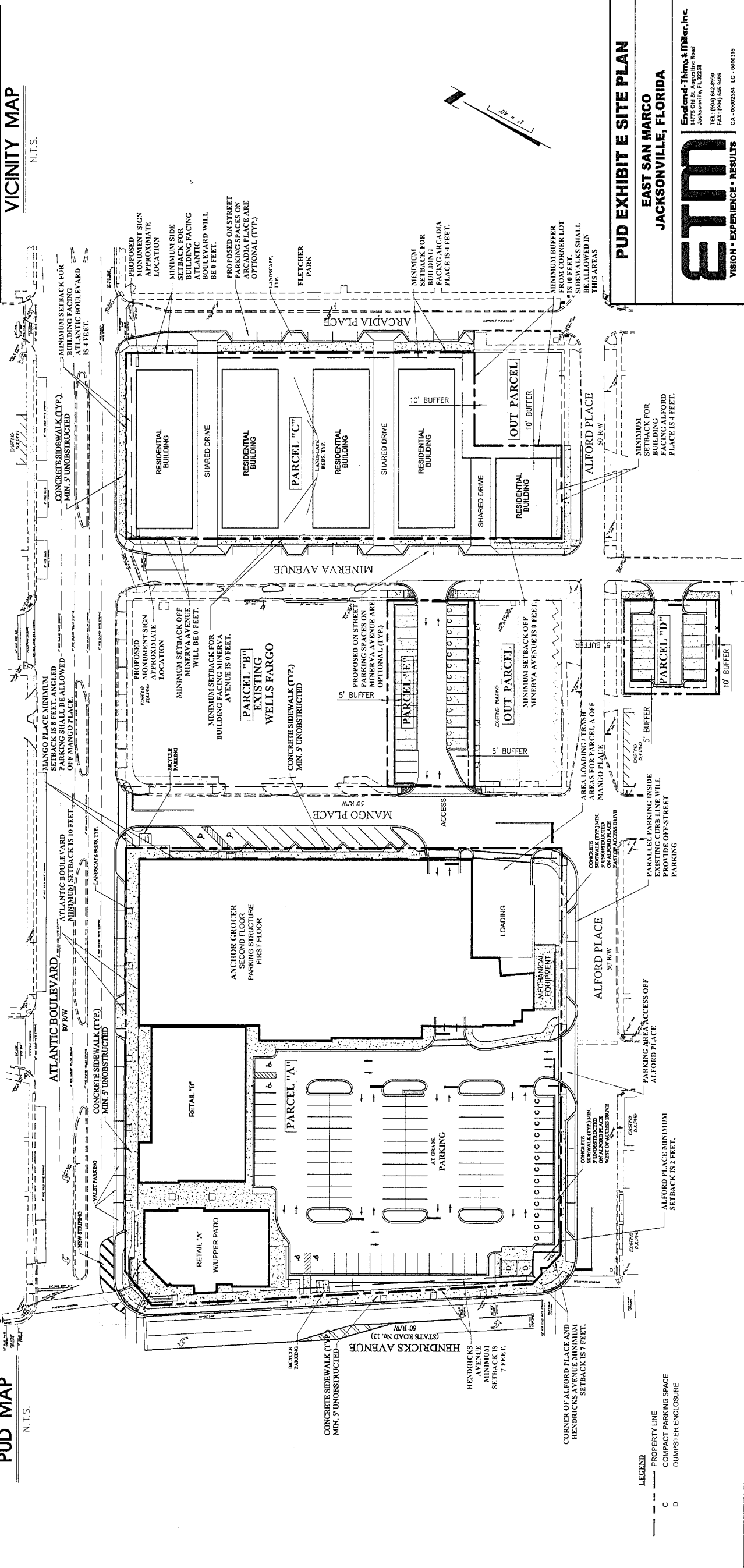
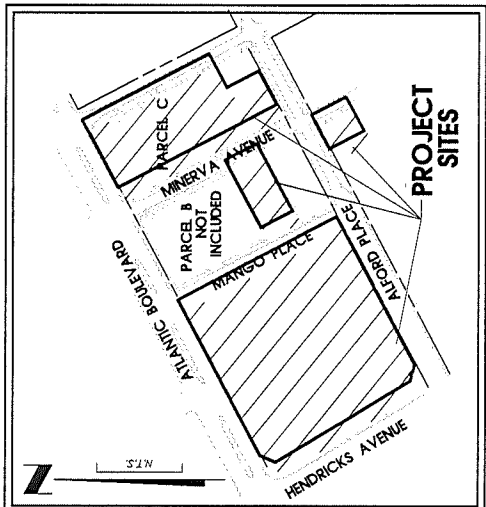
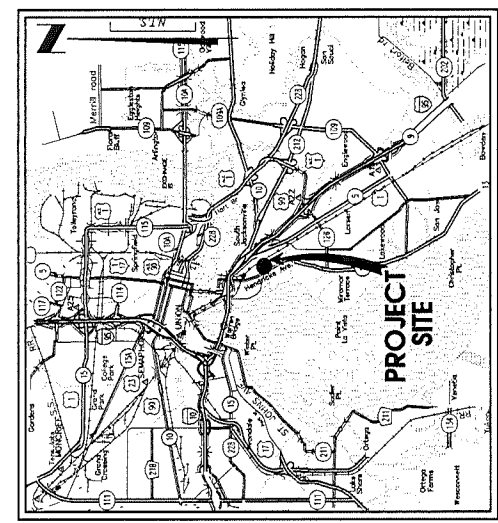

**PUD EXHIBIT E SITE PLAN**

**EAST SAN MARCO JACKSONVILLE, FLORIDA**

**ETM**  
 VISION • EXPERIENCE • RESULTS

Eastland-Thoms & Miller, Inc.  
 11775 Old St. Augustine Road  
 Jacksonville, FL 32238  
 TEL: (904) 842-2990  
 FAX: (904) 846-8485  
 CA - 00002584 LC - 0000316