

SITE PLAN

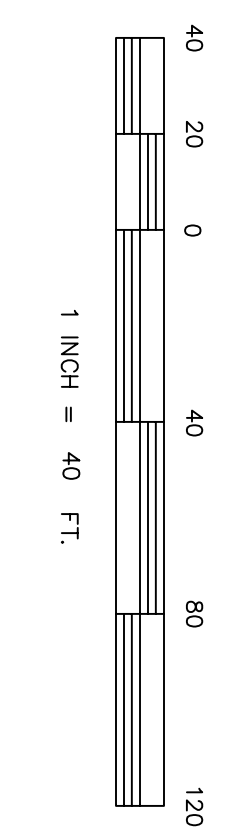
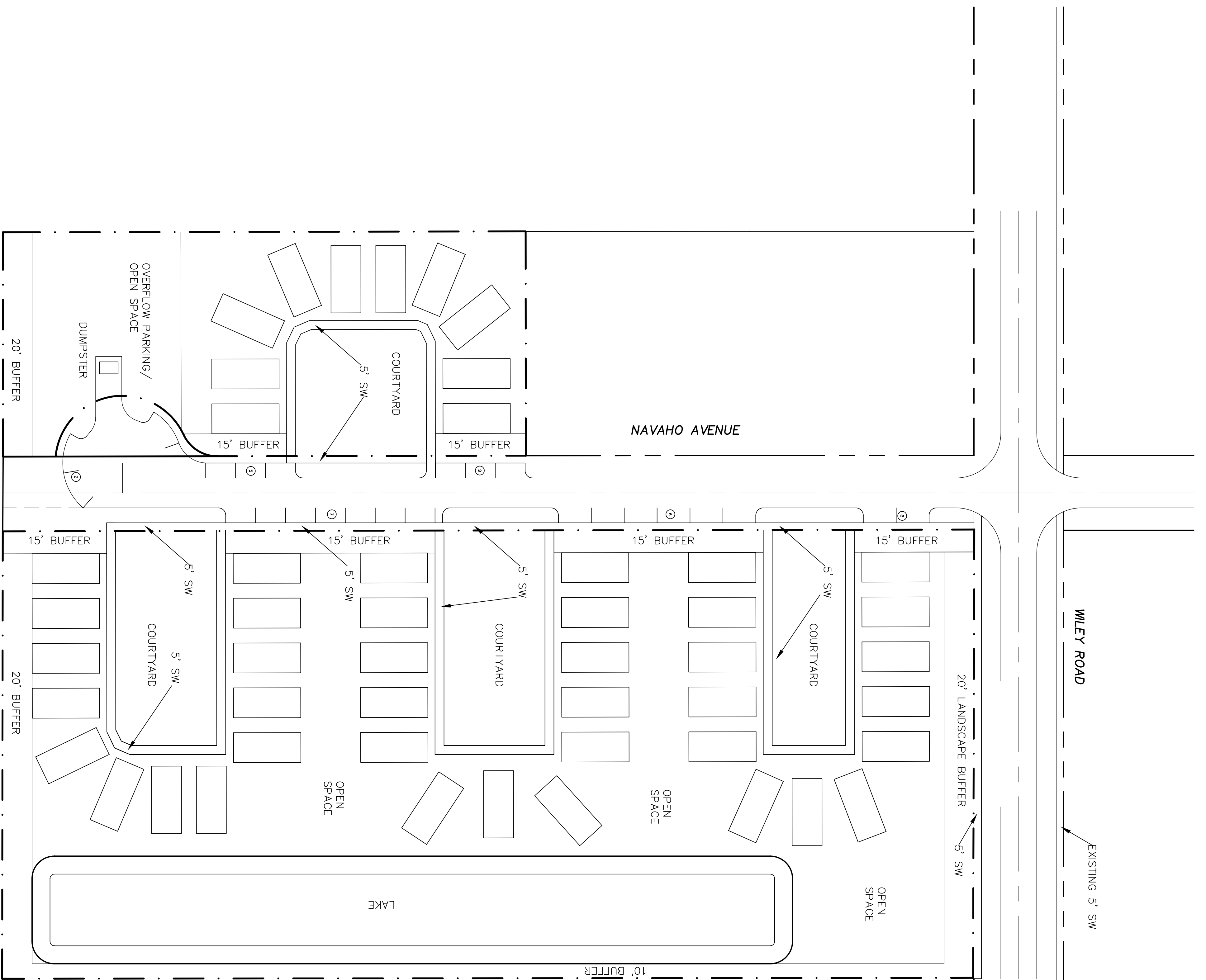
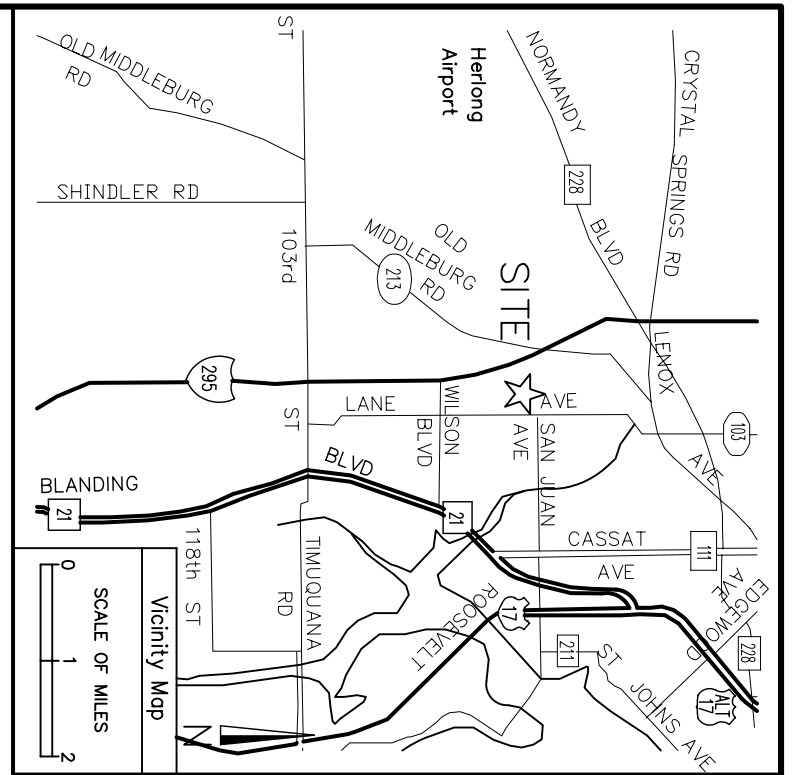

October 4, 2019
 Exhibit 4
 Page 1 of 1

STATS:

RESIDENTIAL	1.01 AC	17.9% (HOME AREA ONLY)
OPEN SPACE	3.34 AC	58.9%
PASSIVE	0.84 AC	14.7%
ROADS	0.48 AC	08.5%
TOTAL	5.67 AC	100%

STATS:

TOTAL NUMBER OF HOMES	50
TOTAL AREA:	5.67 AC
DENSITY:	8.82 HOMES PER ACRE
PRESENT ZONING:	RMD-B
PROPOSED ZONING:	PUD
OPEN SPACE:	3.5 AC

PRELIMINARY SITE PLAN OF
 WILEY ROAD
 RENTAL COMMUNITY
 FOR
 GUILCO INVESTMENTS, INC.

NO.	REVISION	BY	DATE

VERSION: ACAD20
 DRAWN BY: SBD
 DESIGNED BY: JML
 APPROVED BY: JML
 DATE: OCTOBER 2019

J. LUCAS & ASSOCIATES, INC.
 CONSULTING AND DESIGN ENGINEERS
 CERTIFICATE OF AUTHORIZATION NO. 3981
 1305 CEDAR STREET - JACKSONVILLE, FL 32207
 PH (904) 396-3060 FAX (904) 396-3456

SEAL & SIGNATURE:
 JAMES W. LUCAS, P.E. (B3370)
 DRAWING NO. _____ OF _____
 JOB NO. 1909
 FILE: 1909PSP