

SKETCH AND LEGAL DESCRIPTION OF:

THAT PORTION OF WEST MONROE STREET, CLOSED BY ORDINANCE 2003-657-E, (FORMERLY A 70.00 FOOT RIGHT OF WAY), LYING WESTERLY OF THE WESTERLY RIGHT OF WAY LINE OF JULIA STREET, (60.00 FOOT RIGHT OF WAY), AND EASTERLY OF THE WESTERLY RIGHT OF WAY LINE OF PEARL STREET, (A 60.00 FOOT RIGHT OF WAY).

TOGETHER WITH:

THAT PORTION OF PEARL STREET, CLOSED BY ORDINANCE 2003-657-E, (FORMERLY A 60 FOOT RIGHT OF WAY), LYING SOUTHERLY OF THE SOUTHERLY RIGHT OF WAY LINE OF WEST DUVAL STREET, (70.00 FOOT RIGHT OF WAY), AND NORTHERLY OF THE NORTHERLY RIGHT OF WAY LINE OF WEST ADAMS STREET, (A 70.00 FOOT RIGHT OF WAY).

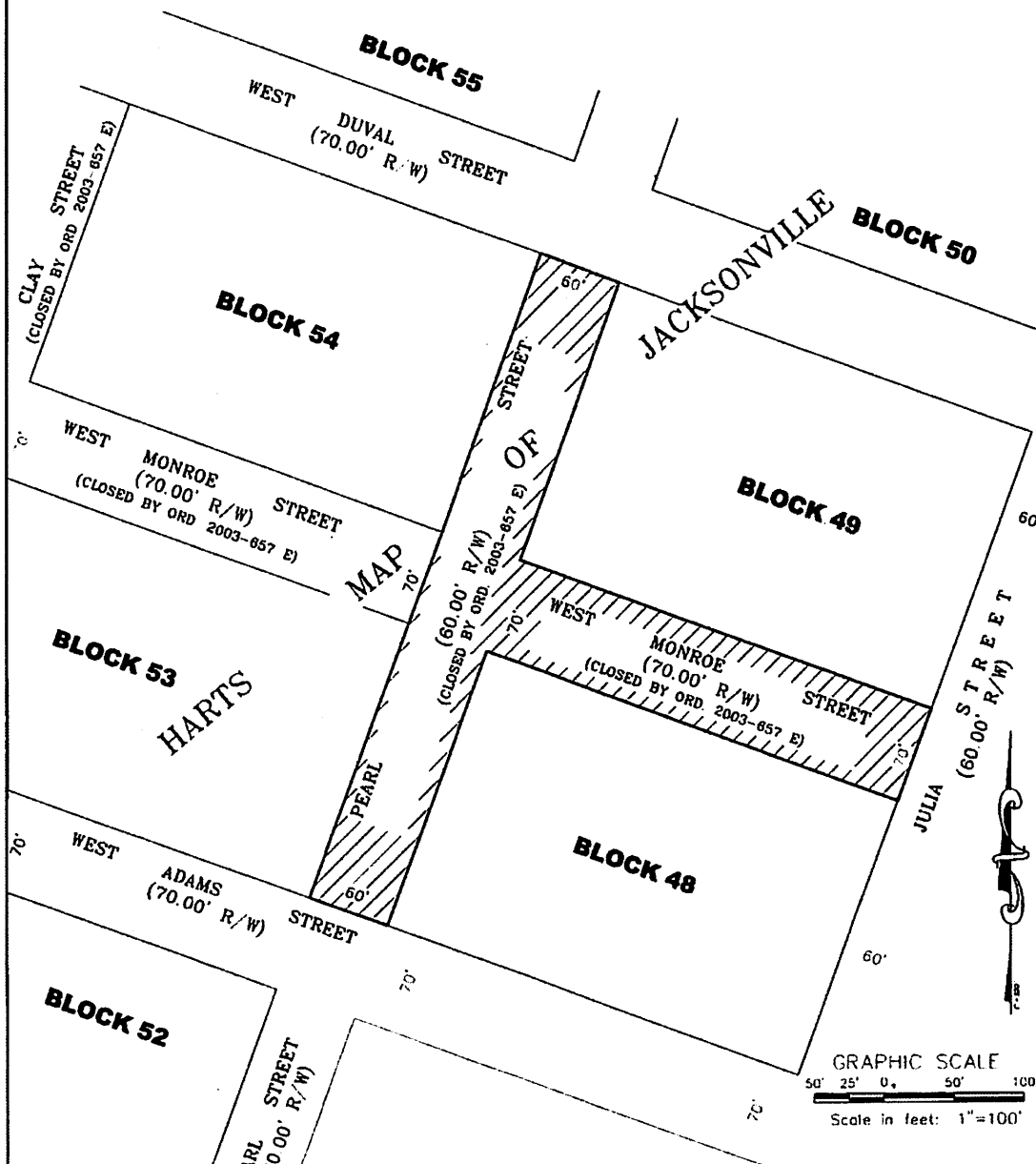

- NOTES:**
1. THIS IS NOT A FIELD SURVEY.
 2. ALL DISTANCES AS SHOWN HEREON WERE TAKEN FROM PUBLIC RECORDS.

CERTIFICATION
 THIS IS TO CERTIFY THAT THIS SKETCH WAS MADE UNDER THE UNDERSIGNED'S RESPONSIBLE DIRECTION AND SUPERVISION, THAT THE SKETCH DATA COMPLIES WITH ALL OF THE REQUIREMENTS FOR MINIMUM TECHNICAL STANDARDS FOR LAND SURVEYORS IN THE STATE OF FLORIDA (CHAPTER NO. 5J 17.050) (052), F.A.C.).

UNLESS IT BEARS THE SIGNATURE AND THE ORIGINAL RAISED SEAL OF A FLORIDA LICENSED SURVEYOR AND MAPPER THIS MAP/REPORT IS FOR INFORMATIONAL PURPOSES ONLY AND IS NOT VALID

CITY OF JACKSONVILLE, 214 N HOGAN STREET 10th FLOOR JACKSONVILLE, FLORIDA 32202	ENGINEERING DIVISION DEPARTMENT OF PUBLIC WORKS (904) 255-8760	LEGEND <input type="checkbox"/> CONCRETE MONUMENT X--X FENCE <input type="checkbox"/> NAIL <input type="checkbox"/> IRON PIPE X CROSS CUT SHEET NO 1 OF 1
<i>Danny S. Wheeler</i> DANNY S. WHEELER, P.L.S. FLORIDA REGISTRATION NUMBER 6902 10th FLOOR, 214 N HOGAN STREET 32202 (904)-255-8760		
DATE: 8-27-19	SCALE: 1"=100'	
ROAD NO.:	ER NO.:	