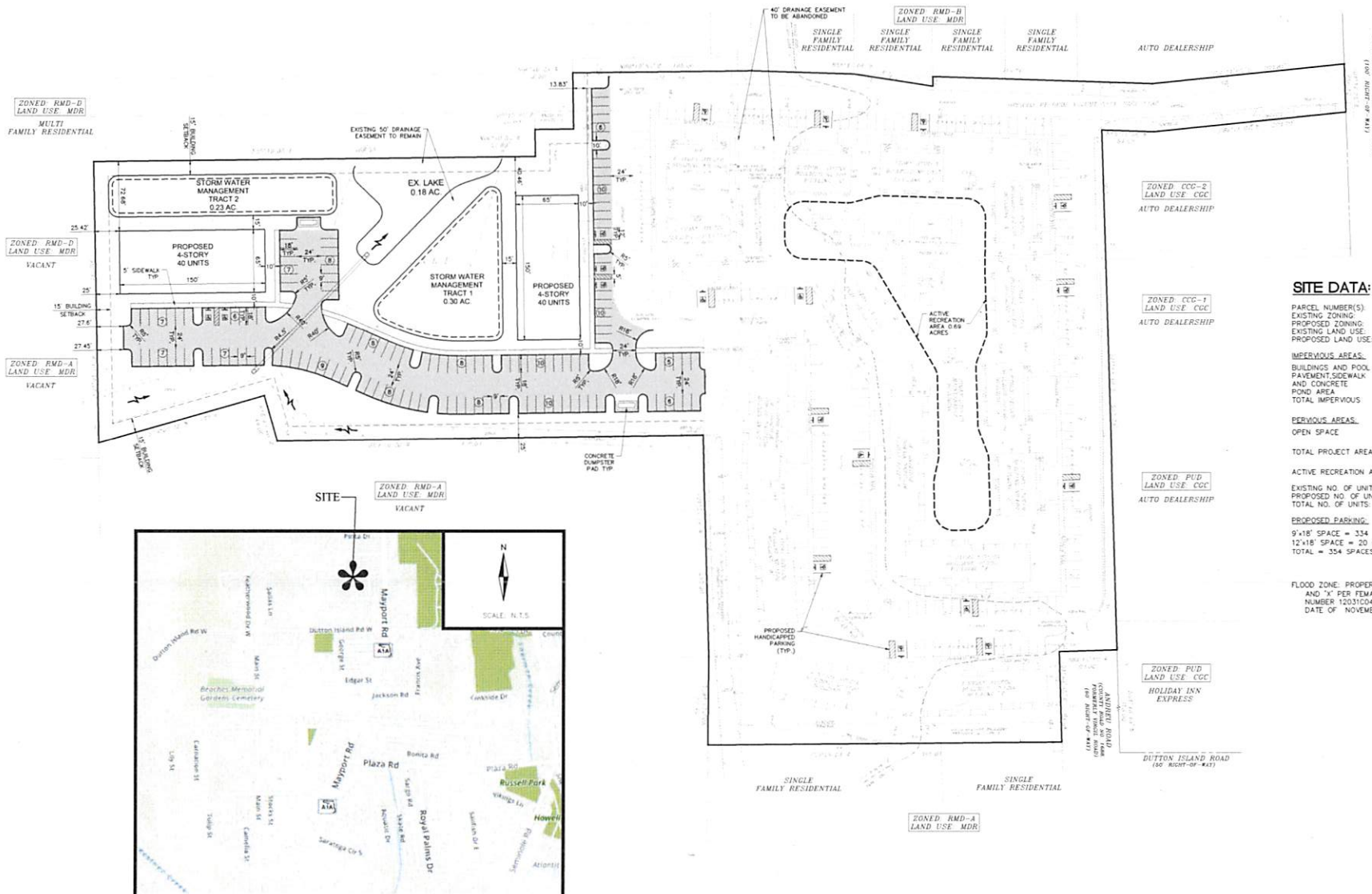

Exhibit "X"



SITE DATA:

PARCEL NUMBER(S)	169421-0010
EXISTING ZONING	RMD-A, RMD-D
PROPOSED ZONING	PUD
EXISTING LAND USE	MOR
PROPOSED LAND USE	MOR

IMPERVIOUS AREAS:	
BUILDINGS AND POOL PAVEMENT, SIDEWALK AND CONCRETE	75,448 SF 1.73 AC 15.4%
POND AREA	31,207 SF 0.72 AC 6.4%
TOTAL IMPERVIOUS	281,294 SF 6.46 AC 57.6%

PERVIOUS AREAS:	
OPEN SPACE	207,066 SF 4.75 AC 42.4%
TOTAL PROJECT AREA:	488,360 SF 11.21 AC 100%

ACTIVE RECREATION AREA = 0.69 AC

EXISTING NO. OF UNITS: 120
 PROPOSED NO. OF UNITS: 80
 TOTAL NO. OF UNITS: 200

PROPOSED PARKING:
 9'x18' SPACE = 334
 12'x18' SPACE = 20 (A.D.A.)
 TOTAL = 354 SPACES (1.77 SPACES/UNIT)

FLOOD ZONE: PROPERTY LOCATED IN FLOOD ZONE 'A' AND 'X' PER FEMA FLOOD INSURANCE RATE MAP NUMBER 12031C0406J AND 12031C0408J WITH A DATE OF NOVEMBER 2 2016

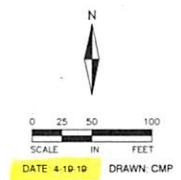
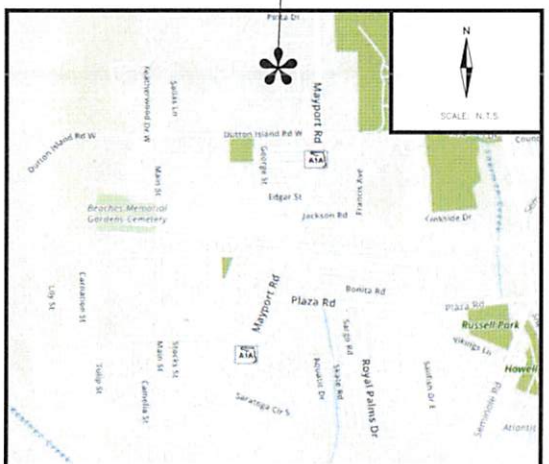

MARINERS VILLAGE PUD JACKSONVILLE, FL