



Checkers #3266  
Estimate #: N/A / Job # J0001999  
7504 Atlantic Blvd  
Jacksonville, FL  
October 25, 2022



**Allen Industries**

YOUR BRAND AT ITS BEST™

1-800-967-2553  
[www.allenindustries.com](http://www.allenindustries.com)

Customer Approval / Signature \_\_\_\_\_  
Signature: \_\_\_\_\_ Date: \_\_\_\_\_

Site Plan

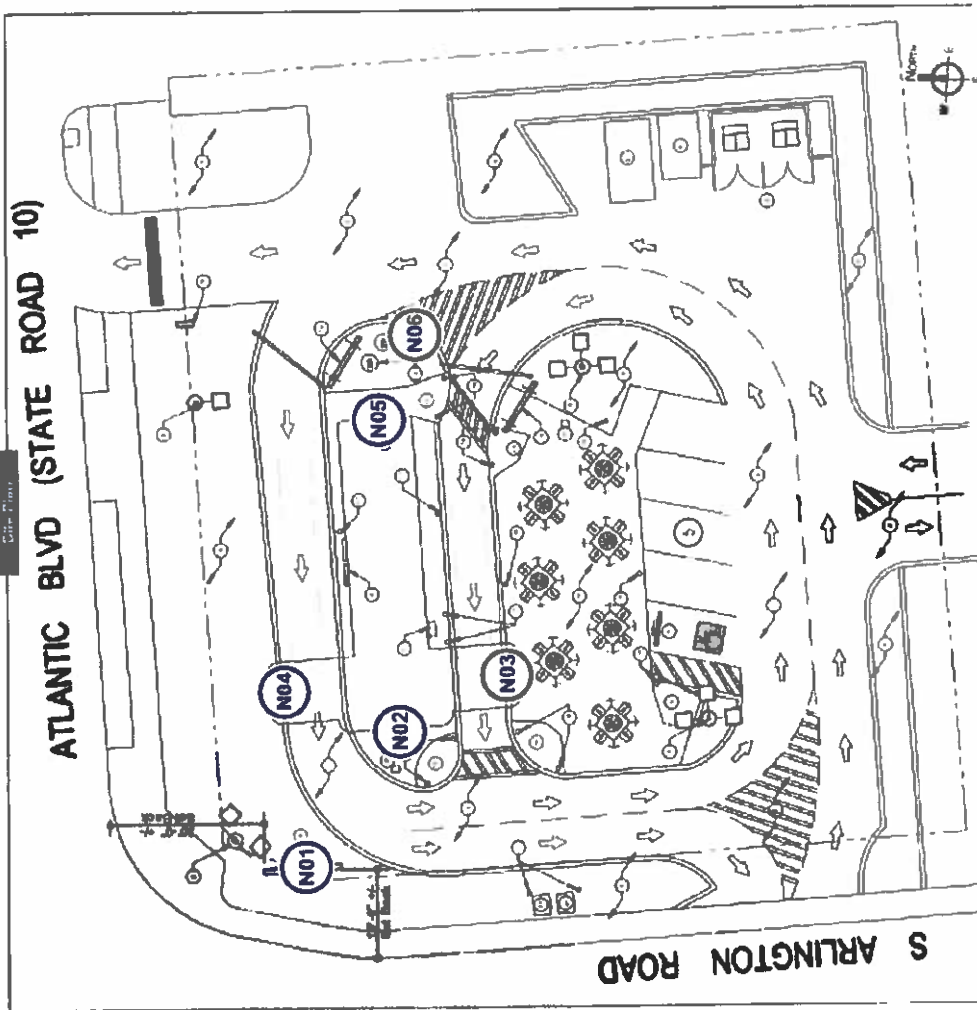

- Sign Legend**
- (N01)** Pylon (Face Replacement)
  - (N02)** 28" Remote Channel Letters (Main Tower Mount)
  - (N03)** 28" Remote Channel Letters (Canopy Mount)
  - (N04)** 28" Remote Channel Letters (Canopy Mount)
  - (N05)** Restroom Sign
  - (N06)** Directional Sign

**Allen Industries**  
 YOUR TRADING AT ITS BEST™  
 1-800-967-2553  
 www.allenindustries.com

**Client Building Station**  
 Allen Industries, Inc. requests that an approved drawing be obtained from the client prior to any production release or production release revision.  
 L. Allen Industries, Inc.      Approved Date:

---

**Project:** 100022 New Direction for Pylon Faces  
 100022 Distant Buildings  
 100022 Front Entrance Overlay  
 100022 New Entrance Interiors / 13 to 4.5k Ft. Or

**Client:** City of Jacksonville  
**Address:** 100022 New Direction for Pylon Faces  
 100022 Distant Buildings  
 100022 Front Entrance Overlay  
 100022 New Entrance Interiors / 13 to 4.5k Ft. Or

---

**Drawn:** J.P.P.  
**Checked:** J.P.P.  
**Scale:** 1/8" = 1'-0"

**Project:** 2  
**File No.:** CHX\_2006-0001000\_Jacksonville, FL\_304  
**Scale:** 1/8" = 1'-0"

---

**Project:** 2  
**File No.:** CHX\_2006-0001000\_Jacksonville, FL\_304  
**Scale:** 1/8" = 1'-0"

**Client:** City of Jacksonville  
**Address:** 100022 New Direction for Pylon Faces  
 100022 Distant Buildings  
 100022 Front Entrance Overlay  
 100022 New Entrance Interiors / 13 to 4.5k Ft. Or

---

**Project:** 2  
**File No.:** CHX\_2006-0001000\_Jacksonville, FL\_304  
**Scale:** 1/8" = 1'-0"

**Client:** City of Jacksonville  
**Address:** 100022 New Direction for Pylon Faces  
 100022 Distant Buildings  
 100022 Front Entrance Overlay  
 100022 New Entrance Interiors / 13 to 4.5k Ft. Or

**N01 Main ID Face Replacements**

Faces & LED Retro FR Kits



Facing Plyon Conditions



**Face Replacement**

Scale: 3/8" = 1'-0"

**Checkers (Main ID): Face and Retro Kit Specifications**

Face: 1/2" Clear Polycarbonate Face per Sign  
 Graphics: 2nd Surface Digital Print  
 Retro FR Kit: white led Qty 12 - DS 84" Principle Top-Out Quid. 800c with 120hr Power Supply  
 120v primary power to sign location by other.  
 Quantity: (2) Faces / 1) Retro Kit, require

**Additional Site Notes**

Paint of cabinet, cabinet and support clear lead to accommodate ID/FR lead as required

**Paint Specifications**

- Also-labeled to match PMS 1007C  Also-labeled to match PMS Cool Gray 1 C
  - Also-labeled to match PMS White  Also-labeled to match PMS Cool Gray 4 C
  - Also-labeled to match PMS Black  Also-labeled to match PMS Cool Gray 7 C
- All paint choices to be done within cabinet collection updates



Side A - Pattern

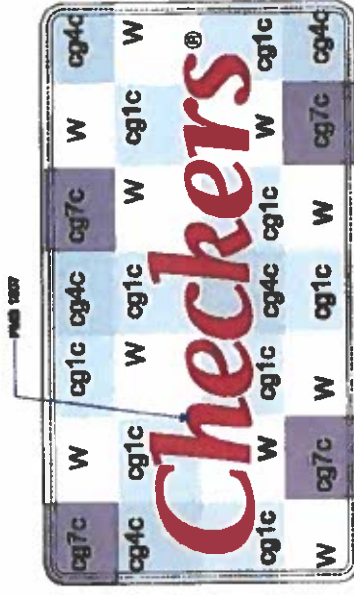

Side B - Pattern



**Allen Industries**  
 YOUR SIGNAGE AT ITS BEST!  
 1-800-967-2553  
 www.allenindustries.com

Quantity 2  
 Checkers #3288  
 Jacksonville, FL

Job # 0088722  
 File # CHK\_3288-0088722\_Jacksonville\_FL\_304  
 Buyer M.M. J.P.  
 Date T.F.D.

Lead 10/02/21  
 1 10/02/21 New Design for Plyon Faces  
 2 10/02/21 Detail Elevations  
 3 10/02/21 Final Elevations Change  
 4 10/02/21 New Elevations to match / 8 to 4 by FR Kit

Client Brandon Stegler  
 Allen Industries, Inc. requires that an approved drawing be obtained from the client prior to any production release or production release revision  
 Allen Industries, Inc. 10/02/21





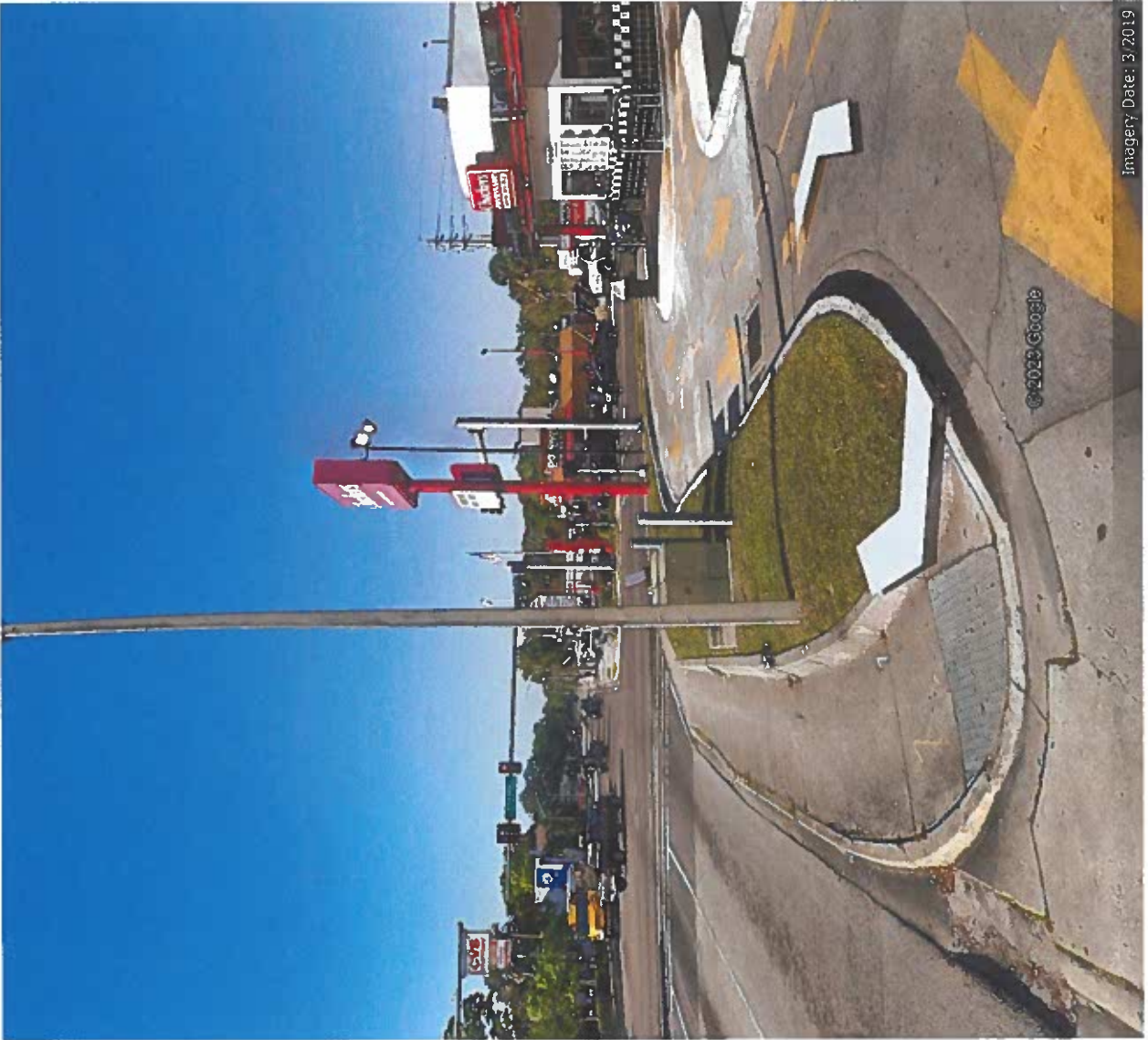

Imagery Date: 3/2019







78100 Atlantic Blvd  
Exit Street View

© 2023 Google

Google Earth









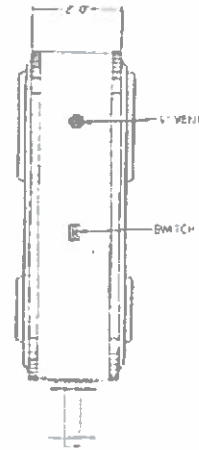

04 04175  
 SIGN PLANS EXAMIN  
 REVIEWED FOR  
 CODE COMPLIAN  
 KEEP THIS PLAN ON J  
 MAY 7 8 2004  
 City of Seattle  
 Public Works Department  
 400 West 4th Avenue  
 Seattle, WA 98101  
**CITY S**

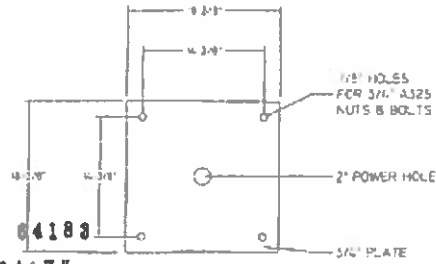

**NOTES:**  
 1. ALL 1/2\"/>
**COLORS:**  
 FACE BACKGROUND CAPSULE RED  
 FACE PLAINS PROCESS YELLOW  
 CHECKERS COPY WHITE  
 SQUARES AND STRIPES BLACK ON WHITE RECTANGLE BKG  
 CAPSULE BKG YELLOW  
 CAPSULE OUTLINE BLACK  
 BURGERS FRIES COLAS COPY BLACK  
 CABINET WHITE RED

04 04183  
 04 04175  
 04 04170  
 04 04185

**MATCH PLATE**  
 2 REQ'D FOR  
 ALL TED STUB  
 ASSEMBLY

Burn rate on faces meets ASTM D 635 rate of 1.06 mm/6

		<b>CHECKERS/RALLY'</b> SIGNAGE VARIOUS NO. 123456 DATE: 11/24/04 BY: [Signature]	
DATE: 11/24/04 BY: [Signature]	CHECKERS/RALLY' SIGNAGE VARIOUS NO. 123456 DATE: 11/24/04 BY: [Signature]	DATE: 11/24/04 BY: [Signature]	DATE: 11/24/04 BY: [Signature]



**MAP SHOWING SURVEY OF**  
**OF TRACT "C", ACCORDING TO JOHN B. UBELHOER'S SURVEY OF**  
**PLAT THEREOF, RECORDED IN PLAT BOOK 7, PAGE 10**  
**JACKSONVILLE, DUVAL COUNTY, FLORIDA**

1397  
 REEL OF LAND, SITUATE, LYING AND BEING IN THE COUNTY OF DUVAL, STATE OF FLORIDA, TO WIT:  
 JOHN B. UBELHOER'S SURVEY OF PLAT THEREOF, RECORDED IN PLAT BOOK 7, AT PAGE 10, OF THE  
 COUNTY OF DUVAL, FLORIDA, MORE PARTICULARLY DESCRIBED AS FOLLOWS:

THE SOUTHERLY RIGHT OF WAY LINE OF ATLANTIC BOULEVARD, AND THE PRESENT  
 ARLINGTON ROAD AS WIDENED, SAID POINT OF BEGINNING BEING 8 FEET EASTERLY FROM THE  
 TRACT "C"; THENCE FROM THE POINT OF BEGINNING EASTERLY ALONG THE SOUTHERLY RIGHT OF  
 WAY TO A POINT; THENCE SOUTHERLY ON A LINE PARALLEL WITH THE ORIGINAL EASTERLY RIGHT  
 OF WAY TO A POINT; THENCE WESTERLY ALONG A LINE PARALLEL WITH A SOUTHERLY RIGHT OF WAY  
 OF ARLINGTON ROAD, 15 FEET TO A POINT LOCATED SOUTHERLY 20 FEET ALONG THE ORIGINAL  
 RIGHT OF WAY LINE OF ARLINGTON ROAD AS WIDENED 20 FEET MORE OR LESS TO THE POINT OF BEGINNING.

APPROVED FOR ROAD WIDENING UNDER THE ORDER OF TAKING BY THE STATE ROAD DEPARTMENT OF  
 ROAD 3648, PAGE 1036, PUBLIC RECORDS OF SAID COUNTY.

16-1040

POINT AT THE INTERSECTION OF THE EAST RIGHT OF WAY LINE OF ARLINGTON ROAD AND THE  
 BOULEVARD, THENCE EASTERLY ALONG ATLANTIC BOULEVARD 8 FEET, THENCE SOUTHWESTERLY  
 SOUTH OF THE POINT OF BEGINNING, THENCE NORTHERLY ALONG ARLINGTON ROAD 20 FEET TO  
 THE EAST RIGHT OF WAY.

TO SHOW THE HORIZONTAL LOCATION OF VISIBLE IMPROVEMENTS.

AS SHOWN HEREON ARE APPROXIMATE. ALL DISTANCES SHOWN  
 HEREON ARE CALCULATED.

TO SHOW THE LEGAL DESCRIPTION AND THE BOUNDARY DIMENSIONS

666,1213 (b) (1) An area within the dripline of  
 the tree or trees at least one foot in diameter for  
 each inch of trunk diameter shall be preserved in  
 its natural state or covered with previous land-

SIGN PLANS EXAMINED  
 REVIEWED FOR  
 CODE COMPLIANCE  
 KEEP THIS PLAN ON JOB

NOV 23 2004

DRIVING Inspection Div. - Jax., FL  
 PLAN REVIEW AND ISSUING OF PERMITS  
 DOES NOT RELIEVE CONTRACTOR OF  
 COMPLYING WITH ALL CODES

CITY Seal

04 64183 04 64178  
 04 64185  
 04 64175

ARLINGTON ROAD

POINT OF BEGINNING

*133244  
 P/10/20/94  
 w/ 26' x 20' x 10'  
 GET BACK*

*\*No trees in sign  
 area  
 check  
 along*

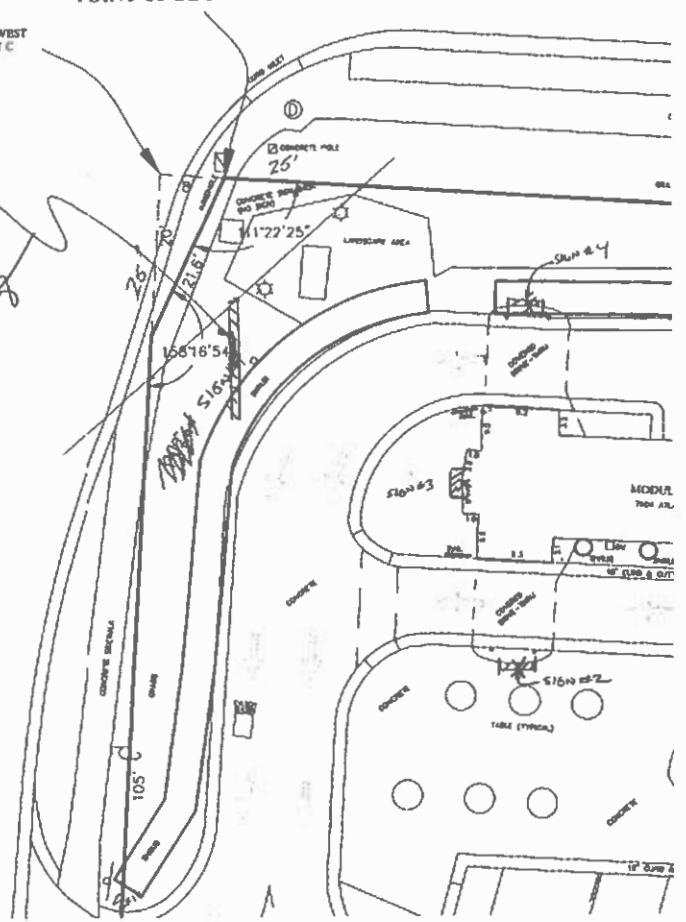

The 1996 permit was for the removal of an off-site sign which were deemed illegal. In the 70's and 80's companies would put small towable, also illuminated, off-site signs on commercial properties. The signs proliferated until the May of 1987 when the referendum was approved by the voters. Billboard companies sued and ultimately agreed to individual settlement agreements.

<https://www.scenicflorida.org/jacksonville-referendum/>

Type	Bill #	Title	Date Introduced	Status	Committee
O	1993-2048	93-2048-1163 AUTH EXECUTION OF SETTLEMENT AGREEMENT WITH NATL ADVERTISING CO & 3 M CO; WAIVING ENFORCEMENT OF VAR SIGN REGULATIONS. (REQ OF GEN COUNSEL) PH 11/23 93- HELD 1, 11-9: F, CED 2, 11-23: F READ 2ND & REREFER 5-0; CED READ 2ND & REREFER 6-0; F, CED 3, 12-14: F ENACT 7-0; CED ENACT 6-0 12/14/93		MinPro Conv	

Best Regards,