

**PARCEL MAP SHOWING**  
**APPROXIMATE AREA OF RIGHT-OF-WAY TAKING**

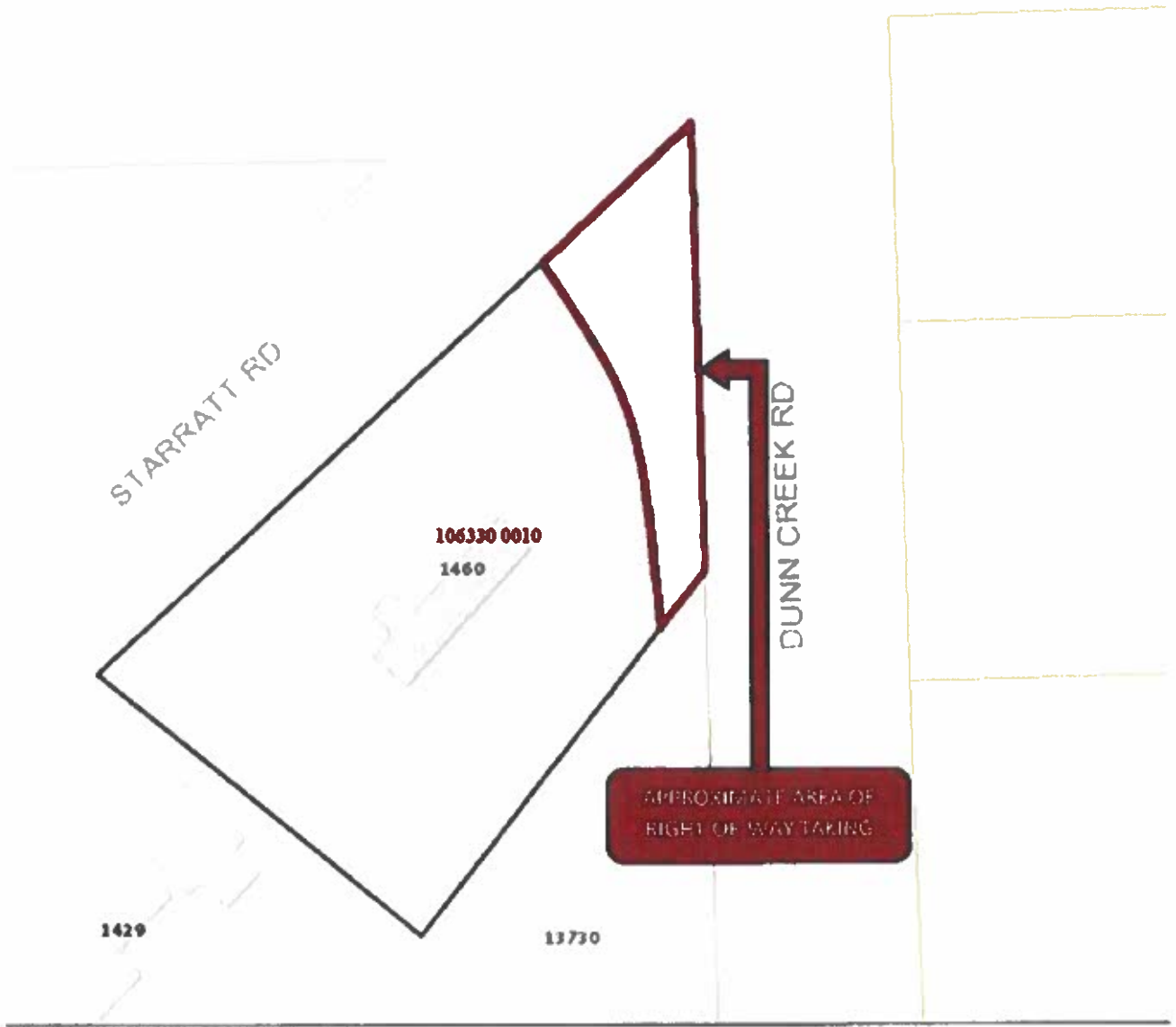

**PARCEL AERIAL SHOWING**  
**APPROXIMATE AREA OF RIGHT-OF-WAY TAKING**



### MAP SHOWING BOUNDARY SURVEY OF

A PORTION OF THE SOUTHEAST 1/4 OF THE SOUTHWEST 1/4 OF SECTION 22, TOWNSHIP 1 NORTH, RANGE 27 EAST, DUVAL COUNTY, FLORIDA, ALSO BEING A PORTION OF THOSE LANDS AS DESCRIBED IN OFFICIAL RECORDS BOOK 10067, PAGE 342, OF THE PUBLIC RECORDS OF SAID COUNTY, BEING MORE PARTICULARLY DESCRIBED AS FOLLOWS:

FOR A POINT OF BEGINNING, COMMENCE AT THE INTERSECTION OF THE SOUTHEASTERLY RIGHT OF WAY LINE OF STARRATT ROAD (A 80 FOOT RIGHT OF WAY), WITH THE WESTERLY RIGHT OF WAY LINE OF DUNN CREEK ROAD (A 86 FOOT RIGHT OF WAY); THENCE SOUTH 01°34'20" EAST, ALONG SAID WESTERLY RIGHT OF WAY LINE, A DISTANCE OF 150.00 FEET TO THE SOUTHEAST CORNER OF SAID OFFICIAL RECORDS BOOK 10067, PAGE 342; THENCE SOUTH 39°19'01" WEST, ALONG THE SOUTHERLY LINE OF LAST SAID LANDS, A DISTANCE OF 8.93 FEET TO A POINT ON A CURVE HAVING A RADIUS OF 217.00 FEET; THENCE NORTHWESTERLY, DEPARTING SAID SOUTHERLY LINE, ALONG THE ARC OF A CURVE CONCAVE SOUTHWESTERLY AN ARC DISTANCE OF 104.59 FEET, SAID ARC BEING SUBTENDED BY A CHORD BEARING AND DISTANCE OF NORTH 29°42'40" WEST, 103.58 FEET TO THE POINT OF TANGENCY OF SAID CURVE; THENCE NORTH 42°31'06" WEST, A DISTANCE OF 13.98 FEET TO A POINT ON SAID SOUTHEASTERLY RIGHT OF WAY LINE OF STARRATT ROAD; THENCE NORTH 47°28'54" EAST, ALONG LAST SAID LINE, A DISTANCE OF 82.43 FEET TO THE POINT OF BEGINNING.

THE ABOVE DESCRIBED LANDS CONTAINS 4,553 SQUARE FEET OR 0.10 ACRES, MORE OR LESS.

CERTIFIED TO: CITY OF JACKSONVILLE; JEFFERY RICKERT AND KAREN RICKERT; FIDELITY NATIONAL TITLE INSURANCE COMPANY

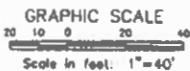

**ABBREVIATIONS USED**

- (ACT) = ACTUAL
- CONC. = CONCRETE
- ESMT = EASEMENT
- FND. = FOUND
- I.P. = IRON PIPE
- I.R. = IRON ROD
- OHL = OVERHEAD LINE(S)
- LB = LICENSED BUSINESS

**CURVE C-1**  
 CB=N 26°42'40" W  
 CD=103.58'  
 R=217.00'  
 A=104.59°  
 Δ=27°38'53"

**GENERAL NOTES:**

1. BEARINGS SHOWN HEREON BASED ON OFFICIAL RECORDS 10067, PAGE 342 AND REFERENCED TO THE WESTERLY RIGHT OF WAY LINE OF DUNN CREEK ROAD AS NORTH 01°34'20" WEST.
2. THIS SKETCH WAS MADE WITH THE BENEFIT OF TITLE SEARCH REPORT PREPARED BY FIDELITY NATIONAL TITLE INSURANCE COMPANY, ORDER NUMBER 10692734, ENDING DECEMBER 15, 2022 AT 12:30 AM.  
 SCHEDULE B - SECTION 2  
 THERE ARE NO ITEMS THAT EFFECT SUBJECT PROPERTY.
3. THE LOT SHOWN HEREON IS IN FLOOD ZONE "X" AS SHOWN ON FLOOD INSURANCE RATE MAP 12031C0202J FOR DUVAL COUNTY, FLORIDA, DATED 11/2/2018.

**REVISIONS**

**CERTIFICATION**

THIS IS TO CERTIFY THAT THIS SURVEY WAS MADE UNDER THE UNDERSIGNED'S RESPONSIBLE DIRECTION AND SUPERVISION, THAT THE SKETCH DATA MEETS OR EXCEEDS STANDARDS OF PRACTICE FOR SURVEYING IN THE STATE OF FLORIDA SET FORTH BY: CHAPTER NO. 5J-17 (.050-.052) OF THE FLORIDA ADMINISTRATIVE CODE (FAC) FOR LAND SURVEYORS IN THE STATE OF FLORIDA.

*Danny S. Wheeler* 12-27-22  
 DANNY S. WHEELER DATE  
 PROFESSIONAL LAND SURVEYOR  
 FLORIDA REGISTRATION NUMBER 8902

UNLESS IT BEARS THE SIGNATURE AND THE ORIGINAL (PAPER) SEAL OF A FLORIDA LICENSED SURVEYOR AND MAPPER THIS MAP/REPORT IS FOR INFORMATIONAL PURPOSES ONLY AND IS NOT VALID.

PROJECT PATH: G:\SHARD\Topo Field\field FY2023\1480 Starratt Road\

SURVEY DATA:	
DATA DISK.	DATE 12/18/2022
SURVEY BOOK S-847:156	SCALE 1"=40'
DRAWN BY SOC	PROJECT NO.
LAST DATE IN FIELD	



**CITY OF JACKSONVILLE**  
 DEPARTMENT OF PUBLIC WORKS  
 214 N. HOGAN STREET, ENGINEERING DIVISION 10th FLOOR,  
 JACKSONVILLE, FL 32202 (904)255-8756

SHEET NO.	1
OF	1
DRAWING NO.	
DRAWING FILE	