

GENERAL	
City Development Number	10116.000
Concomitancy Application Number	100661.1
Property Appraiser Number (RE #)	153805-0000.163804-0000
Zoning Designation	CRO
PUD Ordinance Number	N/A
FIRM Community - Panel	12031CO392H
Flood Zones (Show in Plans)	X
Base Flood Elev. (Show in Plans)	N/A
Vertical Datum Used for Project	1988
JEI Availability Number	2020-5925
SUBDIVISION	
PSD Number	N/A
City or Private Inspection	PRIVATE
Public or Private Roads	N/A
Subdivision ("911") Disk Provided?	N/A
NON-SUBDIVISION	
North American Industry Classification System (NAICS)	238170
ImperVIOUS Area (Sq. Ft.)	70,529

Exhibit 4

Page 1 of 1

ARCHITECTURE - IN

JAA ARCHITECTURE INC
2716 ST. JOHNS AVE
JACKSONVILLE, FL 32205
P: 904.379.5108
E: JOHNS@JAAARCHITECTURE.COM
LIC. AR27248

THIS DOCUMENT, ALONG WITH ASSOCIATED DOCUMENTS, IS AN INSTRUMENT OF SERVICE. IT IS THE PROPERTY OF JAA ARCHITECTURE INC. AND IS TO BE USED ONLY FOR THE PROJECT AND SITE SPECIFICALLY IDENTIFIED HEREIN. NO PART OF THIS DOCUMENT IS TO BE REPRODUCED, COPIED, OR TRANSMITTED IN ANY FORM OR BY ANY MEANS, WITHOUT THE WRITTEN PERMISSION OF THE ARCHITECT. THE ARCHITECT'S KNOWLEDGE, THE PLANS AND SPECIFICATIONS CONTAINED HEREIN, AND THE INFORMATION PROVIDED AS DETERMINED BY THE LOCAL AGENCIES IN ACCORDANCE WITH THE PROJECT'S REGULATORY REQUIREMENTS, SHALL BE THE BASIS OF THE ARCHITECT'S KNOWLEDGE. THE SPACE HAS BEEN DESIGNED TO ACCOMMODATE THE INFORMATION PROVIDED HEREIN. THE ARCHITECT DOES NOT WARRANT THE ACCURACY OF THE INFORMATION PROVIDED HEREIN. THE ARCHITECT'S LIABILITY IS LIMITED TO THE DESIGN AND CONSTRUCTION OF THE PROJECT. THE ARCHITECT IS NOT RESPONSIBLE FOR THE DESIGN OR CONSTRUCTION OF ANY OTHER WORK OR FOR THE PERFORMANCE OF ANY OTHER WORK. THE ARCHITECT'S LIABILITY IS LIMITED TO THE DESIGN AND CONSTRUCTION OF THE PROJECT. THE ARCHITECT IS NOT RESPONSIBLE FOR THE DESIGN OR CONSTRUCTION OF ANY OTHER WORK OR FOR THE PERFORMANCE OF ANY OTHER WORK.

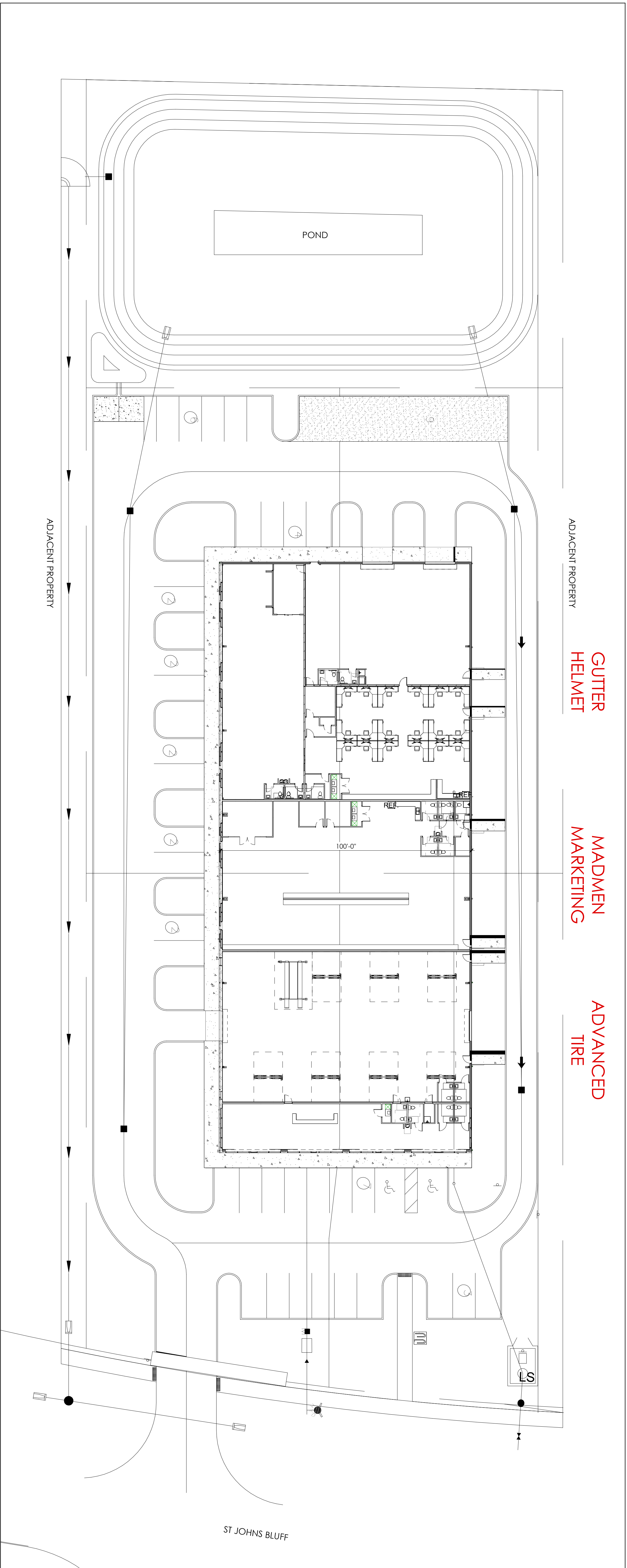

NEW CONSTRUCTION
GUTTER HELMET
2190 ST JOHNS BLUFF RD S, #300
JACKSONVILLE, FL 32246
February 16, 2022

#	DATE	DESCRIPTION

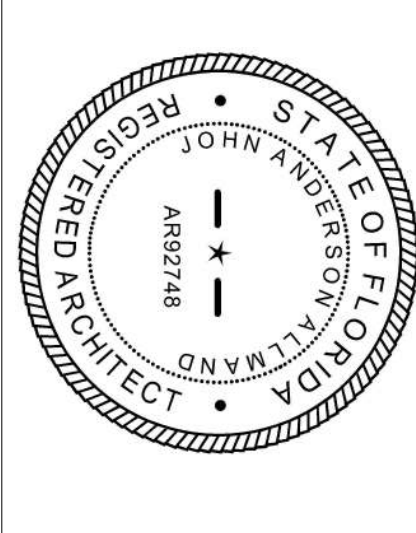

DATE: 2.16.2022
SHEET: ARCH. SITE PLAN

A001