

1. DEVELOPER:
RBF PROPERTIES, LLC
3400 KORI RD
JACKSONVILLE, FLORIDA 32257
PHONE: 904-859-6411

2. ENGINEER:
DOMINION ENGINEERING GROUP
4348 SOUTHPOINT BLVD, SUITE 201
JACKSONVILLE, FLORIDA 32216
PHONE: 904-854-4500

3. SUPERVISOR:
ETM SURVEYING & MAPPING, INC.
14775 OLD SAINT AUGUSTINE ROAD
JACKSONVILLE, FLORIDA 32258
PHONE: 904-642-8990

4. EXISTING VEGETATION:
WOODED

5. ZONING/P.U.D. NIS

6. TOTAL SITE AREA SUMMARY:
TOTAL SITE AREA = 23.59 AC.± (100%)
SINGLE FAMILY AREA = 19.27 AC.± (82%)
ACTIVE REC./OPEN SPACE = 0.00 AC.± (0.00%)
PASSIVE OPEN SPACE, WETLANDS, PONDS = 3.36 AC.± (14%)
PUBLIC & PRIVATE R/W = 5.86 AC.± (25%)
MAXIMUM COVERAGE OF BUILDINGS = 15.33 AC.± (65%)
TOTAL NUMBER OF LOTS = 60

TYPICAL LOT SIZES: 50'X120', 60'X120' & 90'X130'

MIN. LOT AREA: 6,000 sf

BUILDING SET BACK INFORMATION:
FRONT = 15' TO FACE OF BUILDING AND
20' TO FACE OF GARAGE
SIDE = 5'
REAR = 10'

MAXIMUM LOT COVERAGE: 65%
MAXIMUM HEIGHT OF BUILDING: 35'

7. TOTAL OF ANTICIPATED PHASES: 1

8. WATER SUPPLY: JACKSONVILLE ELECTRIC AUTHORITY

9. SEWER SUPPLY: JACKSONVILLE ELECTRIC AUTHORITY

10. ELECTRICAL SUPPLY: JACKSONVILLE ELECTRIC AUTHORITY

11. FIRE PROTECTION: 6" FIRE HYDRANTS SERVED BY WATER MAIN EXTENSION

12. FLOOD ZONE: ZONE X (PANEL NO. 12031 - 00561H)

13. CITY DEV. NO. XXXX

14. REAL ESTATE NO.s: 156120-0000, 156326-0000, 156327-0000, 158109-0000

NOTE: THIS IS A CONCEPTUAL SITE PLAN, LOT LINES, SIZES, ROADWAY LAYOUTS, RIGHT OF WAY, AND STORM WATER PONDS MAY BE ACQUIRED FOR ENGINEERING, GEOMETRY, AND ANY GOVERNMENTAL AGENCY REQUIREMENTS AND AS SITE PLANNING REQUIRES.

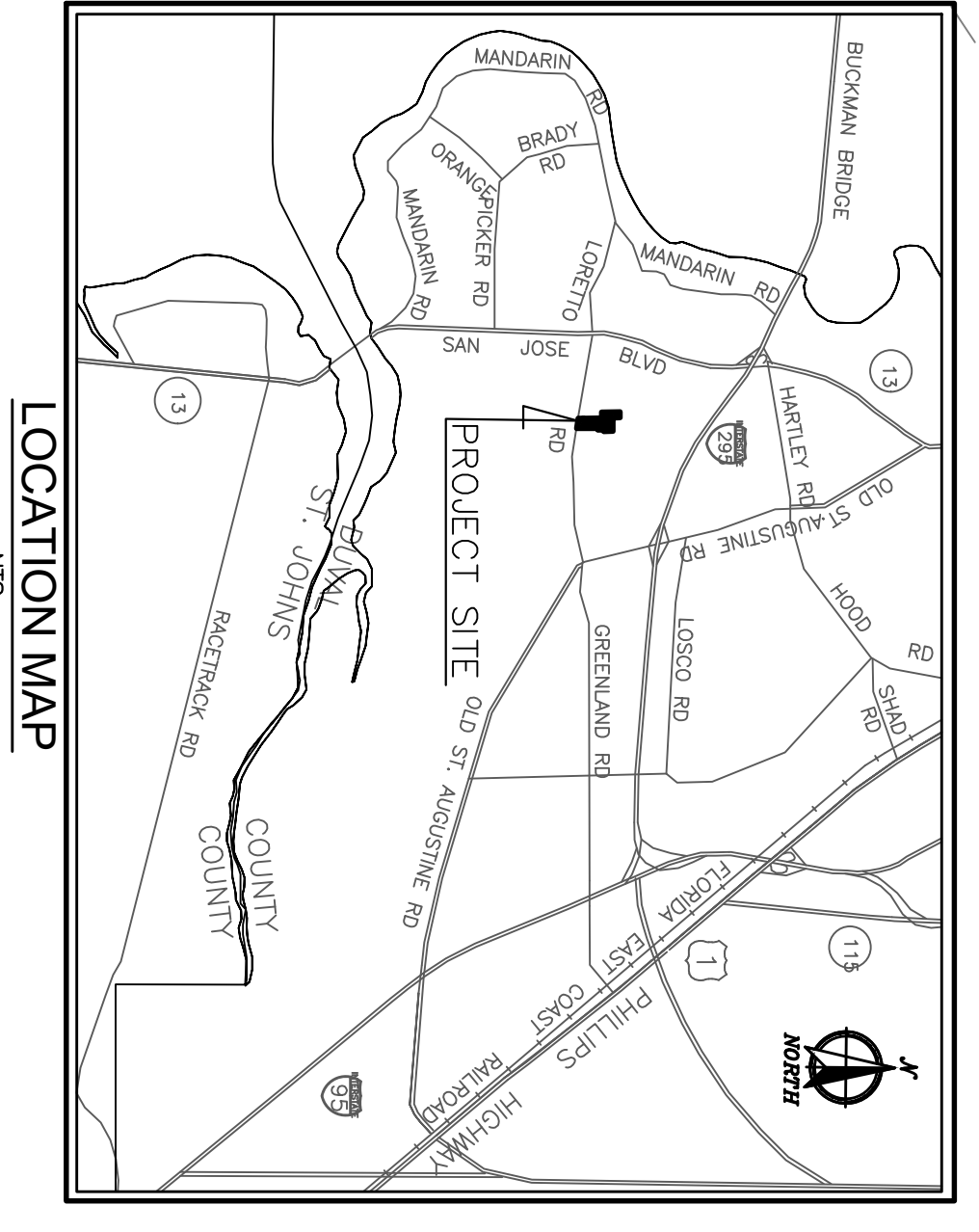
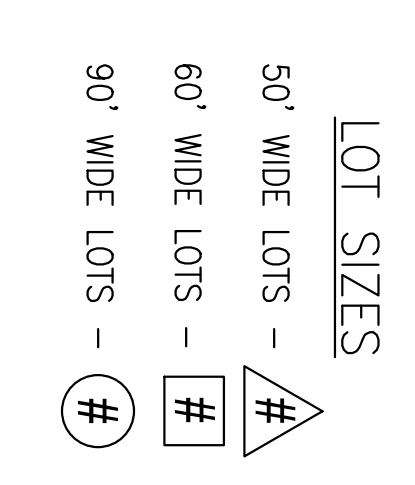

<p>LORETTO LANDING FOR SOUTHBELT PARK, LTD</p> <p>MASTER DEVELOPMENT PLAN</p>	<p>DOMINION ENGINEERING GROUP, INC. PLANNERS AND ENGINEERS 4348 SOUTHPOINT BLVD, SUITE 201, JACKSONVILLE, FLORIDA 32216 TEL: 904-854-4500 C.A. NUMBER: 26821 FAX 904-854-4505 www.dom-eng.com</p>												
<p>REVISIONS</p> <table border="1"> <tr><th>NO.</th><th>DATE</th><th>DESCRIPTION</th></tr> <tr><td> </td><td> </td><td> </td></tr> <tr><td> </td><td> </td><td> </td></tr> <tr><td> </td><td> </td><td> </td></tr> </table>	NO.	DATE	DESCRIPTION										<p>PROJECT NO. MDP1</p> <p>DATE: 07/29/2022</p> <p>SCALE: AS NOTED</p> <p>CHECKED BY: MAB/JMM</p> <p>DRAWN BY: MAM</p> <p>DESIGNED BY: MAB/JMM</p> <p>DATE: 07/29/2022</p> <p>PROF. ENGINEER WILLIAM E. SCHAEFER, III No. 40229 STATE OF FLORIDA EXHIBIT E</p>
NO.	DATE	DESCRIPTION											