

GEORGE ROAD



DATA SUMMARY

ZONING:	RMD-C/RMD-D
AREA:	4.49 AC
UNITS:	50
DENSITY:	17.8 UNITS/AC

GEORGE ROAD APARTMENTS

GEORGE ROAD,  
JACKSONVILLE, FL



ENGINEERING | CONSULTING | PLANNING

1275 UNIVERSITY BLVD., SUITE 200, JACKSONVILLE, FL 32211

CONCEPT PLAN

JOB NO. | 011198 | DATE | 7-30-20





**DATA SUMMARY**

ZONING	RMD-C/RMD-D
AREA	4.49 AC.
UNITS	48
DENSITY	10.7 UNITS/AC

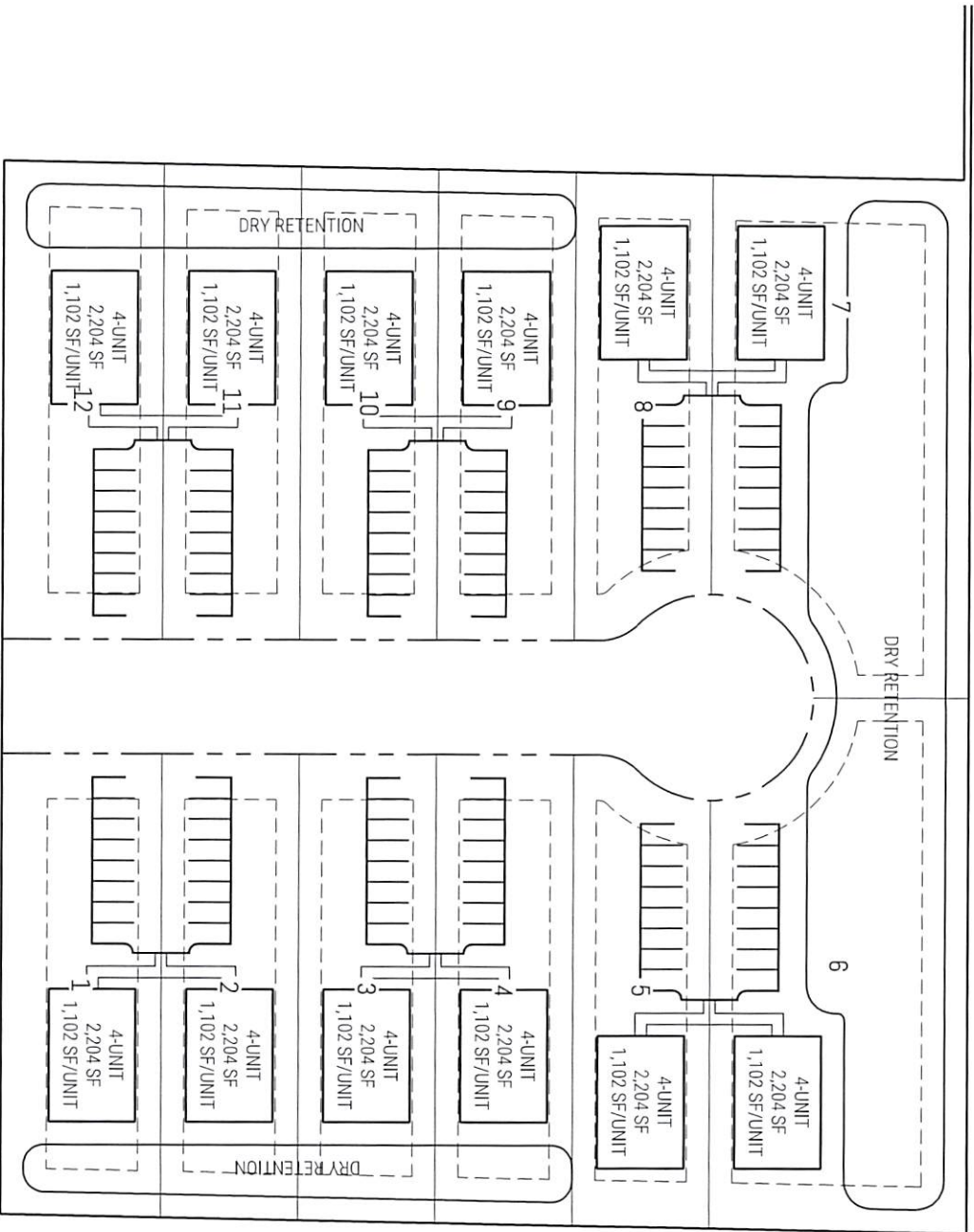

**GEORGE CT. VILLAS**

GEORGE ROAD,  
JACKSONVILLE, FL



**JMD**  
ENGINEERING | CONSULTING | PLANNING

1777 BRUNNEN DRIVE, JACKSONVILLE, FL 32218-1000  
TEL: 904.766.1100 FAX: 904.766.1101

**CONCEPT PLAN**

303150 | 01198 Date: 8-18-20



(12) 40x60 UNITS

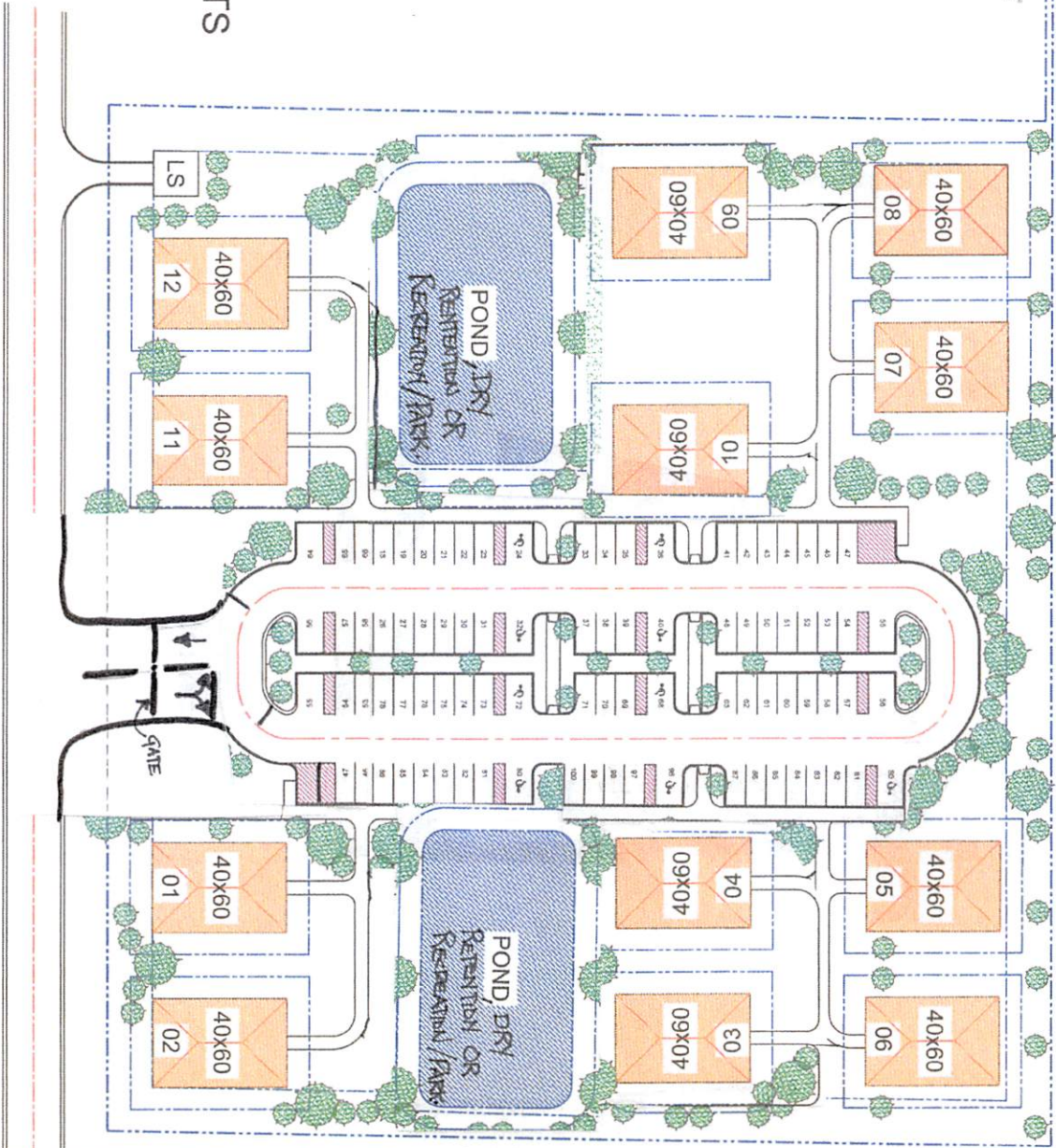

©COPYRIGHT Southern Impression Development, LLC 2019

PROJECT NO.	2019-010
DATE	09/01/2020
DESIGNED BY	NSJ
CHECKED BY	NSJ
SCALE	AS SHOWN
DRAWN BY	STW
APPROVED BY	

GEORGE ROAD QUADS

SEPTEMBER 1, 2020



**NOTICE**  
 This plan is prepared by Southern Impression Development, LLC. It is intended for the use of the client and is not to be used for any other purpose without the written consent of Southern Impression Development, LLC. The client is responsible for obtaining all necessary permits and approvals from the appropriate authorities. Southern Impression Development, LLC is not responsible for any errors or omissions in this plan.