

RE#
CM Donation Program

QUITCLAIM DEED
DONATION

THIS INDENTURE, made this _____ day of _____, 2023, by and between the **CITY OF JACKSONVILLE**, a municipal corporation under the laws of the State of Florida, ("Grantor"), and **HISTORIC EASTSIDE COMMUNITY DEVELOPMENT CORPORATION**, a Florida not for profit corporation (hereinafter referred to as "Grantee"), whose address is **820 A. PHILIP RANDOLPH BOULEVARD, JACKSONVILLE, FL 32206**.

WITNESSETH:

THAT Grantor, for and in consideration of the sum of (0.00), and other good and valuable consideration in hand paid by the Grantee, the receipt of which is hereby acknowledged, does hereby release, remise and quitclaim unto Grantee, its successors and assigns forever, all of Grantor's right, title, and interest in and to the following described lands, situate, lying and being in the County of Duval, State of Florida, to wit:

See Exhibit "A", attached hereto and incorporated herein by this reference.
(without benefit of a survey or title examination)

This deed shall release any rights of entry the City may have to subsurface minerals.

Subject to the requirement that the property be developed as permanent affordable housing within 2 years after this donation as evidenced by receipt of a certificate of occupancy. "Affordable housing" is that housing affordable by a person or family whose then-current family income does not exceed 140% of the then-current area median gross income for the City of Jacksonville, Duval County, Florida Standard Metropolitan Statistical Area as determined by the Secretary of the United States Department of the Treasury, to be verified by the Housing and Community Development Division at each conveyance of the property. Failure to comply with the restrictions will cause the property to revert to the City Of Jacksonville by Special Warranty Deed at no cost to the City Of Jacksonville. These restrictions touch and concern the land and run with the title to the property.

SUBJECT to any easements, reservations, leases, conditions, licenses, and restrictions, known or unknown or whether or not of record. This conveyance is specifically and expressly without any warranties, representations or guarantees either express or implied, of any kind, nature, or type whatsoever, from or on behalf of the Grantor, including but not limited to warranties of title, suitability or merchantability.

TO HAVE AND TO HOLD the same together with all and singular the appurtenances thereunto belonging or in anywise appertaining, and all the estate, right, title, interest, lien, equity and claim whatsoever of Grantor, either in law or equity, to the only proper use, benefit and behoof of Grantee, its successors and assigns forever.

IN WITNESS WHEREOF, Grantor has caused this instrument to be executed by its duly authorized officers on the day and year first above written, pursuant to Section 122.423, Jacksonville Ordinance Code.

Signed, sealed and delivered in our presence as witnesses:

CITY OF JACKSONVILLE, a Florida municipal corporation

Print Name: _____

By: _____
Lenny Curry as Mayor

Print Name: _____

Attest: _____
John R. McCain as Corporation Secretary

STATE OF FLORIDA
COUNTY OF DUVAL

The foregoing instrument was acknowledged before me this _____ day of _____, 2023, by _____, for and on behalf of Mayor Lenny Curry, as aforesaid, and James R. McCain, Jr., as Corporation Secretary, on behalf of the City of Jacksonville, who are personally known to me.

Notary Public, State of Florida
Print Name: _____
Commission No. _____
My Commission Expires: _____

Form Approved:

Exhibit A



* The City of Jacksonville provides no warranties, expressed or implied, concerning the accuracy, completeness, or reliability of suitability of this location map for any particular use.

RE# 115302 0000 South One-Half (S ½) of Lot Twenty-Six (26), Replat of J.H. Pace's Subdivision of West ½ Lots 21 to 29 Inclusive & Part of Lot 30 of East Greeleyville, according to Plat recorded in Plat Book 4, Page 18, of the Public Records of Duval County, Florida.

APPROVED
 DESCRIPTION AGREES
 WITH MAP
 CITY ENGINEERS OFFICE
 TOPO/SURVEY BRANCH
 BY SCC 1/26/23

Exhibit A

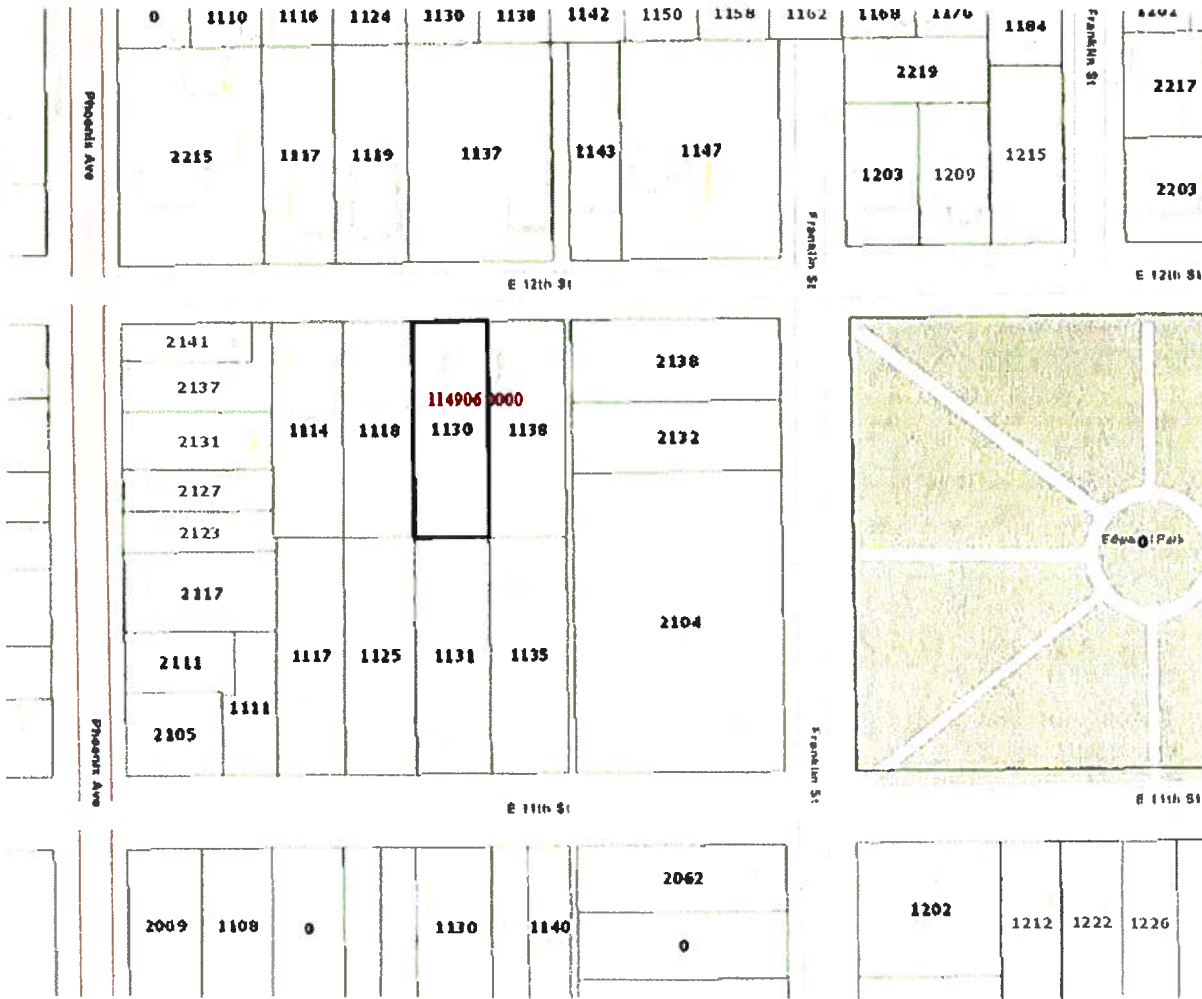

* The City of Jacksonville provides no warranties, expressed or implied, concerning the accuracy, completeness, or reliability of suitability of this location map for any particular use.

RE# 114906 0000 Lot 2, Block E, Corwin's Addition to Campbell's Additional to Jacksonville, according to the map or plat thereof, as recorded in Plat Book 1, Page(s) 117, of the Public Records of Duval County, Florida.

APPROVED
DESCRIPTION AGREES
WITH MAP
CITY ENGINEERS OFFICE
TOPO/SURVEY BRANCH
 By SCC Date 1/26/23

Exhibit A



* The City of Jacksonville provides no warranties, expressed or implied, concerning the accuracy, completeness, or reliability of suitability of this location map for any particular use.

RE# 114832 0020 The East 22 feet of the West 42 feet of Lot 1, Block 27, Campbell's Addition to Jacksonville, according to the plat thereof as recorded in Plat Book 2, Page 21, of the current Public Records of Duval County, Florida.

APPROVED
DESCRIPTION AGREES
WITH MAP
CITY ENGINEERS OFFICE
TOPO/SURVEY BRANCH
BY SCC DATE 1/26/23

Exhibit A



* The City of Jacksonville provides no warranties, expressed or implied, concerning the accuracy, completeness, or reliability of suitability of this location map for any particular use.

RE# 114619 0010 Lot 23, Block 17, Campbell's Addition to Jax, according to the plat thereof, as recorded in Plat Book 2, Page 21, of the Public Records of Duval County, Florida.

APPROVED
 DESCRIPTION AGREES
 WITH MAP
 CITY ENGINEERS OFFICE
 TOPO/SURVEY BRANCH
 Ey SCC Date 1/26/23

Exhibit A

	1469	822	1478		0
	1463				1465
	1457				146
	1453				145
	1449				145
	1445	114614 0000 1442			14
	1441				14
	1439				14
	1437				14

* The City of Jacksonville provides no warranties, expressed or implied, concerning the accuracy, completeness, or reliability of suitability of this location map for any particular use.

RE# 114614 0000 Lot 18, Block 17, Campbell's Addition to Jacksonville, according to plat thereof, as recorded in Plat Book 2, Page 21, of the Public Records of Duval County, Florida.

APPROVED
 DESCRIPTION AGREES
 WITH MAP
 CITY ENGINEERS OFFICE
 TOPO/SURVEY BRANCH
 By SCC 1/26/03

Exhibit A

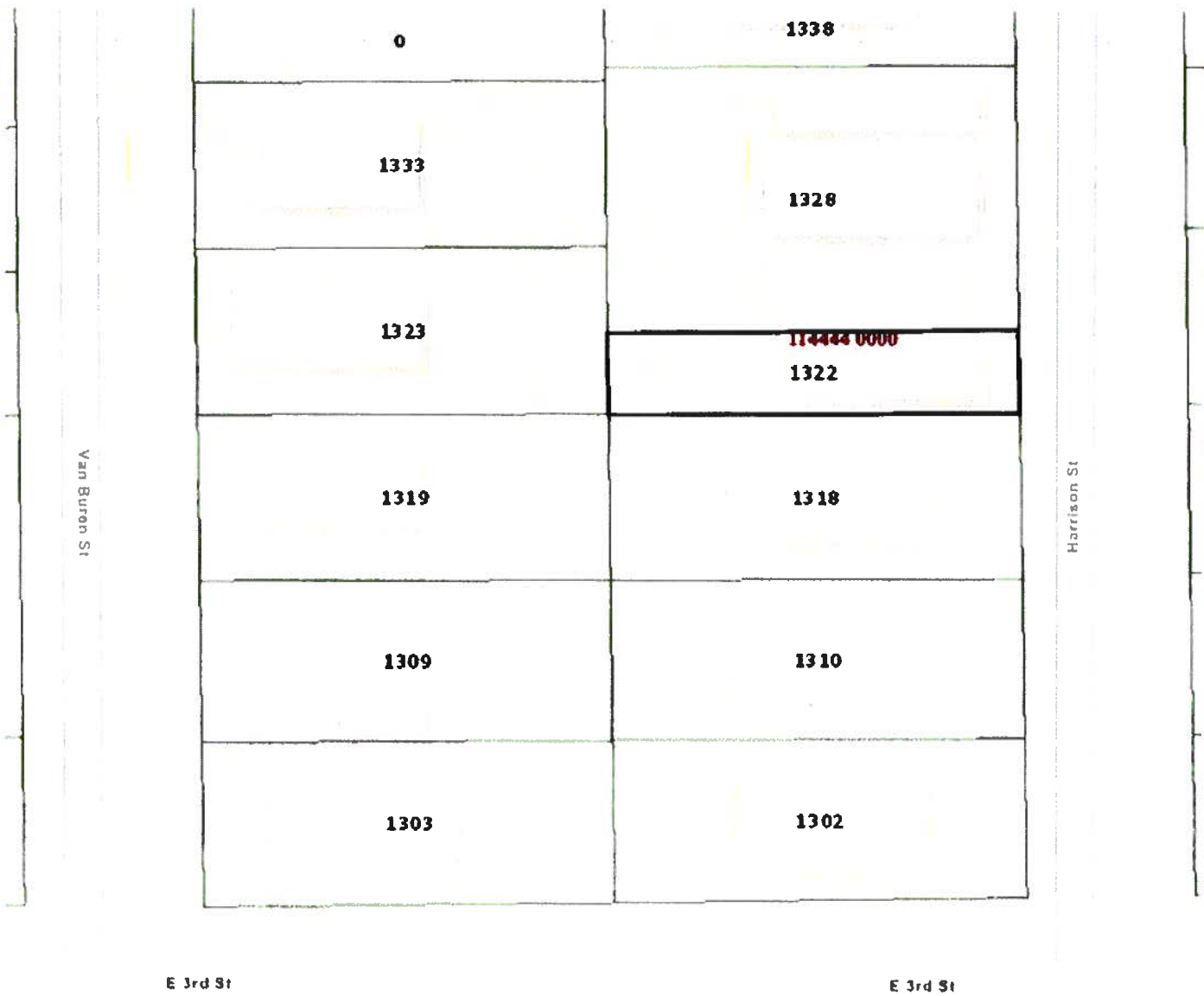

* The City of Jacksonville provides no warranties, expressed or implied, concerning the accuracy, completeness, or reliability of suitability of this location map for any particular use.

RE# 114444 0000 South One-Half (S ½) of Lot 21, Block 10, Campbell's Addition to Jacksonville, according to the plat thereof, as recorded in Plat Book 2, Page 21, of the Public Records of Duval County, Florida.

APPROVED
DESCRIPTION AGREES
WITH MAP
CITY ENGINEERS OFFICE
TOPO/SURVEY BRANCH
By SCC Date 1/26/23

Exhibit A

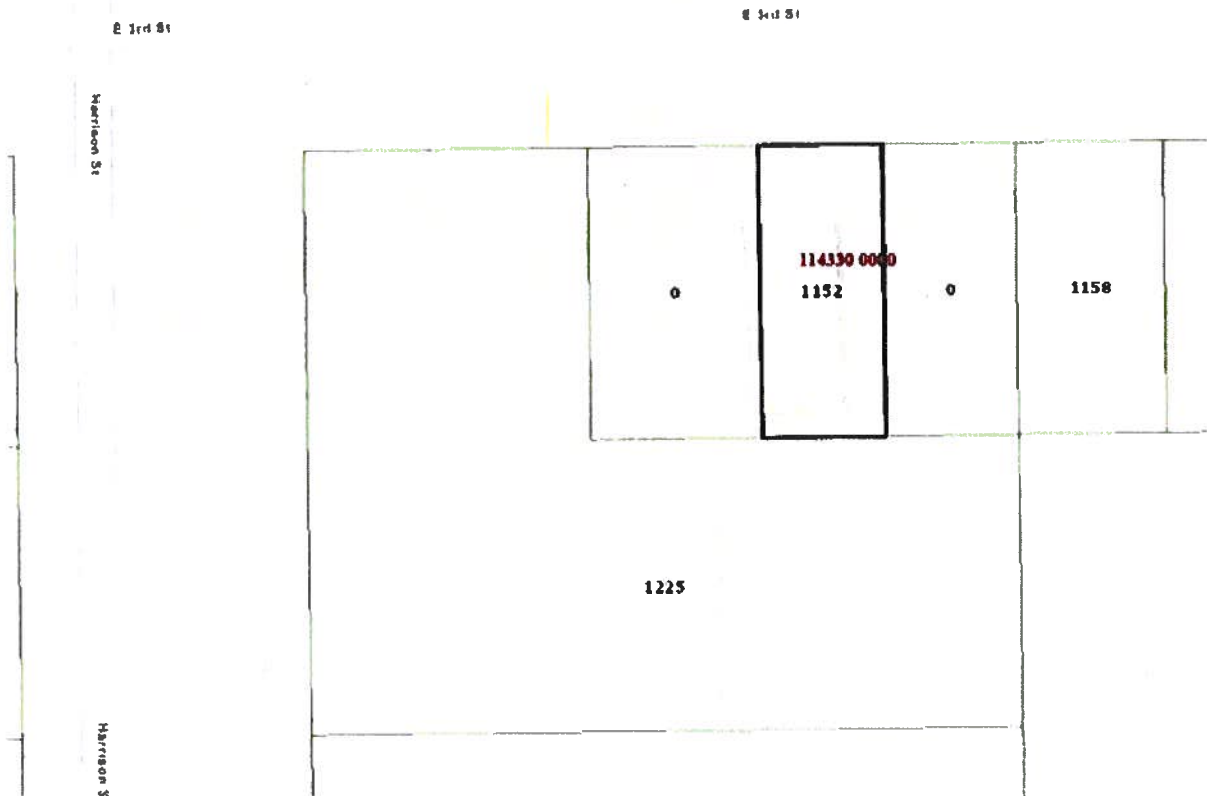

* The City of Jacksonville provides no warranties, expressed or implied, concerning the accuracy, completeness, or reliability of suitability of this location map for any particular use.

RE# 114330 0000 The East 21.5 feet of the West 101.5 feet of Lot 13, Block 6, Plat of A.B. Campbell's Addition to Jacksonville, according to the plat thereof as recorded in Plat Book 2, Page 21, of the Public Records of Duval County, Florida.

APPROVED
DESCRIPTION AGREES
WITH MAP
CITY ENGINEERS OFFICE
TOPO/SURVEY BRANCH
By SCC Date 1/26/23

Exhibit A



* The City of Jacksonville provides no warranties, expressed or implied, concerning the accuracy, completeness, or reliability of suitability of this location map for any particular use.

RE# 114081-0000 The West 25 feet of the East 50 feet of Lots 11 and 12, Block I, Dyal-Upchurch Subdivision, according to the plat thereof, as recorded in Plat Book 2, Page 36, of the Public Records of Duval County, Florida.

APPROVED
 DESCRIPTION AGREES
 WITH MAP
 CITY ENGINEERS OFFICE
 TOPO/SURVEY BRANCH
 By scc 1/26/23

Exhibit A



* The City of Jacksonville provides no warranties, expressed or implied, concerning the accuracy, completeness, or reliability of suitability of this location map for any particular use.

RE# 113702 0000 Lot 5, Block 3, Clarkson's Addition to East Springfield, according to plat thereof recorded in Plat Book 1, Page 119, of the former public records of Duval County, Florida; also as recorded in Plat Book 2, Page 8, of the current public records of Duval County, Florida.

APPROVED
 DESCRIPTION AGREES
 WITH MAP
 CITY ENGINEERS OFFICE
 TOPO/SURVEY BRANCH

By SCC ate 1/25/13