

PROJECT LOCATION

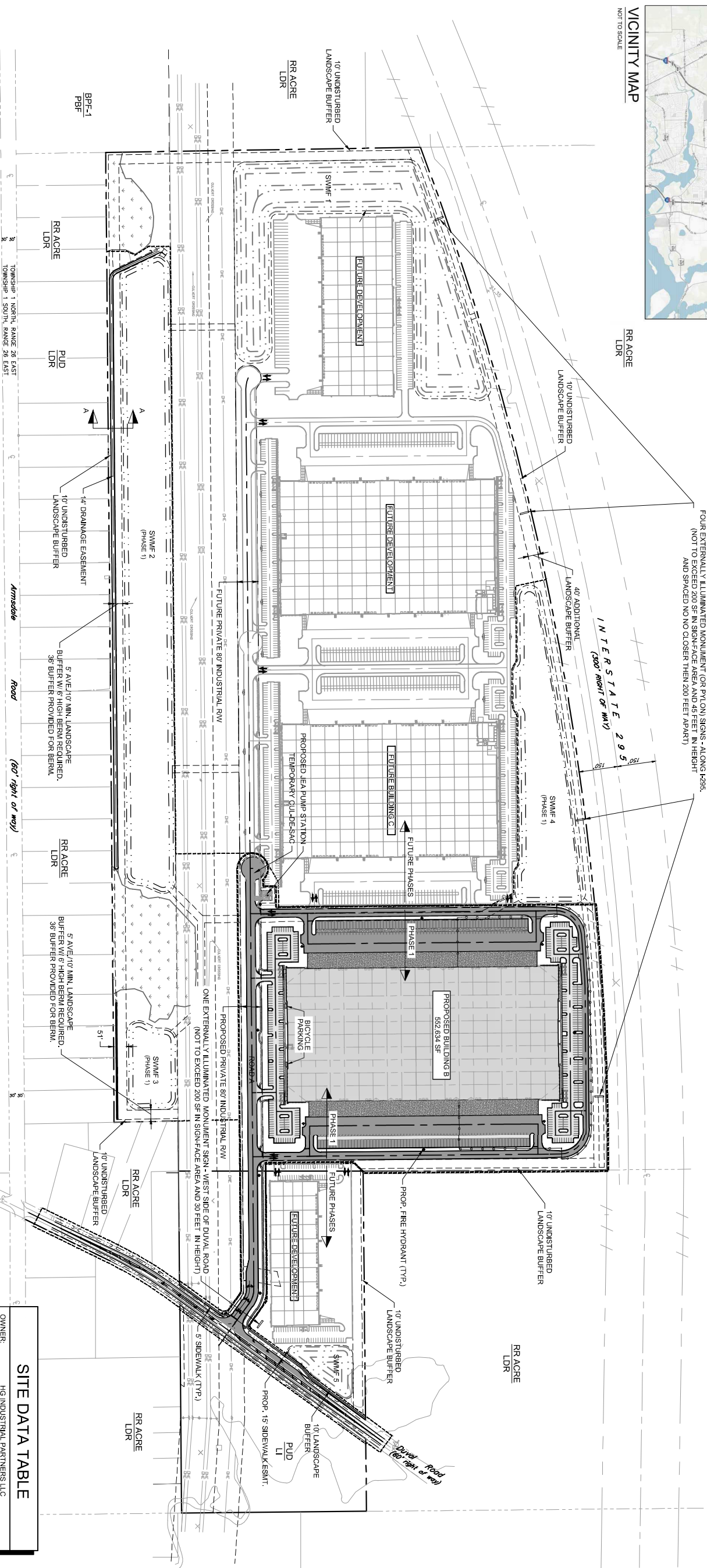

FOUR EXTERNALLY ILLUMINATED MONUMENT (OR Pylon) SIGNS - ALONG I295.
(NOT TO EXCEED 200 SF IN SIGN-FACE AREA AND 45 FEET IN HEIGHT
AND SPACED NO CLOSER THEN 200 FEET APART)

INTERSTATE 295
(300' RIGHT OF WAY)

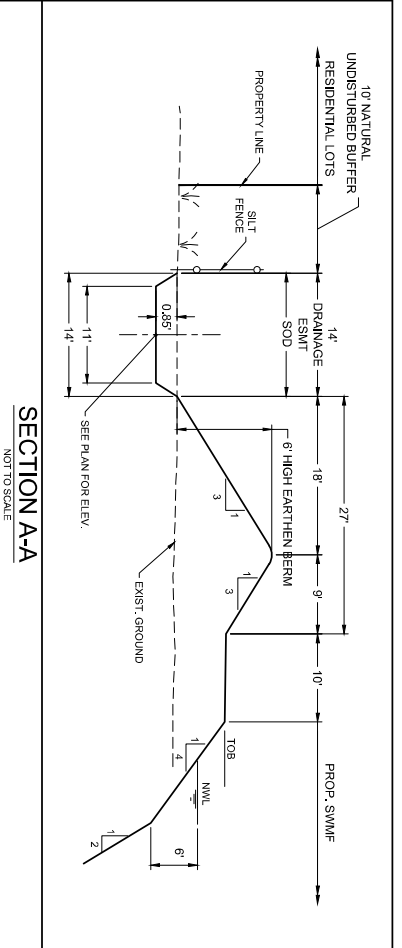

BUILDING B (PHASE 1)		
BUILDING SF	TOTAL	552,834 SF
	OFFICE SPACE (3 SP/ST/1,000 SF OF OFFICE SPACE)	44,210 SF
	INDUSTRIAL SPACE (1 SP/ST/2,000 SF OF INDUSTRIAL SPACE)	508,624 SF
PARKING	REQUIRED	PROVIDED
TRUCK STORAGE	NA	138
PARKING STALLS	380	408
HANDICAP STALLS	8	12
TOTAL STALLS	388	420
BICYCLE PARKING	20	20

SITE DATA TABLE			
OWNER:	HG INDUSTRIAL PARTNERS LLC		
ADDRESS:	0 DUVAL STREET, JACKSONVILLE, FL 32218		
DEVELOPER:	NORTHPOINT DEVELOPMENT		
SURVEYOR:	R.H. HOLLAND & ASSOCIATES, INC.		
RE:	019539 006, 019540 0200		
USE:	LIGHT INDUSTRIAL		
NUMBER OF BUILDINGS:	MULTIPLE		
ZONING:	PUD (2009-14-3E)		
LANDUSE:	LI		
PHASES:	MULTIPLE		
MAX. HEIGHT ALLOWED:	45'		
FEMA FLOOD ZONE:	ZONE 'X' & 'X500'		
LOT DATA:			
	TOTAL (Ac)	TOTAL (%)	
TOTAL AREA	171.84 Ac	100.0%	
IMPERVIOUS AREA - PHASE 1	1,209,861 SF	15.9%	
BLDG. LOT COVERAGE	2,021,257 SF	28.5%	

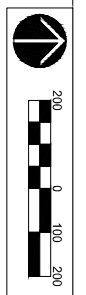

RR ACRE LDR

RR ACRE LDR

RR ACRE LDR

RR ACRE LDR

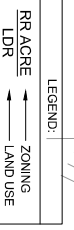

PROSSER
Community - Management - Energy - Relationships
13901 Sutton Park Drive South, Suite 200
Jacksonville, Florida 32224-0229
Office 904.739.3855
Fax 904.730.3113
www.prosserinc.com
Florida Certificate of Authorization
Number: 00004050

NorthPoint DEVELOPMENT

PARK 295 INDUSTRIAL

DATE: 3/15/2021
PROJECT NO.: 118028-01
DESIGNED BY: JU
DRAWN BY: MB
SCALE: AS NOTED

THIS DRAWING NOT RELEASED FOR CONSTRUCTION UNLESS SO NOTED ABOVE

PUD VERIFICATION PLAN

JENNER B. URSAN
FL LIC. NO. 7454
DATE: _____

C2.00

SHEET