

Proposed Closure -- Braddock Home Road

RE 019250-0000

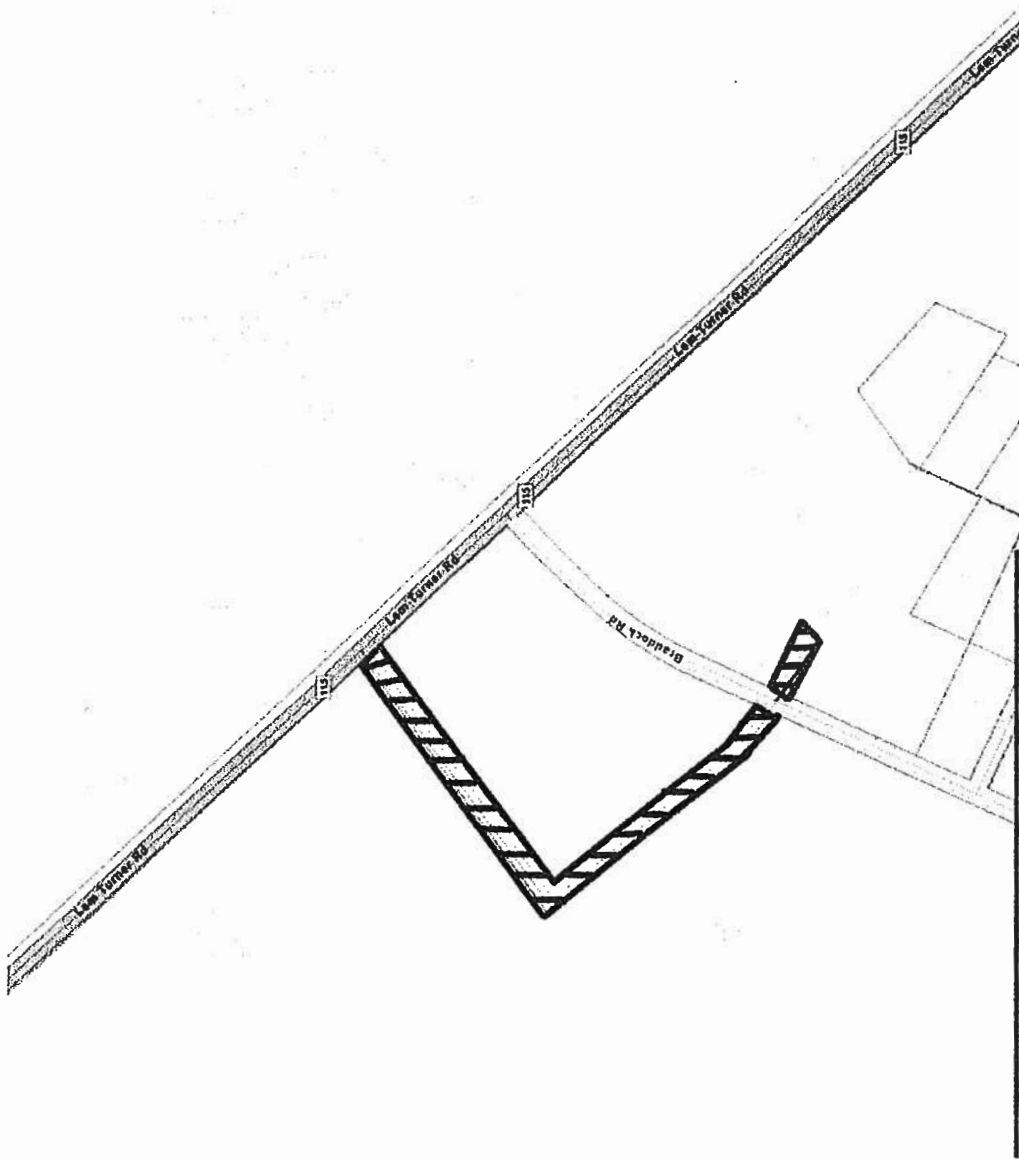

Proposed Closure – Braddock Home Road

RE 019250-0000



Revised April 18, 2024
January 12, 2024

Work Order No. 21-073.03
File No. 127G-22.03A

Vacation Parcel A

A portion of Section 19, Township 1 North, Range 26 East, Duval County, Florida, being the same lands described and recorded in Deed Book 1645, page 130, of the current Public Records of said county, being more particularly described as follows:

For a Point of Reference, commence at the intersection of the Westerly right of way line of Braddock Road, a public 66 foot right of way as presently established, with the Southwesterly right of way line of State Road No. 115 (Lem Turner Road), a public variable width right of way as presently established; thence North $42^{\circ}38'25''$ West, along said Southwesterly right of way line, 522.22 feet to its intersection with the Southeasterly right of way line of Braddock Home Road, a public 60 foot right of way as presently established; thence South $54^{\circ}51'35''$ West, departing said Southwesterly right of way line and along said Southeasterly right of way line, 30.26 feet to the Point of Beginning.

From said Point of Beginning, thence continue South $54^{\circ}51'35''$ West, 874.69 feet; thence South $38^{\circ}47'35''$ East, 703.63 feet; thence South $64^{\circ}51'45''$ East, 149.93 feet to a point lying on said Westerly right of way line of Braddock Road; thence South $25^{\circ}24'30''$ West, along said Westerly right of way line, 60.00 feet; thence North $64^{\circ}51'45''$ West, departing said Westerly right of way line, 163.54 feet; thence North $38^{\circ}47'35''$ West, 781.47 feet; thence North $54^{\circ}51'35''$ East, 930.75 feet; thence South $42^{\circ}38'25''$ East, along a line 30 feet Southwesterly of and parallel with said Southwesterly right of way line of State Road No. 115, a distance of 60.52 feet to the Point of Beginning.

Containing 2.48 acres, more or less.



January 12, 2024

Work Order No. 21-073.03
File No. 127G-22.03B

Vacation Parcel B

A portion of Section 19, Township 1 North, Range 26 East, Duval County, Florida, being the same lands described and recorded in Deed Book 1654, page 418, of the current Public Records of said county, being more particularly described as follows:

For a Point of Reference, commence at the intersection of the Southwesterly right of way line of State Road No. 115 (Lem Turner Road), a public variable width right of way as presently established, with the Westerly right of way line of Braddock Road, a public 66 foot right of way as presently established; thence Southwesterly along said Westerly right of way line the following 3 courses: Course 1, thence South 46°17'10" West, 139.38 feet to the point of curvature of a curve concave Southeasterly having a radius of 1465.40 feet; Course 2, thence Southwesterly along the arc of said curve, through a central angle of 20°52'41", an arc length of 533.98 feet to the point of tangency of said curve, said arc being subtended by a chord bearing and distance of South 35°50'49" West, 531.03 feet; Course 3, thence South 25°24'30" West, 236.32 feet; thence South 50°25'55" East, departing said Westerly right of way line, 68.07 feet to the Point of Beginning.

From said Point of Beginning, thence continue South 50°25'55" East, 266.23 feet; thence South 39°34'05" West, 60.00 feet; thence North 50°25'55" West, 251.10 feet to a point lying on the Easterly right of way line of said Braddock Road; thence North 25°24'30" East, along said Easterly right of way line, 61.88 feet to the Point of Beginning.

Containing 15,520 square feet, more or less.

APPROVED
DESCRIPTION AGREES
WITH MAP
CITY ENGINEERS OFFICE
TOPO/SURVEY BRANCH
By *[Signature]* Date 4-18-24