

PROJECT SUMMARY

PORTION OF PARCEL 120735-0016
12.16 ACRES (529,481 SF)
EIGHT 3 STORY BUILDINGS WITH STAND
ALONE CLUBHOUSE
BUILDING HEIGHT - 45' +/-

240 TOTAL UNITS

96 ONE BED / ONE BATH - 40%
96 TWO BED / TWO BATH - 40%
48 THREE BED / TWO BATH - 20%

PARKING

1.75 SPACES PROVIDED PER UNIT

ZONING

MEDIUM DENSITY RESIDENTIAL

(MDR) FUTURE LAND USE

MAX DENSITY - 20 UNITS PER ACRE
(19.7 PROVIDED)

SETBACKS

FRONT - 20'
REAR - 20'
SIDE - 20'

RETENTION

63,273 SF PROVIDED (12%)
CIVIL ENGINEER TO VERIFY

TEST FIT DISCLAIMER

THIS DOCUMENT IS CONCEPTUAL IN NATURE AND IS PROVIDED TO PRESENT GENERAL DESIGN INTENT ONLY. THE DESIGN IS SUBJECT TO CHANGE PENDING INPUT FROM THE PROJECT'S ENGINEERS AND ADDITIONAL JURISDICTIONAL REQUIREMENTS UNKNOWN AT THE TIME OF PRODUCING THIS DOCUMENT.

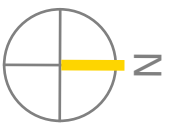

bold line

d e s i g n

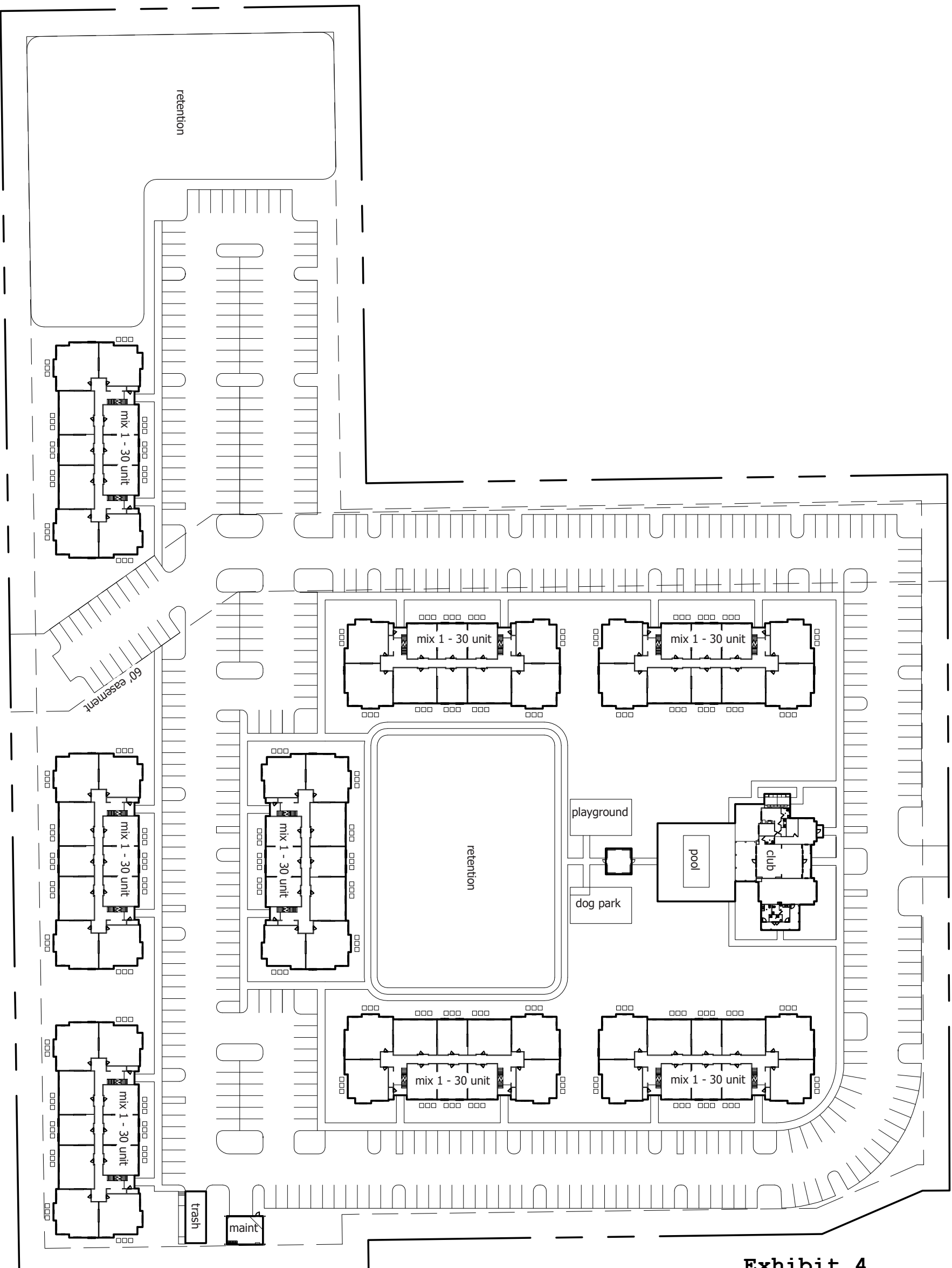

vestcor - lakeview multi-family test fit

first floor plan
scale: 1"=80'-0"

1

06.15.22

June 15, 2022

Exhibit 4
Page 1 of 1

©2022 BOLD LINE DESIGN LLC. ALL CONCEPTS, DESIGNS, AND PLANS INDICATED OR REPRESENTED BY THIS DRAWING ARE OWNED BY AND THE PROPERTY OF BOLD LINE DESIGN LLC AND WERE DEVELOPED FOR USE ON AND IN CONNECTION WITH THE SPECIFIED PROJECT. NONE OF THE CONCEPTS, DESIGNS, OR PLANS SHALL BE USED BY OR DISCLOSED TO ANY PERSON, FIRM, OR CORPORATION FOR ANY PURPOSE WITHOUT THE WRITTEN PERMISSION OF BOLD LINE DESIGN LLC.