

RE#073944-0000 (241 Ashley Street W.) Jacksonville Fire and Rescue Department	RE#073946-0000 (225 Ashley Street W.)	RE#073945-0000 (124 Ashley Street W.) AERIAL MAP
--	---------------------------------------	---



RE#073944-0000 (241 Ashley Street W.) Jacksonville Fire and Rescue Department	RE#073946-0000 (275 Ashley Street W.)	RE#073945-0000 (124 Ashley Street W.) LOCATION MAP
--	---------------------------------------	---

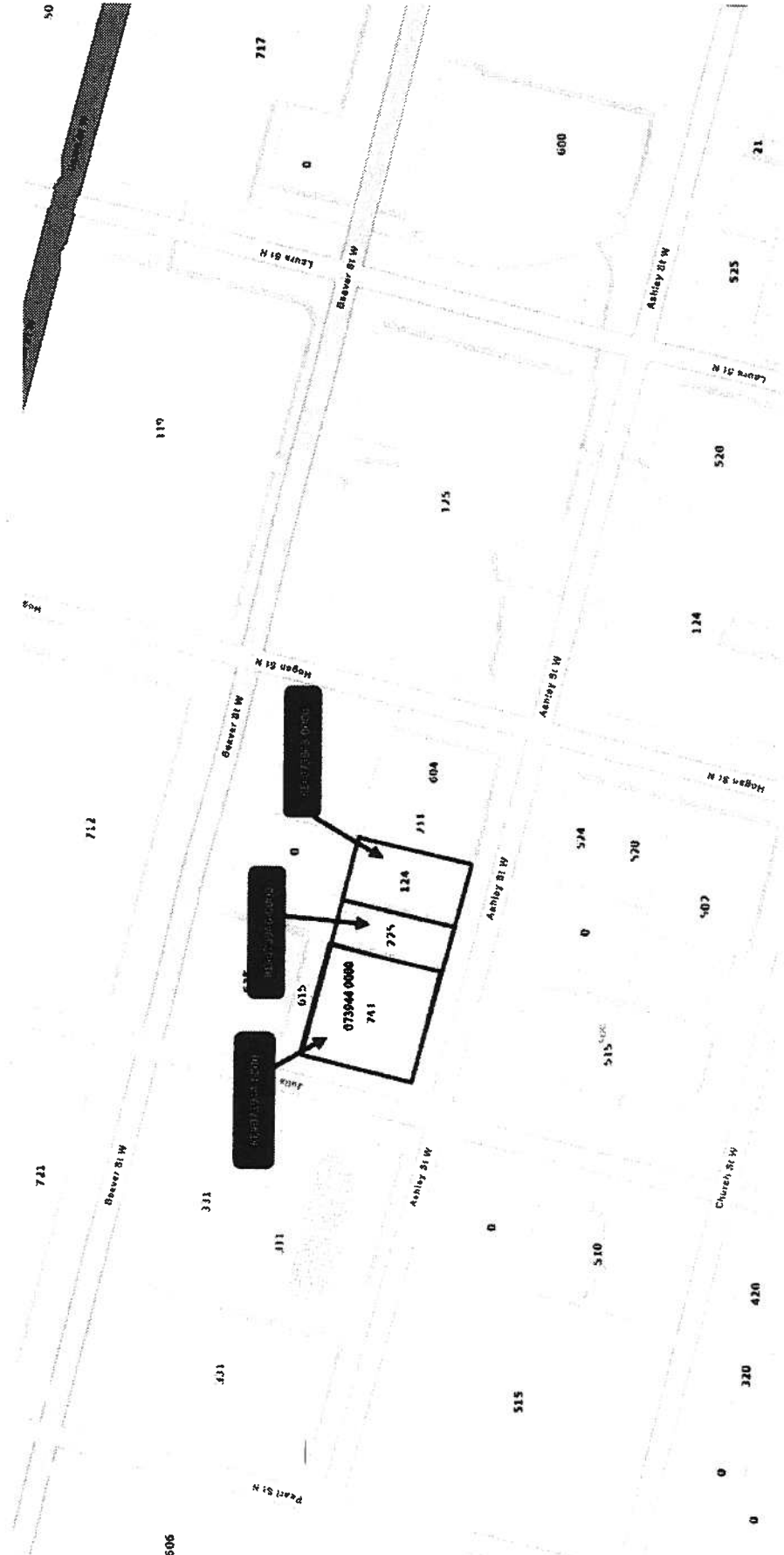

EXHIBIT A
legal Descriptions

Parcel 1 (241 Ashley Street W, Parcel # R-073944-0000)

LOT 1, BLOCK 69, HARTS MAP OF JACKSONVILLE. SITUATE ON THE NORTH SIDE OF ASHLEY STREET BETWEEN HOGAN AND JULIA STREETS. OF THE FORMER PUBLIC RECORDS OF DUVAL COUNTY, FLORIDA, BEING THE SAME LANDS DESCRIBED IN DEED BOOK 1201, PAGE 236 AND OFFICIAL RECORDS BOOK 1390, PAGE 547 TOGETHER WITH EASEMENTS DESCRIBED IN DUVAL COUNTY, FLORIDA. DEED BOOK 1291, PAGE 142 AND OFFICIAL RECORDS BOOK 1390, PAGE 546 AND 547

Parcel 2 (225 Ashley Street W, Parcel # R-073946-0000)

THE WEST 43 75 FEET OF LOT 2, BLOCK 69, HART'S MAP OF JACKSONVILLE. DUVAL COUNTY, FLORIDA.

Parcel 3 (124 Ashley Street W, Parcel # R-073945-0000)

THE EAST SIXTY-ONE AND ONE-QUARTER (61- 1/4) FEET OF LOT TWO (2), BLOCK SIXTY-NINE (69), HARTS MAP OF JACKSONVILLE, BEING BOUNDED ON THE NORTH BY THE SOUTH LINE OF LOT FIVE (5), ON THE EAST BY THE WEST LINE OF LOT THREE (3), ON THE SOUTH BY THE NORTH LINE OF WEST ASHLEY STREET. AND ON THE WEST BY THE EAST LINE OF THE REMAINING WESTERLY PORTION OF SAID LOT TWO (2) IN SAID BLOCK SIXTY-NINE (69).

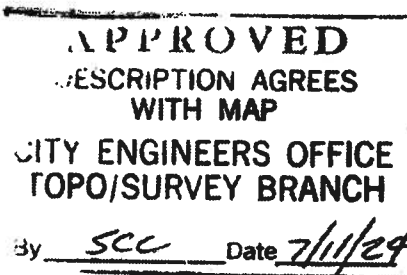

Beaver St W

10

10

Beaver St W

331



Ashley St W

N Hegan St

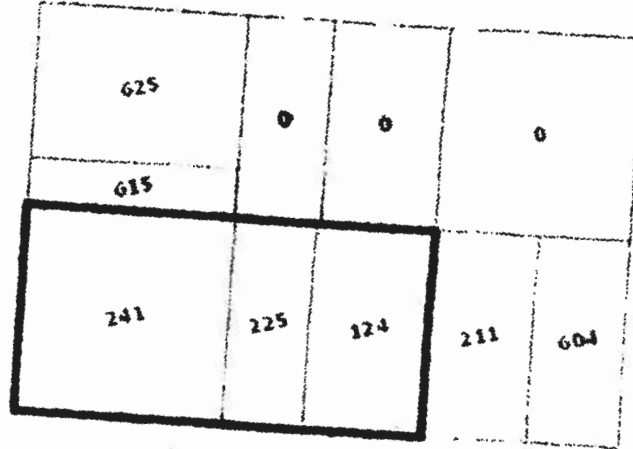

524