

- Key**
- ① TREE DRIP-LINE PERIMETER FENCING PLACED AT 100% OF DRIP-LINE EDGE OF PROTECTED TREE.
 - ② BARRIER FENCING (FABRIC MESH OR OTHER) WITH WIRE TIES TO REBAR POSTS.
 - ③ #5 REBAR POSTS WITH PROTECTIVE CAPS.

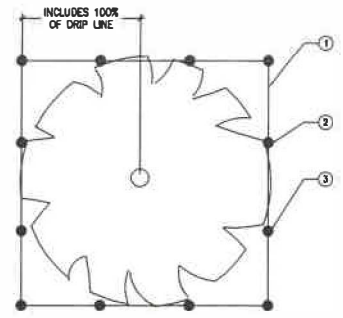

PLAN
NO SCALE

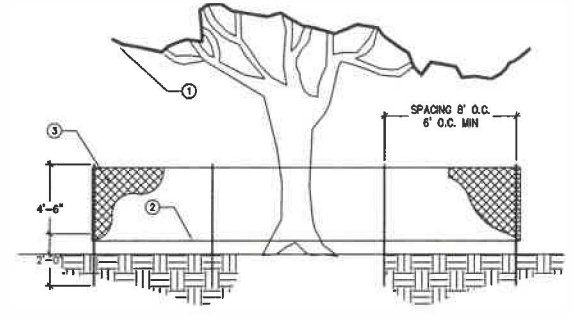

ELEVATION
NO SCALE

NOTE:
1. BARRICADES ARE TO BE PLACED PRIOR TO ANY LAND CLEARING OR CONSTRUCTION ACTIVITY.

1 TREE PROTECTION FENCING
LD-01 Plan & Elevation

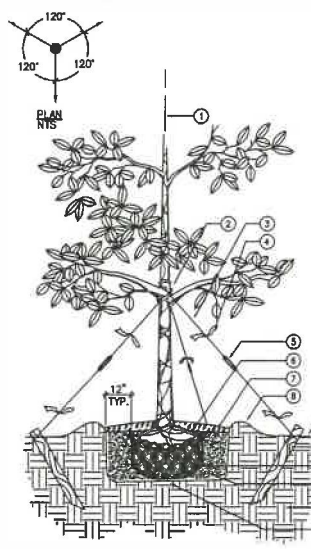

- Key**
- ① SET TREE PLUMB IN PLANTING PIT.
 - ② PROTECT TREE TRUNK WITH BLACK RUBBER OR PLASTIC FRICION GUARDS.
 - ③ CUTTING WIRE AS SPECIFIED.
 - ④ WHITE SURVEYORS TAPE ON GUY WIRES ABOVE & BELOW HAND TENSIONERS TYP.
 - ⑤ HAND TENSIONER AS SPECIFIED.
 - ⑥ REMOVE TOP 1/3 BURLAP AND WIRE CAGE FROM ROOTBALL.
 - ⑦ MULCH LAYER AS SPECIFIED.
 - ⑧ TEMPORARY SOIL BERM TO HOLD WATER.
 - ⑨ FINISH GRADE.
 - ⑩ ANCHOR STAKE AS SPECIFIED.
 - ⑪ BAG OR CONTAINERIZED ROOTBALL SEE SPECIFICATIONS FOR ROOTBALL REQUIREMENTS.
 - ⑫ PLANTING SOIL AS SPECIFIED.
 - ⑬ UNDISTURBED SUBGRADE.
 - ⑭ SET ROOTBALL ON UNDISTURBED SUBGRADE.

NOTES:
1. CONTRACTOR TO ASSURE PERCOLATION IN TREE PITS.
2. TOP OF ROOTBALL SHALL BE 3" ABOVE FINISH GRADE.

3 TYPICAL LARGE TREE STAKING
LD-01 Plan & Elevation

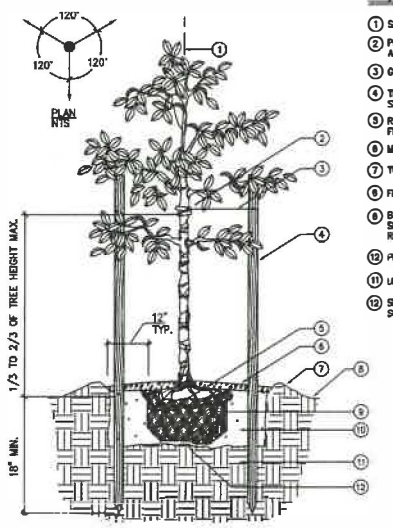

- Key**
- ① SET TREE PLUMB IN PLANTING PIT.
 - ② PROTECT TREE TRUNK WITH FRICION GUARDS AS SPECIFIED.
 - ③ CUTTING WIRE AS SPECIFIED.
 - ④ THREE 2" DIAM X 6' P.T. WOOD STAKES AS SPECIFIED.
 - ⑤ REMOVE TOP 1/3 BURLAP AND WIRE CAGE FROM ROOTBALL.
 - ⑥ MULCH LAYER AS SPECIFIED.
 - ⑦ TEMPORARY SOIL BERM TO HOLD WATER.
 - ⑧ FINISH GRADE.
 - ⑨ BAG OR CONTAINERIZED ROOTBALL SEE SPECIFICATIONS FOR ROOTBALL REQUIREMENTS.
 - ⑩ PLANTING SOIL AS SPECIFIED.
 - ⑪ UNDISTURBED SUBGRADE.
 - ⑫ SET ROOTBALL ON UNDISTURBED SUBGRADE.

NOTES:
1. CONTRACTOR TO ASSURE PERCOLATION IN TREE PITS.
2. TOP OF ROOTBALL SHALL BE 3" ABOVE FINISH GRADE AFTER SETTING.

4 TYPICAL SMALL TREE STAKING
LD-01 Plan & Elevation

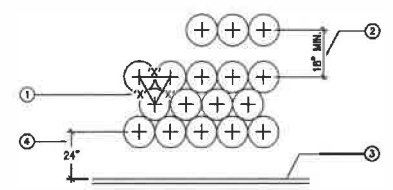

- Key**
- ① 'X' - ON CENTER SPACING; SEE PLANT LIST.
 - ② PROVIDE MINIMUM 18" SPACING BETWEEN DIFFERENT PLANT TYPES.
 - ③ CURB OR EDGE OF PAVEMENT.
 - ④ 24" SETBACK FOR SHRUBS PLANTED OPPOSITE PARKING SPACES WITHOUT BUMPER BLOCKS.
- NOTE:**
ALL SHRUBS AND GROUND-COVER MASSSES TO USE TRIANGULAR SPACING EXCEPT IN SMALL RECTANGULAR AREAS. REFER TO PLANT LIST FOR INDIVIDUAL PLANT SPACING.

2 TYPICAL SHRUB & GROUNDCOVER SPACING
LD-01 Plan

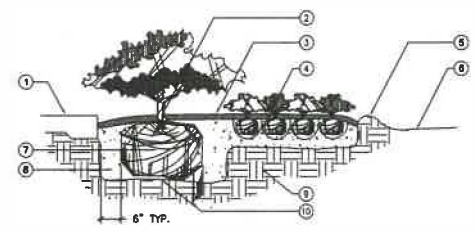

- Key**
- ① TYP. FINISH GRADE @ PAVEMENT, SOO OR MULCH BED.
 - ② PLANTS SHALL BE PLANTED 2" ABOVE FINISHED GRADE WITH SOIL MOUNDING UP TO THE TOP OF THE ROOT BALL.
 - ③ MULCH LAYER AS SPECIFIED.
 - ④ EXCAVATE INDIVIDUAL PLANT PITS AND BACKFILL WITH PLANTING SOIL AS SPECIFIED.
 - ⑤ TEMPORARY SOIL BERM TO HOLD WATER.
 - ⑥ FINISH GRADE.
 - ⑦ CONTAINERIZED OR B&B.
 - ⑧ PLANTING SOIL AS SPECIFIED.
 - ⑨ UNDISTURBED SUBGRADE.
 - ⑩ SET ROOTBALL ON UNDISTURBED SUBGRADE.

5 TYPICAL SHRUB & GROUNDCOVER PLANTING
LD-01 Elevation

TYPICAL LARGE SHADE TREE - LIVE OAK SEE PLANTING PLAN
TYPICAL SMALL UNDERSTORY TREE - FLOWERING BERRY LAUREL - SEE PLANTING PLAN
REF TO PLANTING AND STAKING DETAILS FOR INSTALLATION
TYPICAL UNDERSTORY EVERGREEN SHRUB - HYFORD DWARF HOLLY - SEE PLANTING PLAN
BIGRADE SOILS

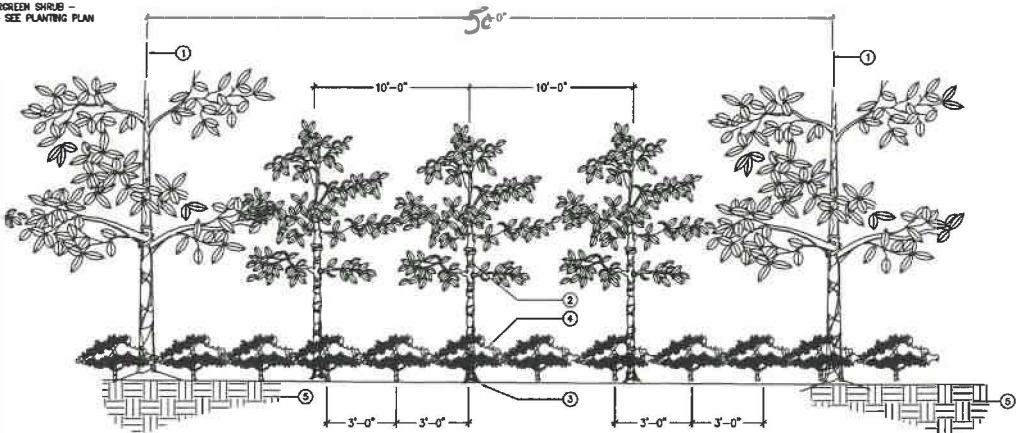

6 BUFFER PLANTING TYPICAL
LD-01 Section & Elevation

Sheet Notes



VICINITY MAP
NOT TO SCALE

PLAN SET LEGEND

- LA-01 EXISTING SURVEY & MASTER PLAN LAYOUT
- LA-02 MASTER PLAN LAYOUT M-LINE A-A
- LA-03 MASTER PLAN LAYOUT M-LINE B-B
- LA-04 MASTER PLAN LAYOUT M-LINE C-C
- LA-05 MASTER PLANTING PLAN M-LINE 1-1 & 2-2
- LA-06 MASTER PLANTING PLAN M-LINE 3-3 & 4-4
- LA-07 MASTER PLANTING PLAN M-LINE 5-5
- LD-01 LANDSCAPE DETAILS
- LD-02 LANDSCAPE DETAILS

THESE DOCUMENTS AND THEIR CONTENTS ARE THE PROPERTY OF THE OWNER AND ARE ISSUED ONLY FOR THE SPECIFIC PROJECT NOTED ON THESE DRAWINGS. ANY REPRODUCTION OR REDISTRIBUTION WITHOUT THE EXPRESSED WRITTEN CONSENT OF THE OWNER IS PROHIBITED BY LAW.

CHARLOTTE'S POINT
DUVAL COUNTY
Jacksonville, Florida 32218

© 2020 CEDAR BAY STUDIOS

: EHS rev: EHS
DATE: 8/18/2021
7/30/21
project number

LANDSCAPE NOTES & DETAILS

sheet number

LD-01

PLANTING LIST

TREES	TYPE	SPECIES	SPECIFICATION	SPACING
PC	Evergreen / Flowering	Prunus caroliniana - Cherry Laurel	8-10' Ht., 2" cal., nursery grown	10' o.c.
QV	Shade	Quercus virginiana - Live Oak	12-14' Ht., 4'-5' spd., 3" cal., nursery grown	50' o.c.
SHRUBS				
ICB	Evergreen / Shrub	Ilex Cornuta 'Burfordii' - Dwarf Burford Holly	3 gal., 18" x 18" Ht and Spread, Full	36" o.c.
AF	Flowering / Shrub	Azalea Formosa - Azalea x (Owner Color Select)	1 gal., 12" x 10" , bush form	24" o.c.
ANN	Flowering	Select Annuals - Seasonal Mix (Owner Select)	4" POTS., 6" x 6" , full and flowering	12" o.c.
GRASS				
SOD	SOD	Paspalum Notatum- Argentine Bahia Sod	Sand-laid, end to end and/ or rolled	Solid Sod

** All planting materials (Trees and Shrubs) shall be nursery grown graded Florida #1 or approved equal.



1
LD-02 SPLIT RAIL FENCE w/ SIGNAGE INSERT (Owners Select)

PLANTING NOTES AND SPECIFICATIONS:

- THE SUGGESTED MINIMUM COMPOSITION OF A TYPICAL BUFFER AREA SHALL CONSIST OF THE FOLLOWING:
 - ONE (1) EXISTING PRESERVED OR PROPOSED NEW CANOPY SHADE TREES MIN 3" CALIPER, 12' HT. PER EVERY 50 LINEAL FEET
 - THREE (3) EXISTING PRESERVED OR PROPOSED NEW FLOWERING TREES (EXCLUDING ANY PALM TREES) MIN 2" CALIPER, 8-10' HT. PER EVERY 10' LINEAL FEET
 - THREE (3) UNDERSTORY/ FLOWERING TREES MIN 2" CALIPER, 8' HT.
 - A DOUBLE ROW OF A CONTINUOUS EVERGREEN SHRUB WITH A SPACING OF 3' ON CENTER AS UNDERSTORY TO THE EXISTING PRESERVED OR NEW TREE CANOPY.
- ALL EXISTING MATERIALS THAT ARE 4" OR LARGER IN CALIPER SIZE WHICH ARE IDENTIFIED (BY OWNERS) TO BE PRESERVED AND/ OR PROTECTED SHALL REMAIN WITHIN THE BUFFER AREAS & COUNT FOR THE COMPOSITION OF MATERIALS.
- THE LAYOUT OF ALL PLANTING BEDS SHALL OVERLAP RANDOMLY INTO ADJOINING BED/ BUFFER AREAS SO AS TO BLEND INTO THE EXISTING AND/ OR PRESERVED LANDSCAPE SUCH THAT IT CREATES A NATURAL LOOKING LANDSCAPE.
- INTERIOR PORTIONS OF EACH BED/ BUFFER AREA SHALL BE PLANTED AT APPROPRIATE AVERAGE SPACING PER THE PLANTING LIST AND AT THE DIRECTION BY OWNERS.
- ANY UNDERSTORY SHRUBS SHALL BE PLANTED ON REGULAR TRIANGULATED SPACING AS NOTED IN THE DETAIL OF TYPICAL GROUNDCOVER/ SHRUB PLANTING.
- THE CONTRACTOR SHALL LAYOUT A TEST AREA WITH MATERIALS ADJOINING FOR REVIEW AND APPROVAL BY THE OWNER PRIOR TO INSTALLATION.

Sheet Notes



VICINITY MAP
NOT TO SCALE

PLAN SET LEGEND

- LA-01 EXISTING SURVEY & MASTER PLAN LAYOUT
- LA-02 MASTER PLAN LAYOUT M-LINE A-A
- LA-03 MASTER PLAN LAYOUT M-LINE B-B
- LA-04 MASTER PLAN LAYOUT M-LINE C-C
- LA-05 MASTER PLANTING PLAN M-LINE 1-1 & 2-2
- LA-06 MASTER PLANTING PLAN M-LINE 3-3 & 4-4
- LA-07 MASTER PLANTING PLAN M-LINE 5-5
- LD-01 LANDSCAPE DETAILS
- LD-02 LANDSCAPE DETAILS

THESE DOCUMENTS AND THEIR CONTENTS ARE THE PROPERTY OF THE OWNER AND ARE ISSUED ONLY FOR THE SPECIFIC PROJECT NOTED ON THESE DRAWINGS. ANY REPRODUCTION OR REDISTRIBUTION WITHOUT THE EXPRESSED WRITTEN CONSENT OF THE OWNER IS PROHIBITED BY LAW.

CHARLOTTE'S POINT
DUVAL COUNTY
Jacksonville, Florida 32218

© 2020 CEDAR BAY STUDIOS

DATE: 7/30/21
BY: [Signature]
PROJECT NUMBER

LANDSCAPE NOTES & DETAILS

sheet number

LD-02

The North 1/2, of the Southwest 1/4, of Section 32

(SEE SURVEY BY CLARY & ASSOCIATES, FILE NO. TM-32, DATED JUNE 24, 1994 FOR THE ST. JAMES RIVER WATER MANAGEMENT DISTRICT)

NOTICE: THE SOUTH-EAST 1/4 OF THE SW-1/4 OF SECTION 32 IS BEING OFFERED TO THE PUBLIC BY THE STATE OF FLORIDA THROUGH THE DEPARTMENT OF REVENUE. THE DISTANCE OF APPROXIMATELY TWO HUNDRED FIFTY FEET, COMPARED AT THE SAME TIME IT STATES "TO THE NORTH LINE OF THE SW-1/4 OF THE SW-1/4 OF SECTION 32," HOWEVER, THE ENTIRE PARCEL IS SHOWN IN SECTION 32.

WARRANTY DEED: LUCAS S. WAINPA, BIRTH OF WAINPA WORTH, (HEREINAFTER) TO GARY GUYE, BAPTIST CHURCH, DEED BOOK 1371, PAGE 407.

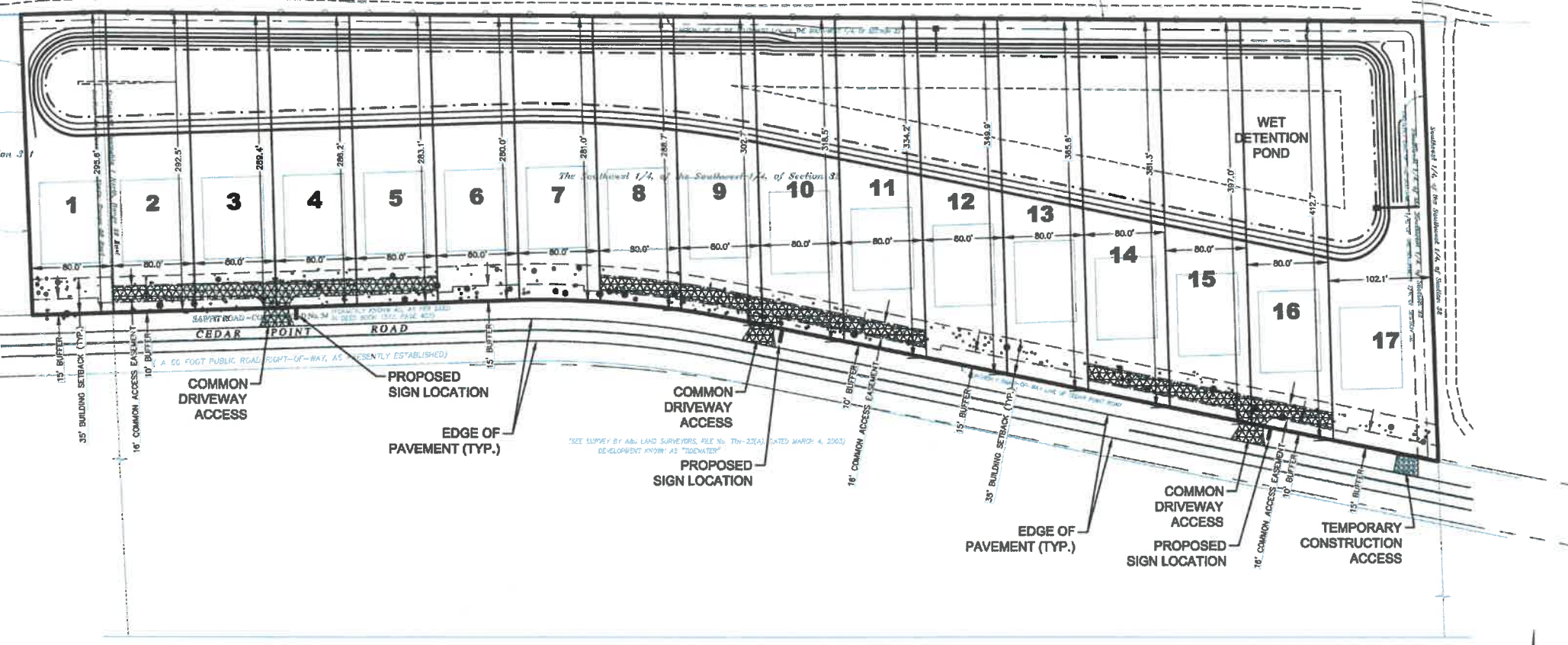

Sheet Notes

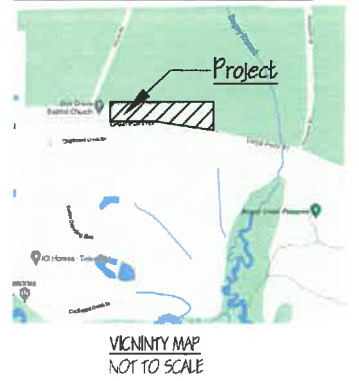

PLAN SET LEGEND

- LA-01 EXISTING SURVEY & MASTER PLAN LAYOUT
- LA-02 MASTER PLAN LAYOUT M-LINE A-A
- LA-03 MASTER PLAN LAYOUT M-LINE B-B
- LA-04 MASTER PLAN LAYOUT M-LINE C-C
- LA-05 MASTER PLANTING PLAN M-LINE 1-1 & 2-2
- LA-06 MASTER PLANTING PLAN M-LINE 3-3 & 4-4
- LA-07 MASTER PLANTING PLAN M-LINE 5-5
- LD-01 LANDSCAPE DETAILS
- LD-02 LANDSCAPE DETAILS

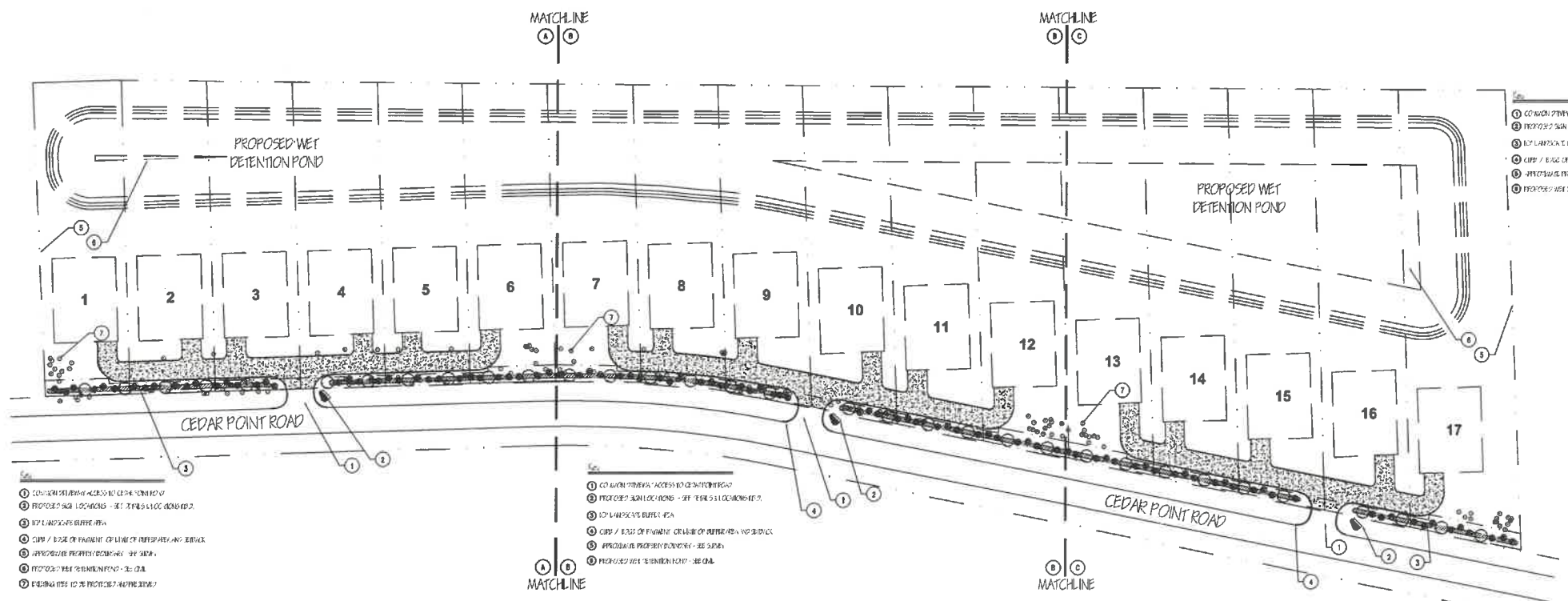

- 1 COMMON DRIVEWAY ACCESS TO CEDAR POINT ROAD
- 2 PROPOSED SIGN LOCATIONS - SEE THESE SHEETS FOR DETAILS
- 3 10' LANDSCAPE BUFFER PER A
- 4 CURB / EDGE OF PAVEMENT - SEE THESE SHEETS FOR DETAILS
- 5 PROPOSED PROPERTY BOUNDARY - SEE SURVEY
- 6 PROPOSED SETBACKS - SEE SURVEY

- 1 COMMON DRIVEWAY ACCESS TO CEDAR POINT ROAD
- 2 PROPOSED SIGN LOCATIONS - SEE THESE SHEETS FOR DETAILS
- 3 10' LANDSCAPE BUFFER PER A
- 4 CURB / EDGE OF PAVEMENT - SEE THESE SHEETS FOR DETAILS
- 5 PROPOSED PROPERTY BOUNDARY - SEE SURVEY
- 6 PROPOSED SETBACKS - SEE SURVEY
- 7 BUILDING SETBACK (TYP.)

THESE DOCUMENTS AND THEIR CONTENTS ARE THE PROPERTY OF THE OWNER, AND ARE ISSUED ONLY FOR THE SPECIFIC PROJECT NOTED ON THESE DRAWINGS. ANY REPRODUCTION OR REDISTRIBUTION WITHOUT THE EXPRESSED WRITTEN CONSENT OF THE OWNER IS PROHIBITED BY LAW.

CHARLOTTE'S POINT
DUVAL COUNTY
Jacksonville, Florida 32218

© 2020 CEDAR BAY STUDIOS

DATE: 6/10/21
BY: [Signature]
PROJECT NUMBER

PRELIMINARY SITE
MASTER PLAN

sheet number

LA-01

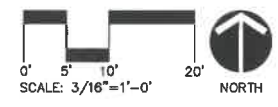

MATCHLINE

A | B

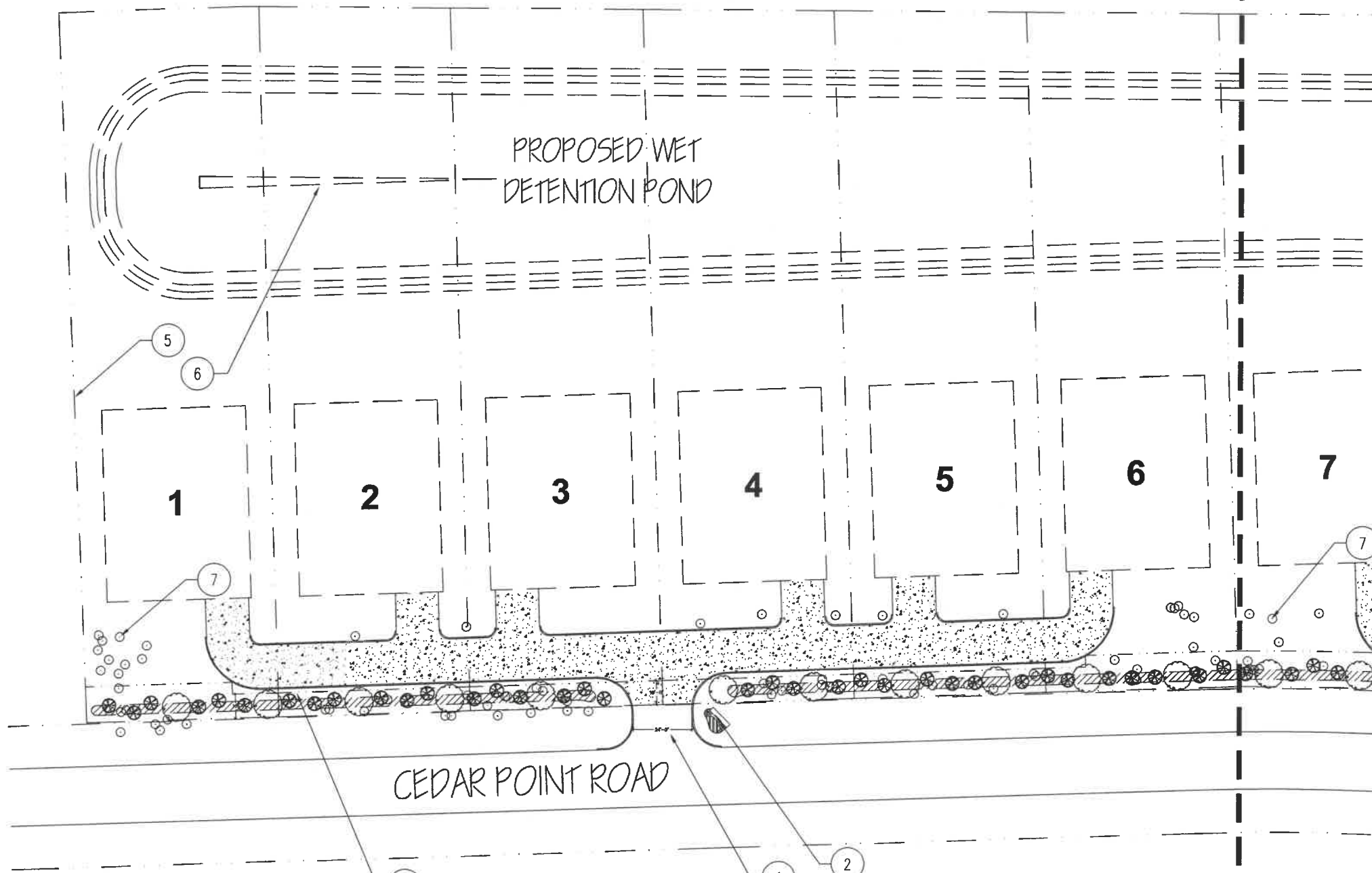

Key

- ① COMMON DRIVEWAY ACCESS TO CEDAR POINT ROAD
- ② PROPOSED SIGN LOCATIONS - SEE DETAILS & LOCATIONS T.B.D.
- ③ 10' LANDSCAPE BUFFER AREA
- ④ CURB / EDGE OF PAYMENT OR LIMIT OF BUFFER AREA AND SETBACK
- ⑤ APPROXIMATE PROPERTY BOUNDARY - SEE SURVEY
- ⑥ PROPOSED WET DETENTION POND - SEE CIVIL
- ⑦ EXISTING TREE TO BE PROTECTED AND PRESERVED

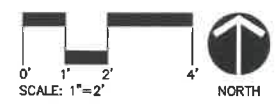

Key

- ① COMM
- ② PROPO
- ③ 10' LAN
- ④ CURB /
- ⑤ APPRO
- ⑥ PROPO
- ⑦ EXISTIN

A | B
MATCHLINE

Sheet Notes



VICINITY MAP
NOT TO SCALE

PLAN SET LEGEND

- LA-01 EXISTING SURVEY & MASTER PLAN LAYOUT
- LA-02 MASTER PLAN LAYOUT M-LINE A-A
- LA-03 MASTER PLAN LAYOUT M-LINE B-B
- LA-04 MASTER PLAN LAYOUT M-LINE C-C
- LA-05 MASTER PLANTING PLAN M-LINE 1-1 & 2-2
- LA-06 MASTER PLANTING PLAN M-LINE 3-3 & 4-4
- LA-07 MASTER PLANTING PLAN M-LINE 5-5
- LD-01 LANDSCAPE DETAILS
- LD-02 LANDSCAPE DETAILS

LEGEND KEY:

THESE DOCUMENTS AND THEIR CONTENTS ARE THE PROPERTY OF THE OWNER, AND ARE ISSUED ONLY FOR THE SPECIFIC PROJECT NOTED ON THESE DRAWINGS. ANY REPRODUCTION OR REDISTRIBUTION WITHOUT THE EXPRESSED WRITTEN CONSENT OF THE OWNER IS PROHIBITED BY LAW.

CHARLOTTE'S POINT

DUVAL COUNTY
Jacksonville, Florida 32218

© 2021 CEDAR BAY STUDIOS

DATE: 6/10/21
DATE: 2/15/2021

project number

MASTER PLAN LAYOUT A-A

sheet number

LA-02

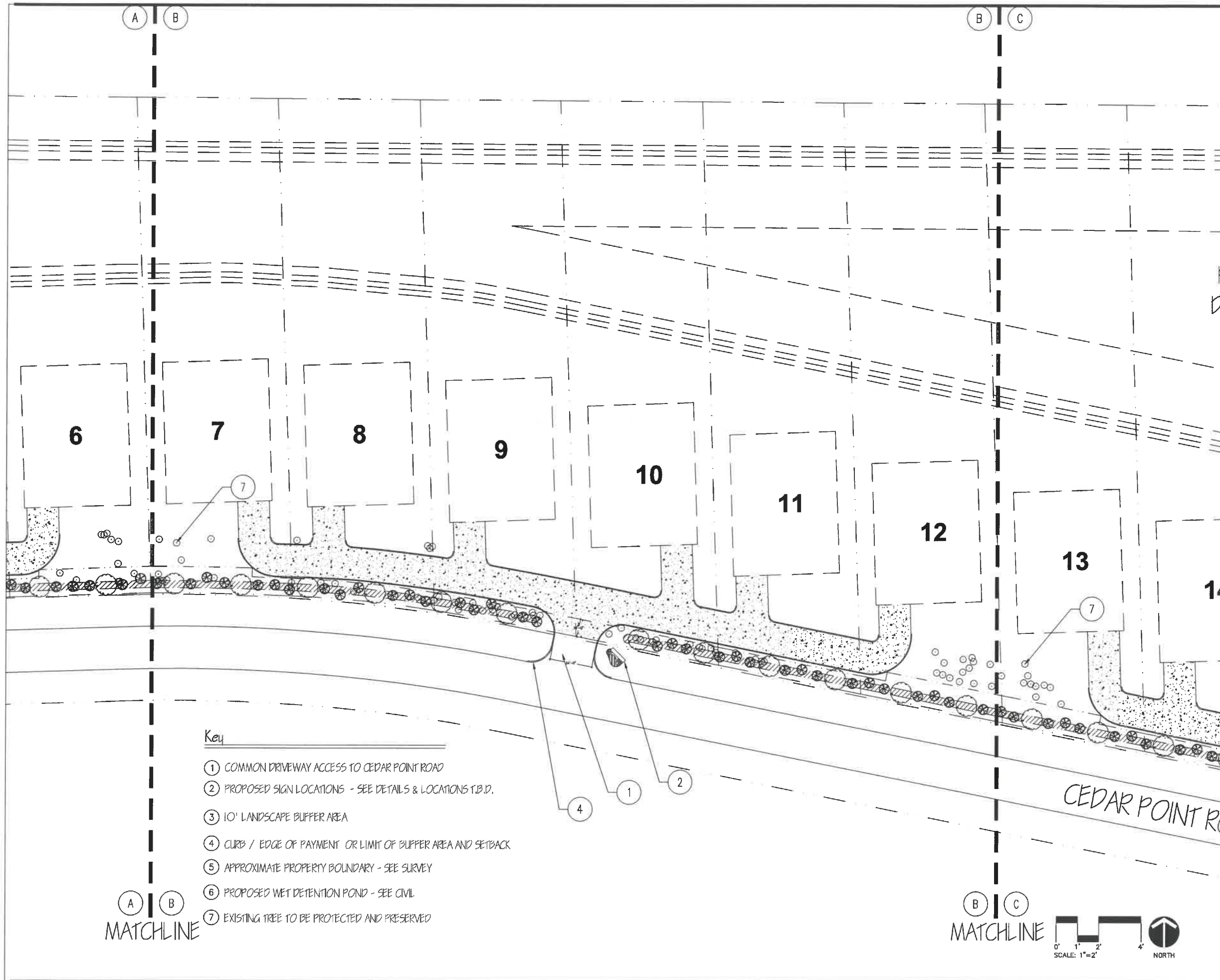

Key

- ① COMMON DRIVEWAY ACCESS TO CEDAR POINT ROAD
- ② PROPOSED SIGN LOCATIONS - SEE DETAILS & LOCATIONS T.B.D.
- ③ 10' LANDSCAPE BUFFER AREA
- ④ CURB / EDGE OF PAYMENT OR LIMIT OF BUFFER AREA AND SETBACK
- ⑤ APPROXIMATE PROPERTY BOUNDARY - SEE SURVEY
- ⑥ PROPOSED WET DETENTION POND - SEE CIVIL
- ⑦ EXISTING TREE TO BE PROTECTED AND PRESERVED

A B
MATCHLINE

B C
MATCHLINE

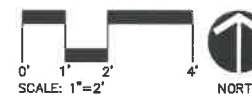

Sheet Notes



VICINITY MAP
NOT TO SCALE

PLAN SET LEGEND

- LA-01 EXISTING SURVEY & MASTER PLAN LAYOUT
- LA-02 MASTER PLAN LAYOUT M-LINE A-A
- LA-03 MASTER PLAN LAYOUT M-LINE B-B
- LA-04 MASTER PLAN LAYOUT M-LINE C-C
- LA-05 MASTER PLANTING PLAN M-LINE 1-1 & 2-2
- LA-06 MASTER PLANTING PLAN M-LINE 3-3 & 4-4
- LA-07 MASTER PLANTING PLAN M-LINE 5-5
- LD-01 LANDSCAPE DETAILS
- LD-02 LANDSCAPE DETAILS

THESE DOCUMENTS AND THEIR CONTENTS ARE THE PROPERTY OF THE OWNER, AND ARE ISSUED ONLY FOR THE SPECIFIC PROJECT NOTED ON THESE DRAWINGS. ANY REPRODUCTION OR REDISTRIBUTION WITHOUT THE EXPRESSED WRITTEN CONSENT OF THE OWNER IS PROHIBITED BY LAW.

CHARLOTTE'S POINT

DUVAL COUNTY
Jacksonville, Florida 32218

© 2020 CEDAR BAY STUDIOS

DR: EMS
DATE: 4/16/2021
BY: 6-10-21

project number

**MASTER PLAN
LAYOUT B-B**

sheet number

LA-03

Sheet Notes



VICINITY MAP
NOT TO SCALE

PLAN SET LEGEND

- LA-01 EXISTING SURVEY & MASTER PLAN LAYOUT
- LA-02 MASTER PLAN LAYOUT M-LINE A-A
- LA-03 MASTER PLAN LAYOUT M-LINE B-B
- LA-04 MASTER PLAN LAYOUT M-LINE C-C
- LA-05 MASTER PLANTING PLAN M-LINE 1-1 & 2-2
- LA-06 MASTER PLANTING PLAN M-LINE 3-3 & 4-4
- LA-07 MASTER PLANTING PLAN M-LINE 5-5
- LD-01 LANDSCAPE DETAILS
- LD-02 LANDSCAPE DETAILS

THESE DOCUMENTS AND THEIR CONTENTS ARE THE PROPERTY OF THE OWNER AND ARE ISSUED ONLY FOR THE SPECIFIC PROJECT NOTED ON THESE DRAWINGS. ANY REPRODUCTION OR REDISTRIBUTION WITHOUT THE EXPRESSED WRITTEN CONSENT OF THE OWNER IS PROHIBITED BY LAW.

CHARLOTTE'S POINT

DUVAL COUNTY
Jacksonville, Florida 32218

© 2020 CEDAR BAY STUDIOS

DATE: 6-10-21
PROJECT NUMBER

MASTER PLAN
LAYOUT C-C

sheet number

LA-04

Key

- ① COMMON DRIVEWAY ACCESS TO CEDAR POINT ROAD
- ② PROPOSED SIGN LOCATIONS - SEE DETAILS & LOCATIONS T.B.D.
- ③ 10' LANDSCAPE BUFFER AREA
- ④ CURB / EDGE OF PAYMENT OR LIMIT OF BUFFER AREA AND SETBACK
- ⑤ APPROXIMATE PROPERTY BOUNDARY - SEE SURVEY
- ⑥ PROPOSED WET DETENTION POND - SEE CIVIL
- ⑦ EXISTING TREE TO BE PROTECTED AND PRESERVED

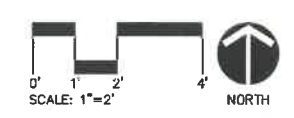
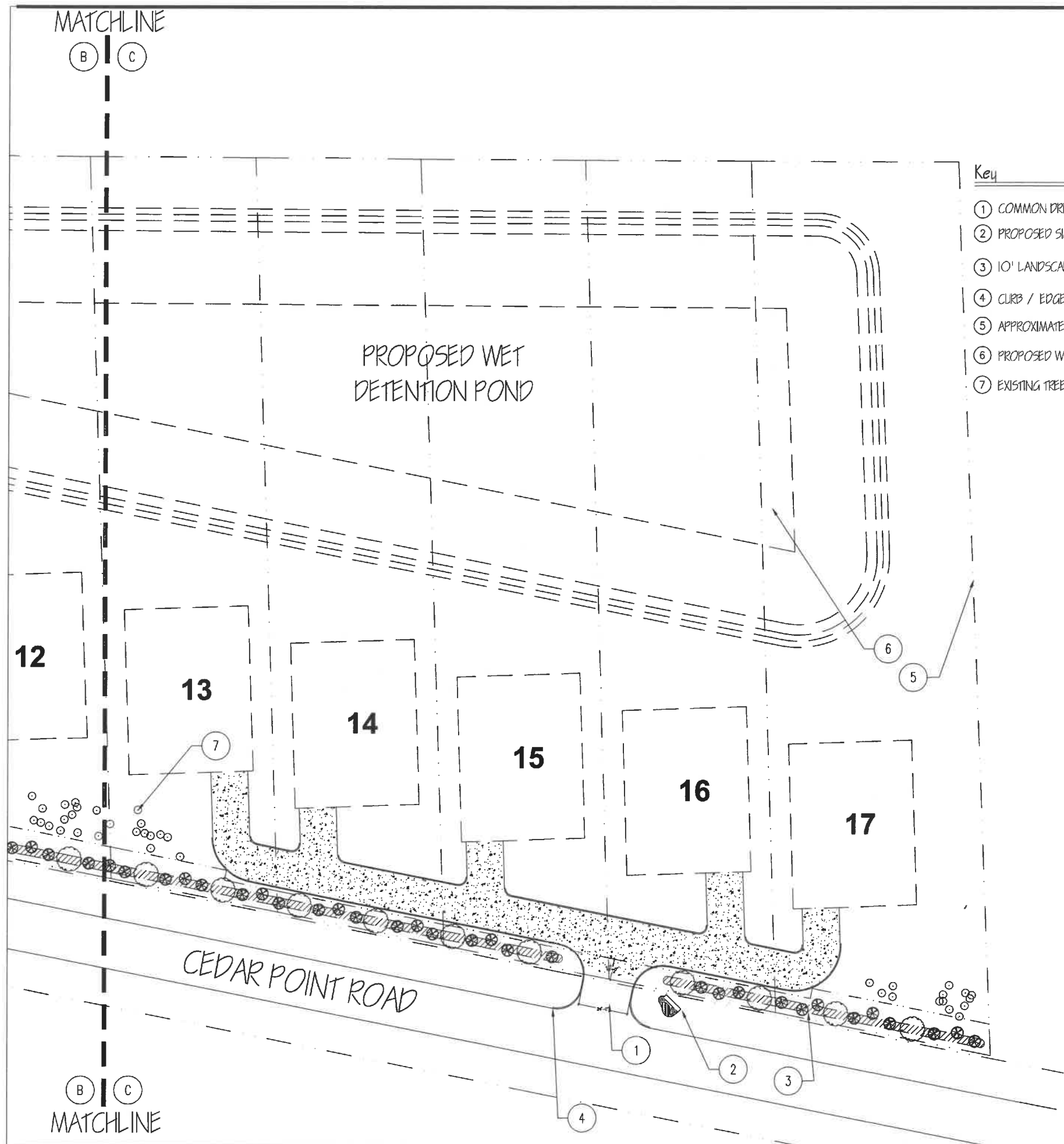

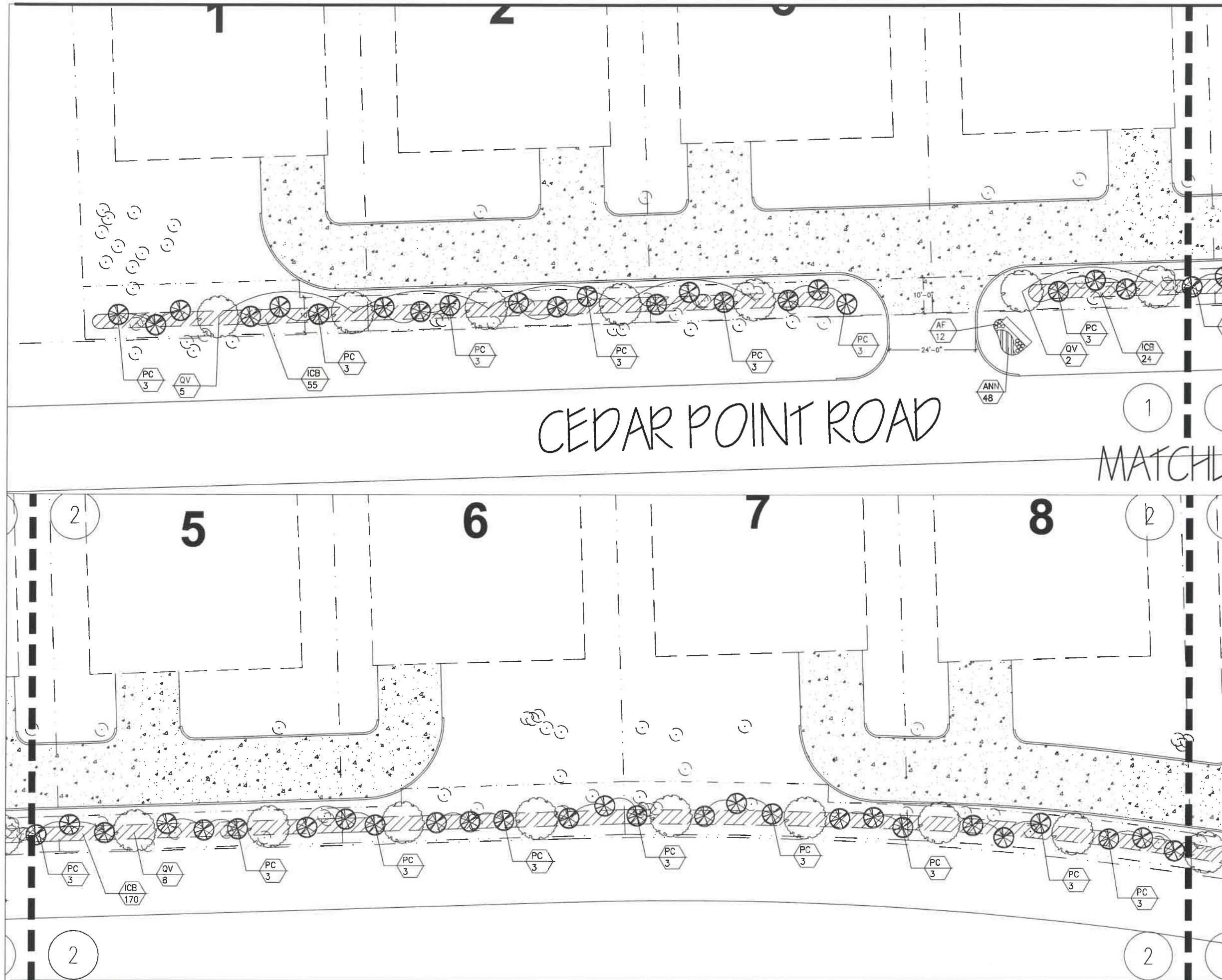

Sheet Notes



VICINITY MAP
NOT TO SCALE

PLAN SET LEGEND

- LA-01 EXISTING SURVEY & MASTER PLAN LAYOUT
- LA-02 MASTER PLAN LAYOUT M-LINE A-A
- LA-03 MASTER PLAN LAYOUT M-LINE B-B
- LA-04 MASTER PLAN LAYOUT M-LINE C-C
- LA-05 MASTER PLANTING PLAN M-LINE 1-1 & 2-2
- LA-06 MASTER PLANTING PLAN M-LINE 3-3 & 4-4
- LA-07 MASTER PLANTING PLAN M-LINE 5-5
- LD-01 LANDSCAPE DETAILS
- LD-02 LANDSCAPE DETAILS

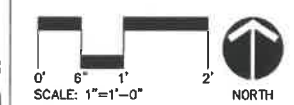

THESE DOCUMENTS AND THEIR CONTENTS ARE THE PROPERTY OF THE OWNER, AND ARE ISSUED ONLY FOR THE SPECIFIC PROJECT NOTED ON THESE DRAWINGS. ANY REPRODUCTION OR REDISTRIBUTION WITHOUT THE EXPRESSED WRITTEN CONSENT OF THE OWNER IS PROHIBITED BY LAW.

CHARLOTTE'S POINT
DUVAL COUNTY
Jacksonville, Florida 32218

© 2020 CEDAR BAY STUDIOS

DATE: 6-10-21
BY: [Signature]

project number
MASTER PLANTING PLAN

sheet number
LA-05

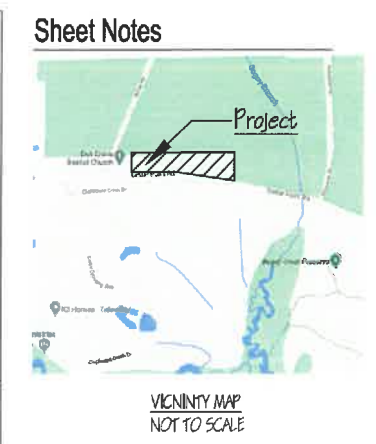
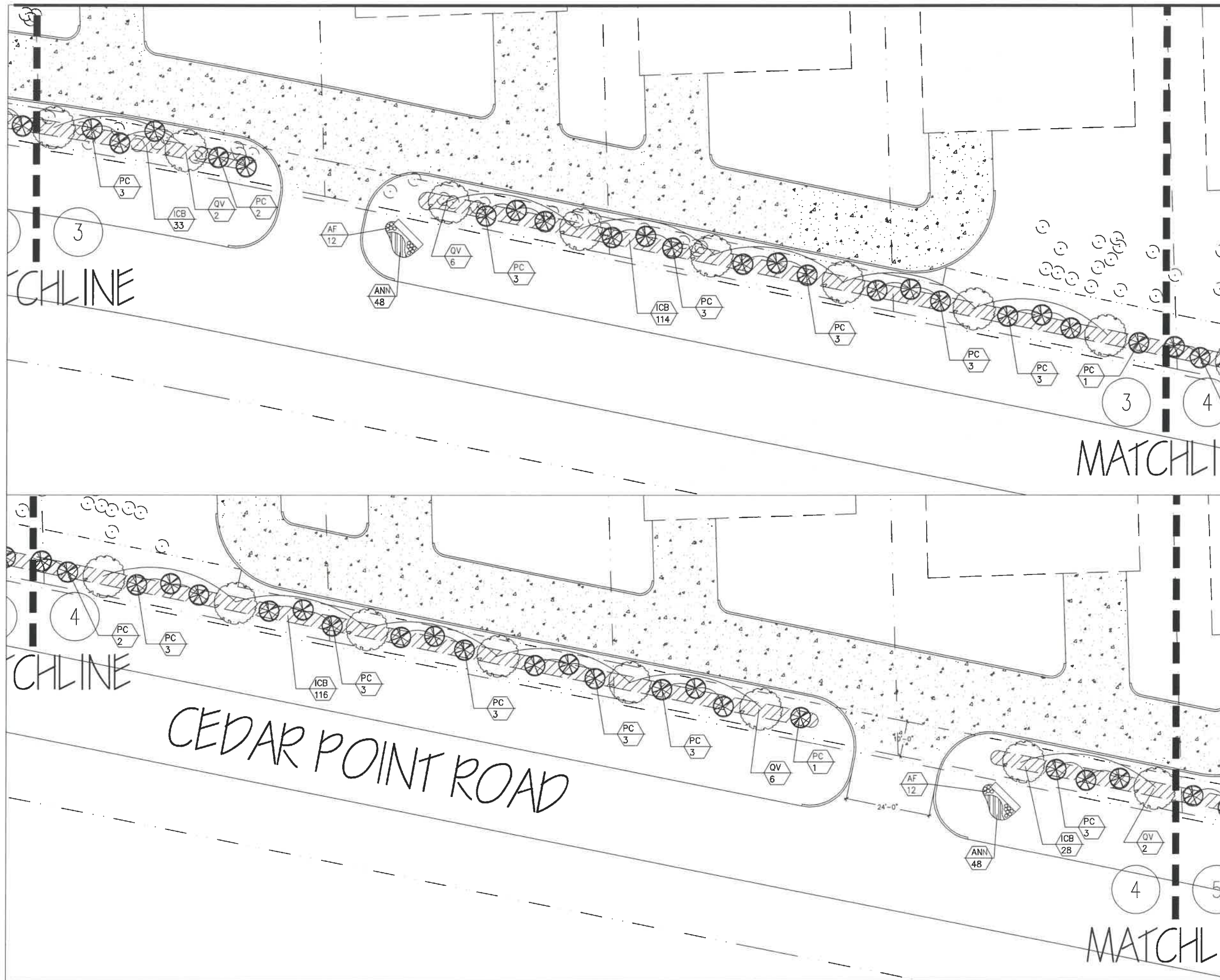

- PLAN SET LEGEND**
- LA-01 EXISTING SURVEY & MASTER PLAN LAYOUT
 - LA-02 MASTER PLAN LAYOUT M-LINE A-A
 - LA-03 MASTER PLAN LAYOUT M-LINE B-B
 - LA-04 MASTER PLAN LAYOUT M-LINE C-C
 - LA-05 MASTER PLANTING PLAN M-LINE 1-1 & 2-2
 - LA-06 MASTER PLANTING PLAN M-LINE 3-3 & 4-4
 - LA-07 MASTER PLANTING PLAN M-LINE 5-5
 - LD-01 LANDSCAPE DETAILS
 - LD-02 LANDSCAPE DETAILS

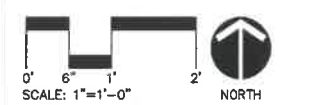

THESE DOCUMENTS AND THEIR CONTENTS ARE THE PROPERTY OF THE OWNER, AND ARE ISSUED ONLY FOR THE SPECIFIC PROJECT NOTED ON THESE DRAWINGS. ANY REPRODUCTION OR REDISTRIBUTION WITHOUT THE EXPRESSED WRITTEN CONSENT OF THE OWNER IS PROHIBITED BY LAW.

CHARLOTTE'S POINT
 DUVAL COUNTY
 Jacksonville, Florida 32218

© 2020 CEDAR BAY STUDIOS

DATE: 10-10-24	BY: [Signature]
PROJECT NUMBER	

MASTER PLANTING PLAN

sheet number
LA-06

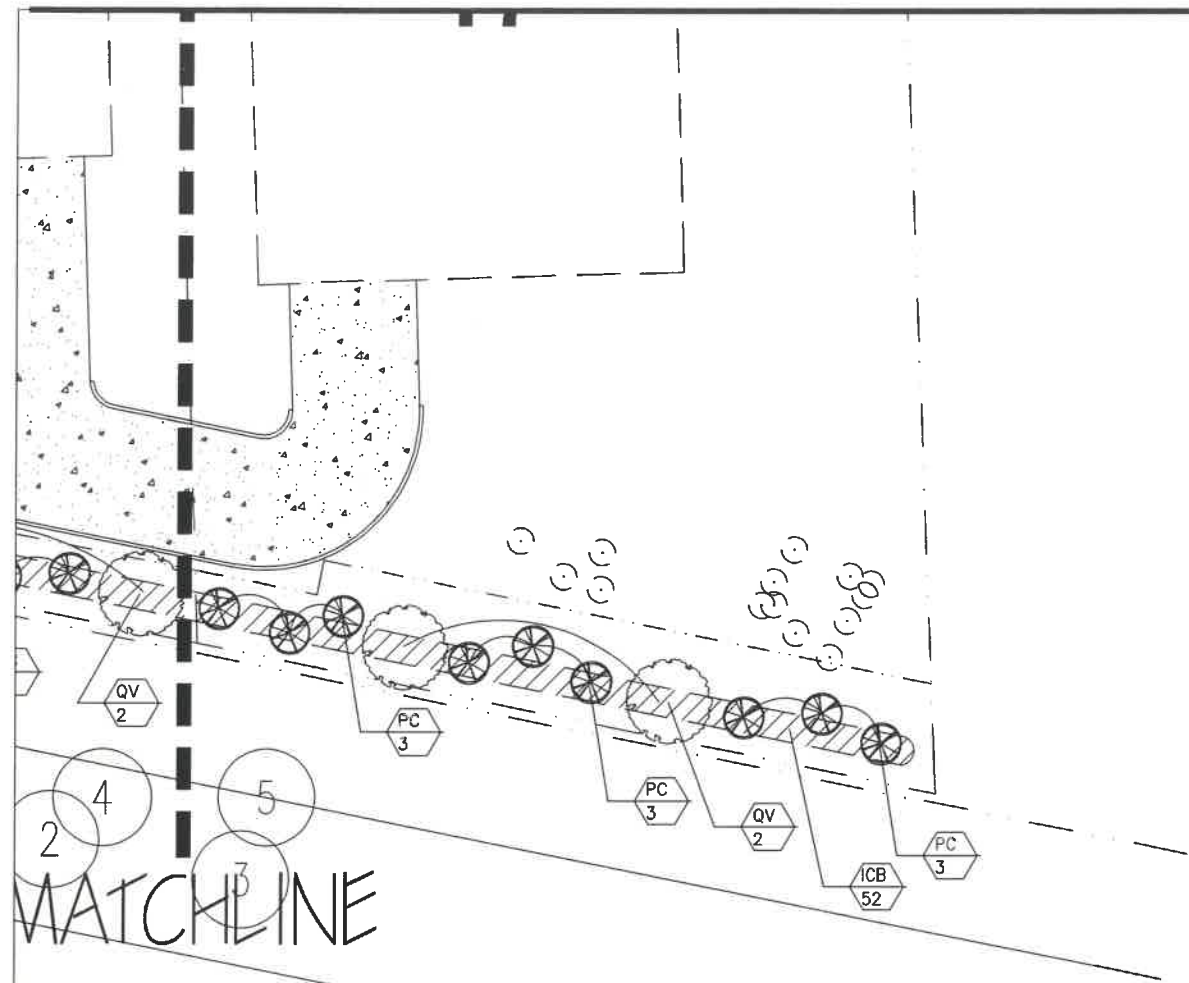

Sheet Notes



VICINITY MAP
NOT TO SCALE

PLAN SET LEGEND

- LA-01 EXISTING SURVEY & MASTER PLAN LAYOUT
- LA-02 MASTER PLAN LAYOUT M-LINE A-A
- LA-03 MASTER PLAN LAYOUT M-LINE B-B
- LA-04 MASTER PLAN LAYOUT M-LINE C-C
- LA-05 MASTER PLANTING PLAN M-LINE 1-1 & 2-2
- LA-06 MASTER PLANTING PLAN M-LINE 3-3 & 4-4
- LA-07 MASTER PLANTING PLAN M-LINE 5-5
- LD-01 LANDSCAPE DETAILS
- LD-02 LANDSCAPE DETAILS

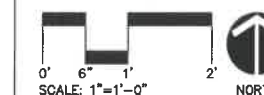

SCALE: 1"=1'-0"
NORTH

CHARLOTTE'S POINT
DUVAL COUNTY
Jacksonville, Florida 32218

© 2020 CEDAR BAY STUDIOS

: EMS date: EMS
6-10-21 date: 4/26/2021

6-10-21

project number

MASTER PLANTING
PLAN

sheet number

LA-07