



If we were to relocate  
structure to meet  
setback requirements  
sign would obstruct  
access to pumps

Google



**SITE PLAN**

20283647  
20283648  
20283650

**KEEP THIS PLAN ON JOB  
CODE REVIEWED FOR  
REGNS PLANS EXAMINER**

**DOES NOT RELIEVE CONTRACTOR OF  
BUILDING INSPECTION DIV. - JAN. 11  
CITY OF JACKSONVILLE**

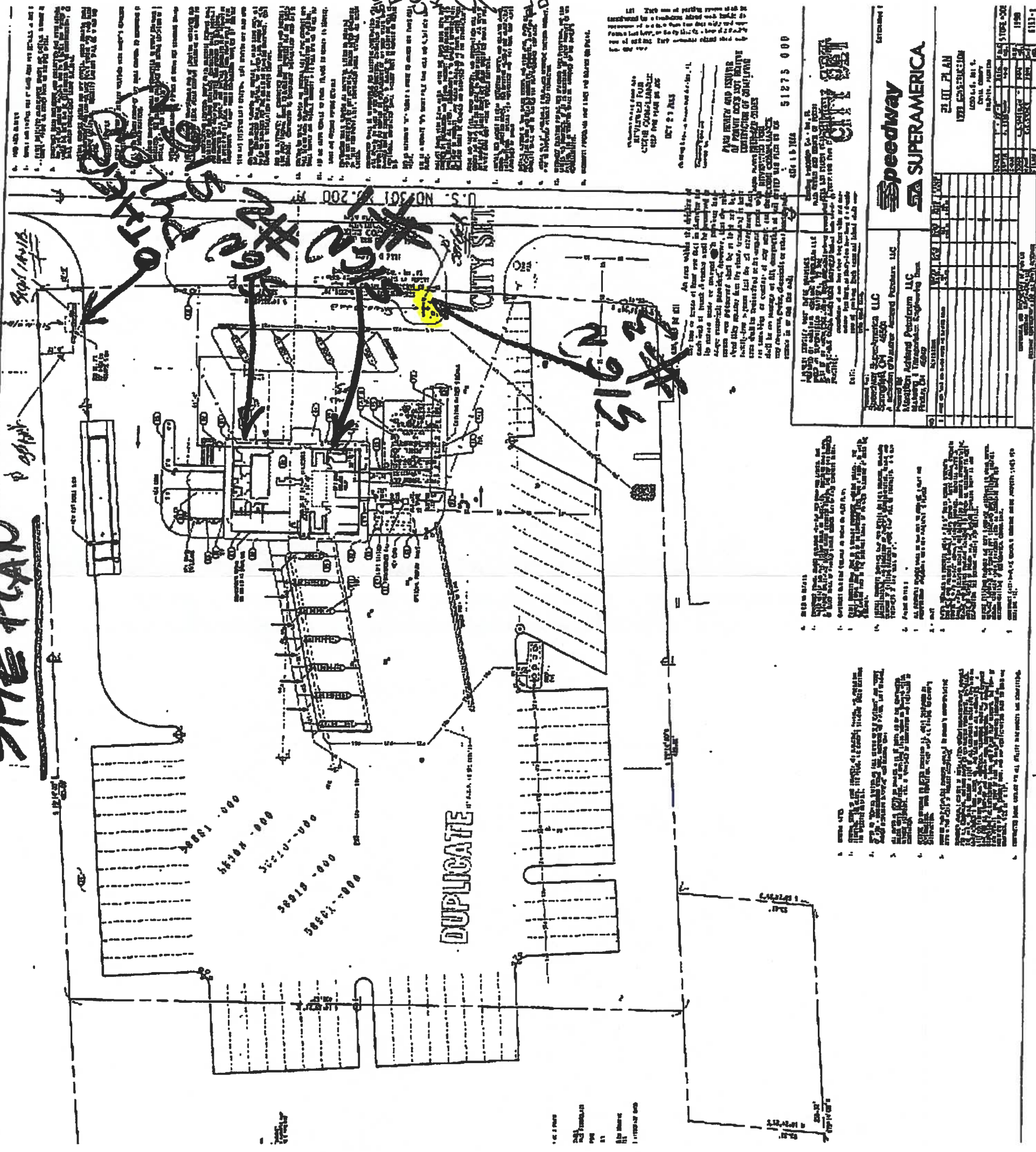

**Speedway SUPERAMERICA**

2000 PLAZA  
1000 S.W. 1st St.  
Jacksonville, Florida 32202

51275 000

**PERMIT REVIEW AND ISSUANCE**

CONTRACTOR'S NAME: [Redacted]  
PROJECT ADDRESS: [Redacted]

**NOTICE TO CONTRACTOR**

THIS PERMIT IS VALID FOR THE CONSTRUCTION OF THE PROJECT DESCRIBED HEREIN. THE CONTRACTOR SHALL BE RESPONSIBLE FOR OBTAINING ALL NECESSARY PERMITS FROM THE APPLICABLE AGENCIES AND FOR COMPLYING WITH ALL APPLICABLE CODES AND REGULATIONS. THE CONTRACTOR SHALL MAINTAIN ACCESS TO ALL ADJACENT PROPERTIES AND UTILITIES AT ALL TIMES. THE CONTRACTOR SHALL BE RESPONSIBLE FOR PROTECTING ALL EXISTING UTILITIES AND STRUCTURES. THE CONTRACTOR SHALL MAINTAIN ALL NECESSARY RECORDS AND REPORTS TO THE BUILDING INSPECTION DIVISION. THE CONTRACTOR SHALL BE RESPONSIBLE FOR OBTAINING ALL NECESSARY PERMITS FROM THE APPLICABLE AGENCIES AND FOR COMPLYING WITH ALL APPLICABLE CODES AND REGULATIONS.

# MAP SHOWING SPECIFIC PURPOSE SURVEY

OF  
A PORTION OF THE WESTERLY  
RIGHT-OF-WAY LINE OF U.S. No. 301 LOCATED  
IN SECTION 34, TOWNSHIP 2 SOUTH, RANGE 23  
EAST, DUVAL COUNTY, FLORIDA.

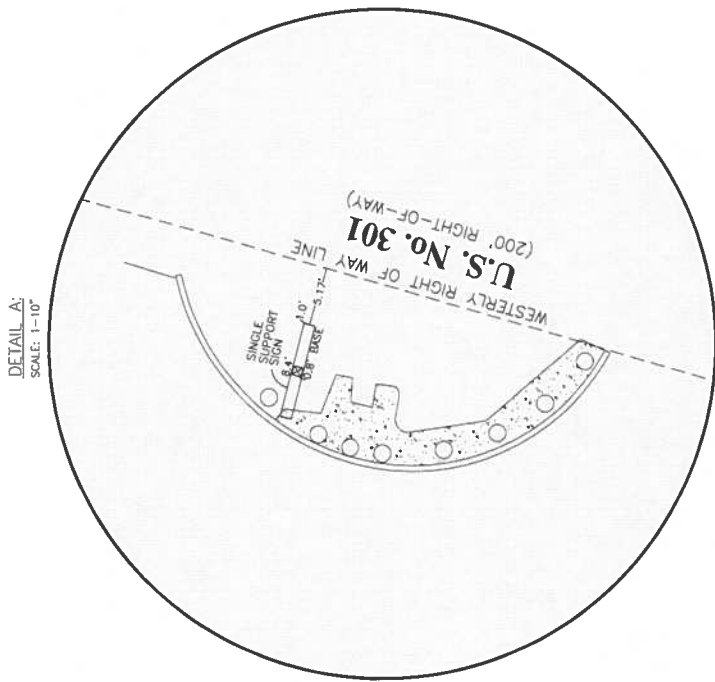

DETAIL A:  
SCALE: 1"=10'

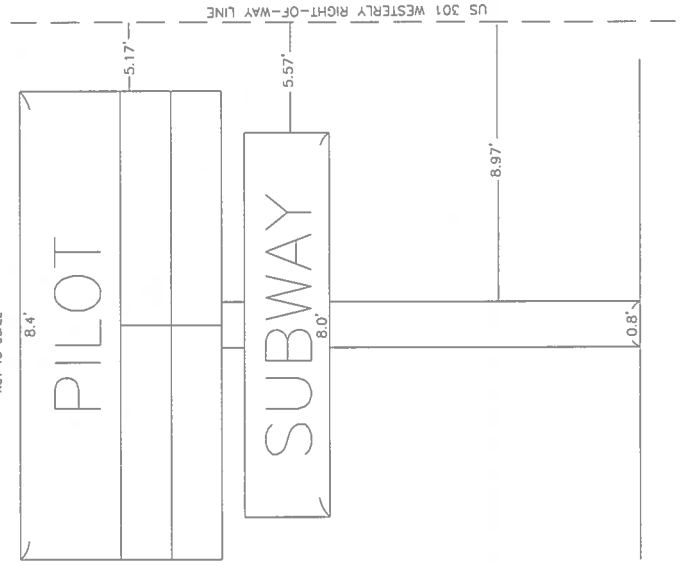

DETAIL B:  
NOT TO SCALE



**LEGEND:**

- = FOUND 1/2" IRON PIPE NO ID UNLESS OTHERWISE NOTED
- = SET 5/8" IRON ROD LB 7944 UNLESS OTHERWISE NOTED
- = FOUND 4"x4" CONCRETE MONUMENT NO ID UNLESS OTHERWISE NOTED
- = SET 4"x4" CONCRETE MONUMENT LB 7944 UNLESS OTHERWISE NOTED
- ⊙ = FOUND PK NAIL NO ID UNLESS OTHERWISE NOTED
- Δ = DELTA
- R = RADIUS
- APPROXIMATE
- CB = CHORD BEARING
- CD = CHORD DISTANCE
- P.C. = POINT OF CURVE
- P.T. = POINT OF TANGENCY
- P.R.C. = POINT OF REVERSE CURVE
- PC = POINT OF CURVE
- O.R. = OFFICIAL RECORD BOOK
- PG. = PAGE
- ID = IDENTIFICATION
- LB = LICENSED BUSINESS
- NO. = NUMBER
- W.D. = WORK ORDER

**GENERAL NOTES:**

- 1.) THIS SURVEY WAS PREPARED WITHOUT THE BENEFIT OF A TITLE ABSTRACT OR REPORT THEREOF. THERE MAY BE ADDITIONAL MATTERS OF RECORD NOT SHOWN HEREON THAT MAY BE FOUND IN THE CURRENT PUBLIC RECORDS OF CLAY COUNTY, FLORIDA.
- 2.) UNDERGROUND IMPROVEMENTS SUCH AS FOUNDATIONS AND UTILITIES WERE NOT LOCATED.
- 3.) A BEARING OF S 18°55'22" W WAS ASSUMED ON THE WESTERLY RIGHT-OF-WAY LINE OF US 301.
- 4.) THE SPECIFIC PURPOSE OF THIS SURVEY IS TO SHOW THE RELATIONSHIP BETWEEN THE PILOT GAS STATION SIGN (STORE #87) AND THE RIGHT OF WAY OF US 301.
- 5.) THIS IS A SPECIFIC PURPOSE SURVEY ONLY AND DOES NOT PURPORT TO BE A BOUNDARY SURVEY.

DONALD M. JOHNSON, JR.  
FLORIDA REGISTERED LAND SURVEYOR NO. 5613  
NOT VALID WITHOUT THE SIGNATURE AND THE ORIGINAL RAISED SEAL OF A FLORIDA LICENSED SURVEYOR AND MAPPER



JOHNSON SURVEYING & MAPPING, INC.  
10250 NORMANDY BLVD. SUITE 604  
JACKSONVILLE, FLORIDA 32221  
LICENSED BUSINESS NO. 7944

PHONE (904) 619-6630  
FAX (904) 619-6786

W.O. NO.: 2021-005	SURVEY DATE: 1-14-2021	DRAFTED BY: L. JOHNSON
CHECKED BY: DMJ	CAD FILE: 2021-005.DWG	FB 45 PG 41-42