

CONCEPT PLAN NOTES:

1. THIS DRAWING IS INTENDED FOR CONCEPTUAL SITE PLANNING ONLY. SITE PLAN IS SUBJECT TO CHANGE BASED UPON FINAL DESIGN AND LOCAL LAND DEVELOPMENT CODE.
2. STORMWATER MANAGEMENT FACILITY SHOWN ON THIS PLAN ARE CONCEPTUAL ONLY AND IS SUBJECT TO CHANGE UPON FINAL DESIGN.
3. NO SITE VISITS HAVE BEEN MADE TO VERIFY ACCURACY OF AERIAL IMAGE DEPICTED.
4. THIS DRAWING IS NOT INTENDED TO BE USED FOR CONSTRUCTION AND PERMITTING PURPOSES.

100'

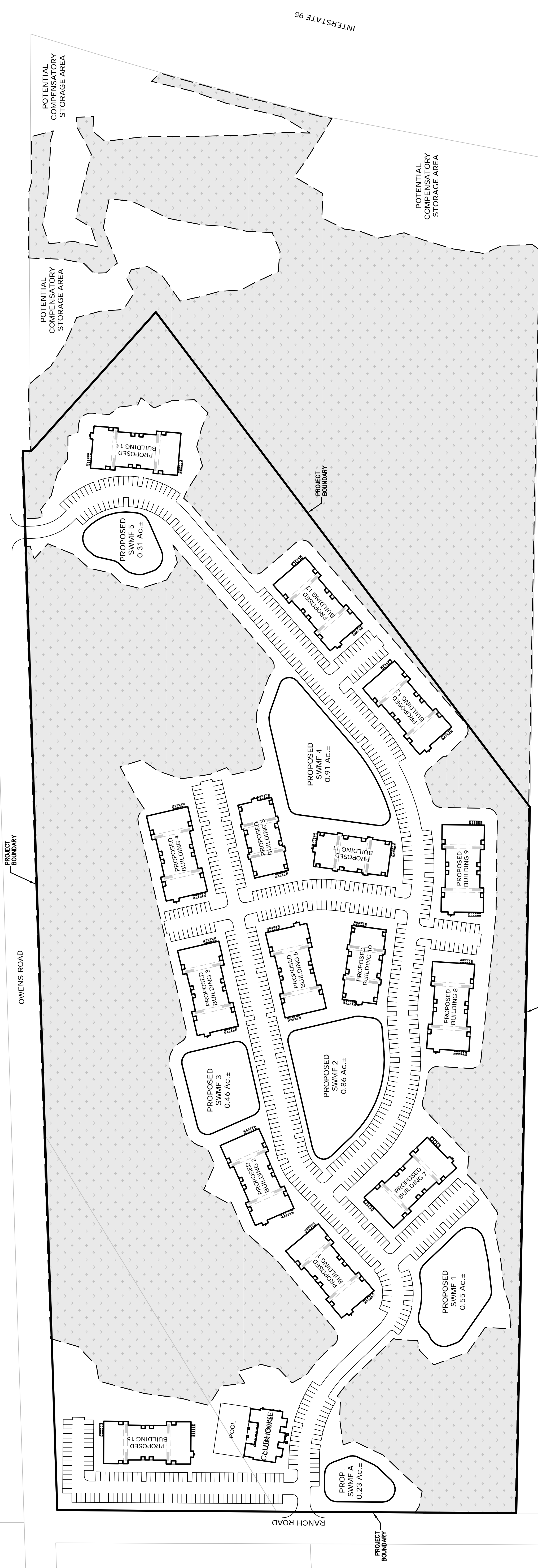

| SITE DATA TABLE | |
|-----------------------------|--------------------------------|
| JURISDICTION: | CITY OF JACKSONVILLE |
| SITE AREA: | 42.75 AC |
| RESIDENTIAL DEVELOPED AREA: | 23.14 AC± |
| RESIDENTIAL WETLAND IMPACT: | 8.46 AC± |
| RESIDENTIAL TOTAL SWMF: | 2.85 AC± (12.5% OF DEVELOP) |
| APARTMENT UNITS: | 360 |
| PARKING REQUIRED: | 1.50 SPACES PER UNIT = 540 |
| PARKING PROVIDED: | 796 SPACES, NOT INCL. HANDICAP |

CONCEPT PLAN
OWENS ROAD MULT-FAMILY
11/18/21

ETM
VISION • EXPERIENCE • RESULTS

England-Thims & Miller, Inc.
 14775 Old St. Augustine Road
 Jacksonville, FL 32259
 TEL: (904) 645-8890
 FAX: (904) 645-9485
 REG - 2584 LC - 0000316