

EMERALD HOMES

- 111 50' LOTS MIN. WIDTH 50'
- 99 60' LOTS MIN. WIDTH 60'
- 17 75' LOTS
- 16 90' LOTS

243 TOTAL LOTS

NOTE: THE PROJECT STANDARD LOT DEPTH IS 120' AND USING ZONING CLASSIFICATION MINIMUM AREA SF, THE PROJECT HAS:

- 8 LOTS > 14,000SF RLD-100B
- 24 LOTS > 9,900 SF RLD-90
- 17 LOTS > 8,800 SF RLD-80
- 98 LOTS > 7,200 SF RLD-70
- 96 LOTS > 6,000 SF RLD-60

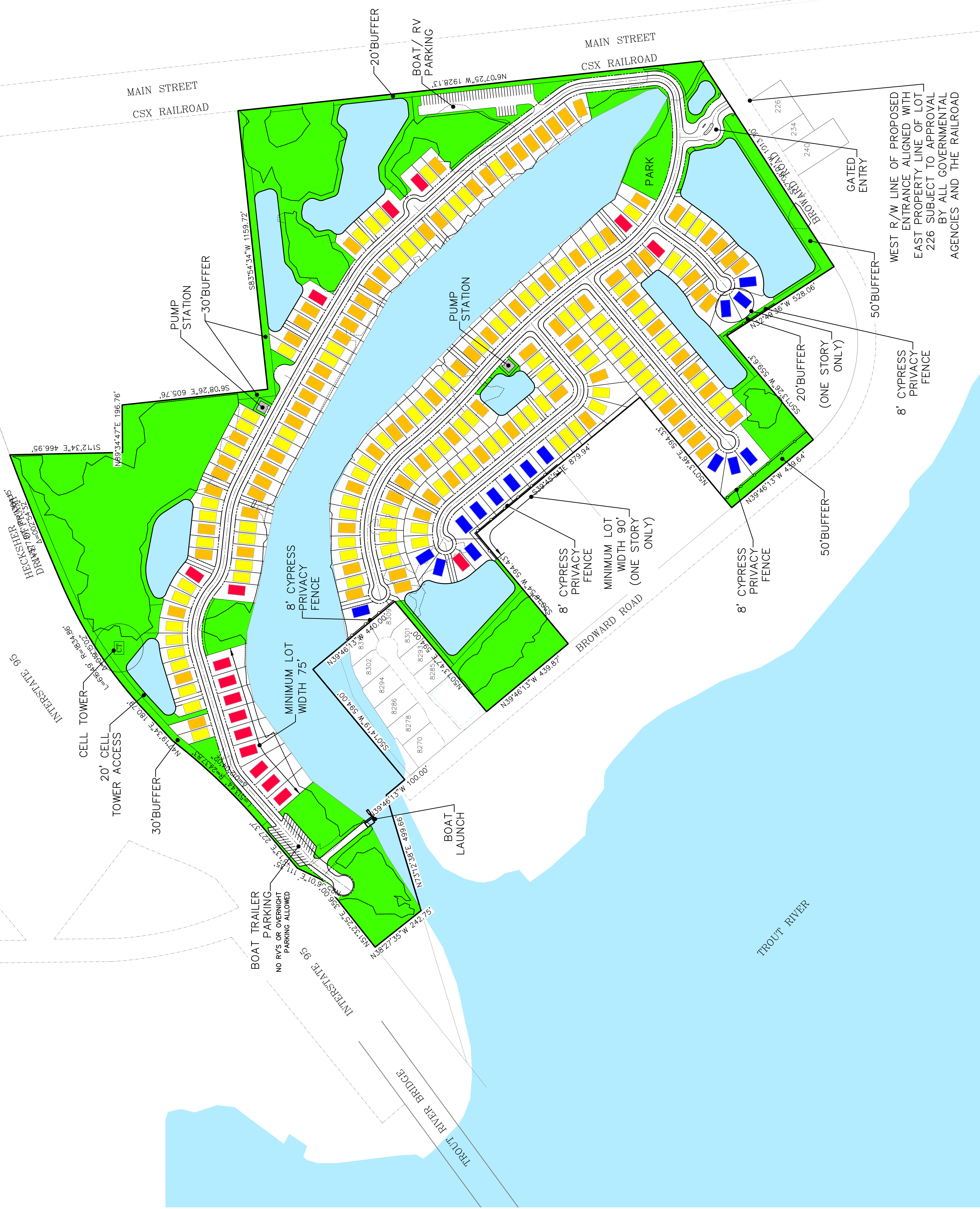

Sheet No. 1 of 1
SP-1
 DWG. NO.

VINCENT J. DUNN ENGINEER NO. 98462
 DAVID M. TAYLOR ENGINEER NO. 44164
 GLEN R. WIEGGER ENGINEER NO. 84149
 CERTIFICATE OF AUTHORIZATION NO. 52189

BROWARD KEY
 FOR:
D.R. HORTON, INC - JACKSONVILLE
 DUVAL COUNTY, FLORIDA
PRELIMINARY SITE PLAN

Dunn & Associates, Inc.
 CIVIL ENGINEERS / LAND PLANNERS
 8647 Boypine Road, Suite 200
 Jacksonville, Florida 32256
 Phone: (904)363-8916 Fax: (904)363-8917
 www.dunneng.com

DESIGNED BY:	MR
DRAWN BY:	MR
CHECKED BY:	VJD
SCALE:	1" = 200'
DATE:	September 3, 2021
PROJ. NO.:	0020-47

NO.	DATE	REVISIONS DESCRIPTION	BY:

P:\2009-500 BROWARD KEY\EXHIBITS\BROWARD KEY MARKETING MAP\DWG9/3/2021 3:03 PMMike Reilly