

- NOTE:**
1. PUD to PUD rezoning required.
 2. Assumed Master Storm Water

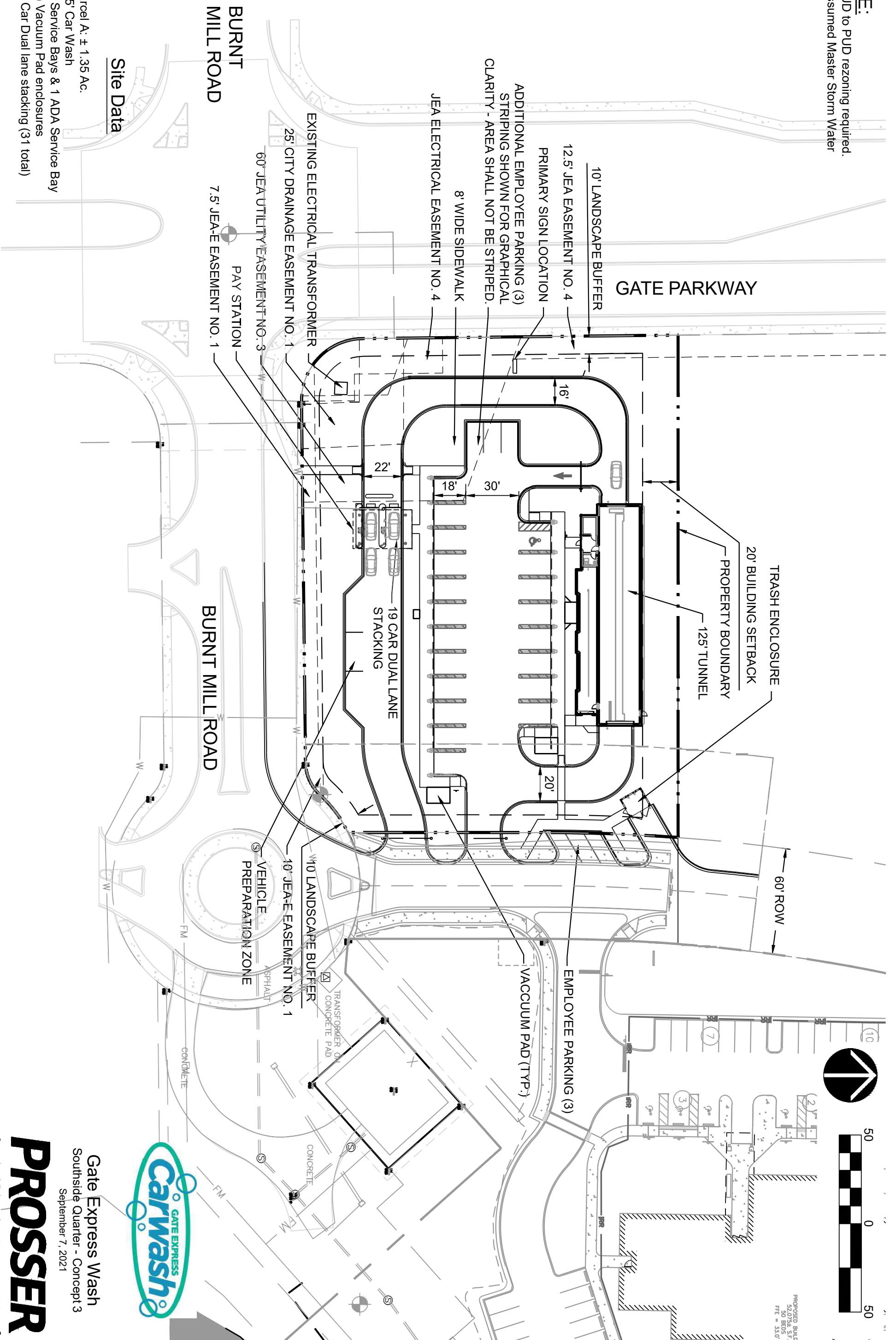

Site Data

- Parcel A: ± 1.35 Ac.
- 125' Car Wash
- 19 Service Bays & 1 ADA Service Bay
- (2) Vacuum Pad enclosures
- 19 Car Dual lane stacking (31 total)

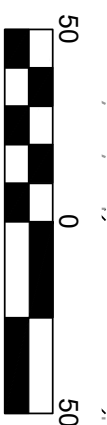

PROPOSED BUILD
52,075.57 SF
FTE = 33.07



Gate Express Wash
Southside Quarter - Concept 3
September 7, 2021

PROSSER
Creative Visionaries. Engineering Minds®