

# L-6018-25A Sign Posting Plan

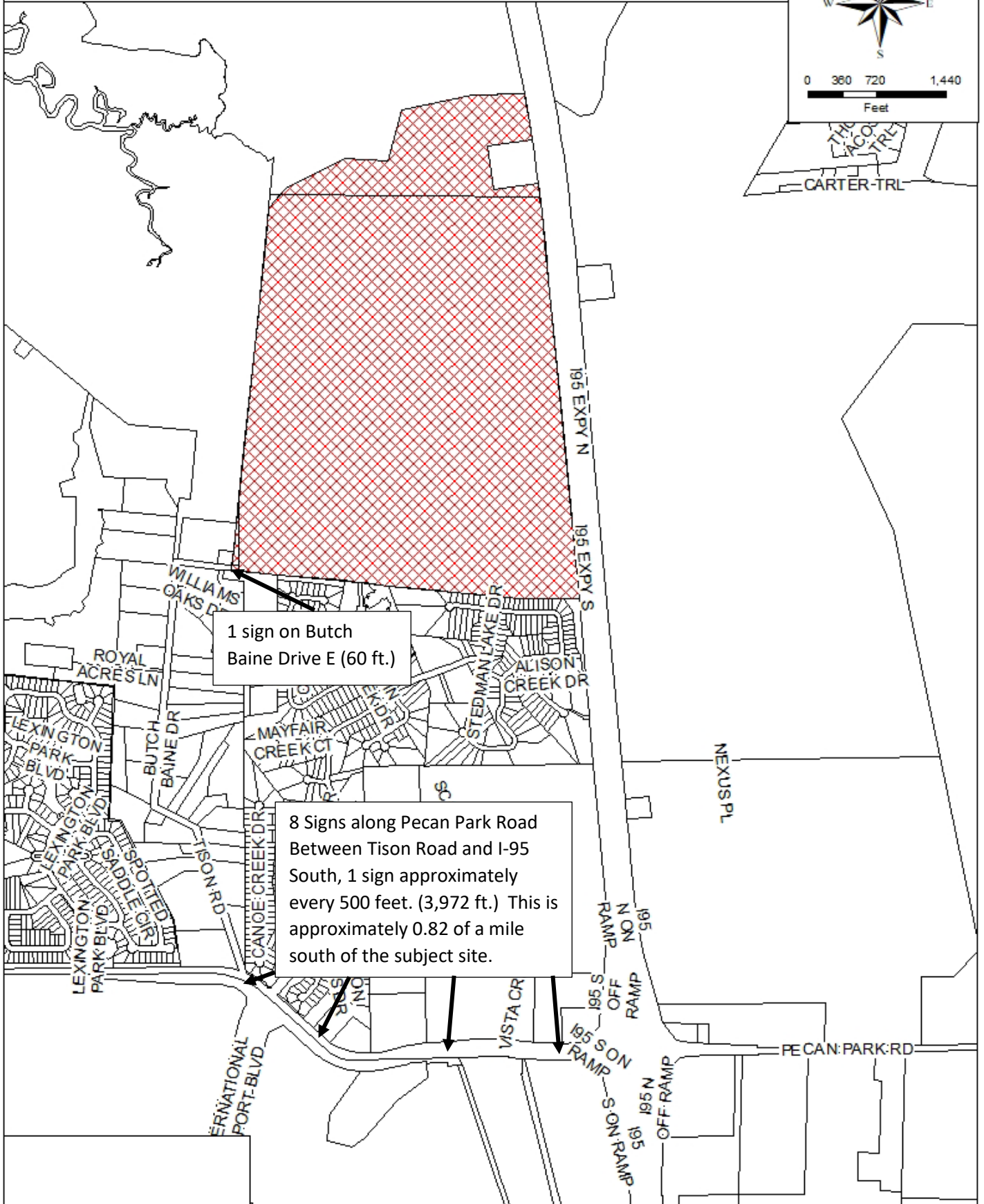

0 360 720 1,440  
Feet



1 sign on Butch Baine Drive E (60 ft.)

8 Signs along Pecan Park Road Between Tison Road and I-95 South, 1 sign approximately every 500 feet. (3,972 ft.) This is approximately 0.82 of a mile south of the subject site.