

CDN: 5850.2
RCV: 9/5/2016 9:45



SITE DATA

PROMISE LAND BAPTIST CHURCH
ENGINEER: MEANS ENGINEERING, INC
ARCHITECT: THORNDORP ASSOCIATES, INC
SURVEYOR: ASSOCIATED SURVEYORS, INC

PROJECT AREA: 4.21 AC (8.44 ACES OWNED)
PROJECT ADDRESS: 2197 BLAIR ROAD (OLD ADDRESS)
PROPERTY ID NO: 080809-010-00
FLOOD ZONE: F (MAP NO. 12031 COA104)

WATER/SEWER: SA
ELECTRICAL: EA

EXISTING ZONING
EXISTING: PR-100-40
EXISTING: PL-100-40
EXISTING: PL-100-40

REQUIRED ZONING
REQUIRED: PL-100-40
REQUIRED: PL-100-40
REQUIRED: PL-100-40

REQUIRED PARKING
1 SPACE PER 35 SF AVIATORIUM
OR SPACE PER 35 SF SEATING (WHICHEVER IS GREATER)
MAXIMUM AVIATORIUM SEATING: 487 (183 SPACES REQUIRED)

EXISTING 2197 BLAIR ROAD
EXISTING 1218 S.C. SPACES: 115
EXISTING 1218 S.C. SPACES: 115
EXISTING 1218 S.C. SPACES: 115

EXISTING 2197 BLAIR ROAD
EXISTING 1218 S.C. SPACES: 115
EXISTING 1218 S.C. SPACES: 115
EXISTING 1218 S.C. SPACES: 115

EXISTING 2197 BLAIR ROAD
EXISTING 1218 S.C. SPACES: 115
EXISTING 1218 S.C. SPACES: 115
EXISTING 1218 S.C. SPACES: 115

EXISTING 2197 BLAIR ROAD
EXISTING 1218 S.C. SPACES: 115
EXISTING 1218 S.C. SPACES: 115
EXISTING 1218 S.C. SPACES: 115

EXISTING 2197 BLAIR ROAD
EXISTING 1218 S.C. SPACES: 115
EXISTING 1218 S.C. SPACES: 115
EXISTING 1218 S.C. SPACES: 115

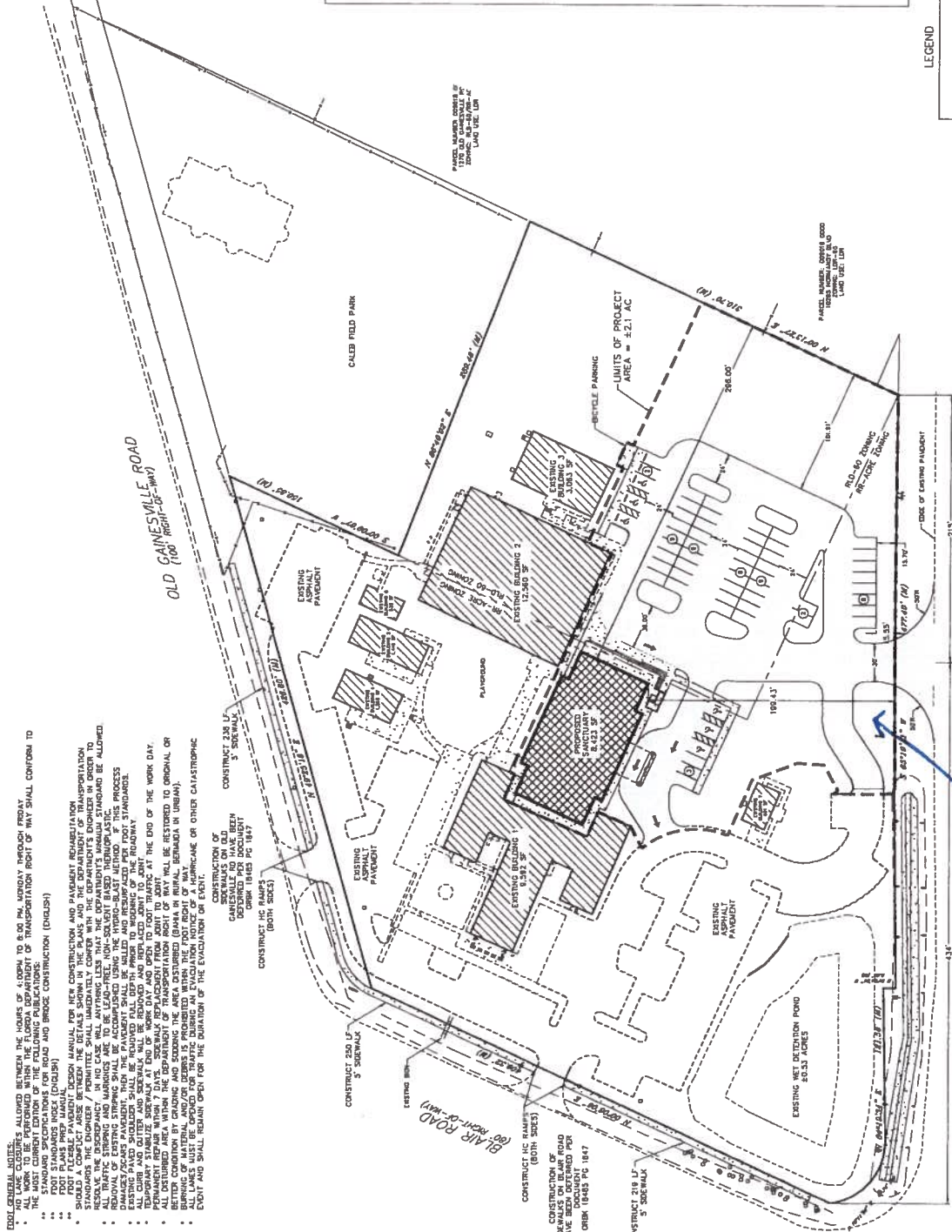
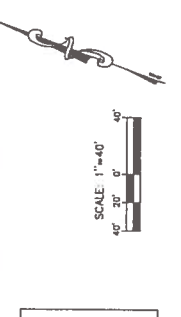

LEGEND

[Symbol]	CONCRETE
[Symbol]	ASPHALT PAVING
[Symbol]	EXISTING BUILDING
[Symbol]	PROPOSED BUILDING

Weldt Earl Meens, Professional Engineer, License No. 31386
This item has been digitally signed and sealed by Weldt Earl Meens, P.E. on September 4, 2016 using a digital signature.
Printer copies of this document are not considered signed and any authorization code must be verified on any electronic copies.

- FOOT GENERAL NOTES:**
- NO WORK ALLOWED BETWEEN THE HOURS OF 4:00 PM TO 8:00 PM, MONDAY THROUGH FRIDAY.
 - ALL WORK SHALL BE DONE IN ACCORDANCE WITH THE DEPARTMENT'S STANDARD SPECIFICATIONS FOR ROAD AND BRIDGE CONSTRUCTION (ENGLISH).
 - STANDARD SPECIFICATIONS FOR ROAD AND BRIDGE CONSTRUCTION (ENGLISH)
 - FOOT PLANS MUST MAINTAIN 10' CLEARANCE.
 - FOOT FLEXIBLE PAVEMENT DESIGN MANUAL FOR NEW CONSTRUCTION AND PAVEMENT REHABILITATION STANDARDS THE ENGINEER / PERMITTEE SHALL IMMEDIATELY CONFER WITH THE DEPARTMENT'S ENGINEER IN ORDER TO DETERMINE THE APPROPRIATE DESIGN AND CONSTRUCTION STANDARDS.
 - ALL TRAFFIC SIGNING AND MARKING SHALL BE INSTALLED IN ACCORDANCE WITH THE DEPARTMENT'S STANDARD SPECIFICATIONS FOR ROAD AND BRIDGE CONSTRUCTION (ENGLISH).
 - REMOVAL OF EXISTING SIGNING SHALL BE ACCOMPLISHED USING THE HYDRO-BLAST METHOD OF THIS PROCESS.
 - EXISTING PAVED SHOULDERS SHALL BE REPAIRED PRIOR TO THE START OF CONSTRUCTION OF THE ROADWAY.
 - ALL CURBS AND GUTTERS SHALL BE REPAIRED AND REPLACED TO MEET THE DEPARTMENT'S STANDARDS.
 - PERMANENT REPAIRS SHALL BE COMPLETED WITHIN 7 DAYS OF THE END OF THE WORK DAY.
 - ALL CURBS AND GUTTERS SHALL BE REPAIRED AND REPLACED TO MEET THE DEPARTMENT'S STANDARDS.
 - BURNING OF MATERIAL AND/OR DEBRIS IS PROHIBITED WITHIN THE FOOT RIGHT OF WAY, REGARDLESS OF WEATHER CONDITION BY CHAINING AND STAKING THE AREA DURING, (OR) IN THE VICINITY OF, THE PROJECT.
 - EVENT AND SHALL REMAIN OPEN FOR THE DURATION OF THE EVACUATION OR EVENT.

Proposed Sign

8'
7' 7" LED

PROMISE LAND
BAPTIST CHURCH
— Real People - Real Stories - Real God —

2' 6"

3"

3' 5"

12' 2"

6'

All are
WELCOME

USB Box



6' Man

2' 6"

POLARIS COLOR 16mm 60x140

ID CABINET: 2' 6" x 8'
LED CABINET: 3' 5" x 7' 7"



ORIGINAL DESIGN DO NOT DUPLICATE

PH. 1-800-237-3928 FAX 1-800-485-4280

1/2"=1' Sk: 949951-1 Cust: 1388128
2/12/2020 O/kSavage PROPOSAL

Header Vinyl: DIGITAL PRINT
Paint: ROYAL BLUE Draft: WHITE

GRAPHICS DISCLAIMER: This custom artwork is not intended to provide an exact match for ink, vinyl, paint, or LED color. Brickwork and masonry are not included in the proposal; Cornerstone products are an exception. Measurements shown are approximations; final product dimensions may vary. LED images shown are simulated to replicate optimum viewing distance. Your sign was designed for an illuminated graphic. Sketches are based off of this premise. Non-illumination during daylight hours may result in graphics of varying appearance.

Approved as shown:

Sign _____
Date _____

Approved with listed changes:

Sign _____
Date _____

LED CAPABILITIES: 1 to 7.5 Rows, 4.41" to 37.8" character.
This sign can display video clips, animations and static images, with access to an extensive graphics library.

