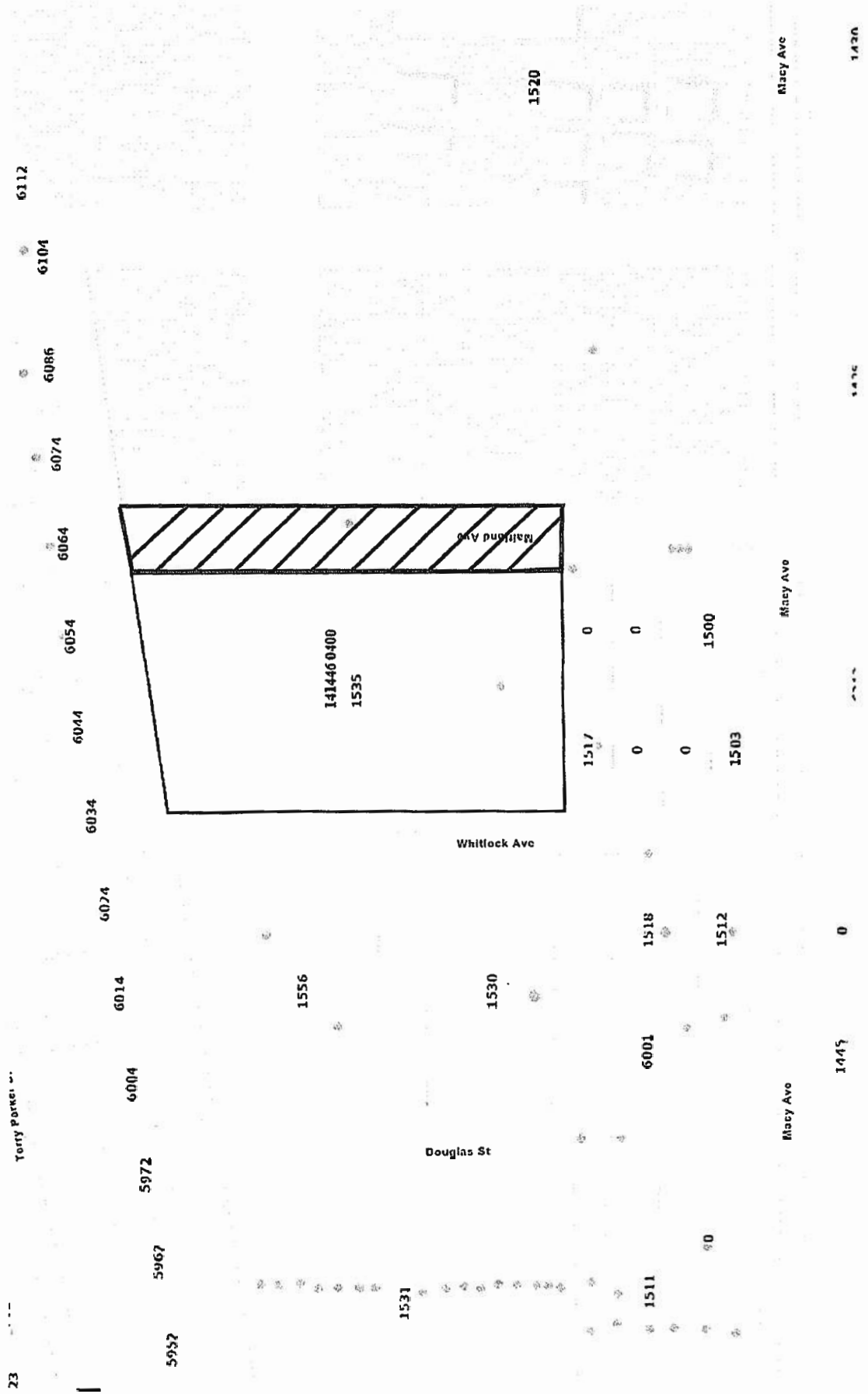

EXHIBIT 1

Maitland Ave. Closure

RE 141446 0400

Location Map



Aerial Map



GRAPHIC SCALE

0 40



(IN FEET)

1 inch = 40 ft

CONCRETE LANDS BEING BUILT 30-40 FT. MORE OR LESS ON 147± ACRES.

GENERAL NOTES

1. THIS MAP IS A BOUNDARY SURVEY.
2. THIS SURVEY MAP DOES NOT REFLECT OWEHNSHIP.
3. UNDERGROUND PORTION OF FOUNDATION/FOOTER NOT LOCATED
4. THERE MAY BE UNDERGROUND UTILITIES NOT SHOWN ON THIS SURVEY.
5. UNLESS OTHERWISE NOTED, RECORD AND MEASURED DIMENSIONS AGREE.
6. THE MEASURED LINEAR DISTANCE ACCURACY FOR THIS SURVEY EXCEEDS 1/10,000.
7. ALL MEASUREMENTS ARE IN U.S. STANDARD FEET AND INCHES WITH A THEODOLITE AND ELECTRONIC DISTANCE MEASURING DEVICE AND NOT BY TIE.
8. THE THICKNESS OF THE BUILDING SHOWN HEREON DO NOT REFLECT EAVE OVERHANG, IF ANY.
9. ALL BUILDING TIES ARE PERPENDICULAR TO THE PROPERTY LINES, UNLESS INDICATED OTHERWISE.
10. THIS SURVEY MAP AND/OR SURVEY REPORT AND THE COMES THEREOF ARE NOT VALID WITHOUT THE SIGNATURE OF A LICENSED SURVEYOR AND MAPPER AND THE ORIGINAL INSTRUMENT.
11. NO THIS CONVEYOR OR INSTRUMENT OF MATTERS AFFECTING TITLE OR BOUNDARY TO THE SAID PROPERTY SHALL BE VALID UNLESS THE SAME BE FIRST RECORDED IN THE PUBLIC RECORDS OF THE COUNTY OF CLATSOP, OREGON.
12. UNLESS OTHERWISE NOTED, ALL EASEMENTS OR OTHER INSTRUMENTS HEREON COULD AFFECT THE BOUNDARIES.
13. NOTICE OF LIABILITY: THIS SURVEY IS CERTIFIED TO THOSE INDIVIDUALS SIGNING ON THE FACE THEREOF, AND OTHERS WHO RELY ON THE SAME, BY ANY OTHER PARTY TO THE SURVEY, AND NOT TO ANY OTHER PARTY. THE SURVEYOR IS NOT RESPONSIBLE TO THOSE OTHER THAN THOSE INDIVIDUALS SIGNING ON THE SURVEY AND HERBY RESTRICTS THE RIGHTS OF ANY OTHER INDIVIDUAL OTHER THAN TO USE THIS SURVEY, WITHOUT THE WRITTEN CONSENT OF SURVEYOR.

CHARLES BASSETT & ASSOCIATES, INC.
SURVEYORS - MAPPERS - LAND PLANNERS

SURVEYORS - MAFFERS - LAND PLANNERS
P.O. BOX 10046 - FLEMING ISLAND, FLORIDA - 32006 - PHONE (904) 215-0707 - FAX (904) 215-0711

I HEREBY CERTIFY THAT THIS _____ SURVEY,
PERFORMED UNDER MY RESPONSIBLE DIRECTION, MEETS THE STANDARDS OF PRACTICE FOR LAND SURVEYORS IN ACCORDANCE WITH CHAPTER 201, F.S.,
ADMINISTRATIVE CODE (PURSUANT TO SECTION 472.037, FLORIDA STATUTES.)

SURVEYED _____ **DECEMBER 17, 2024**

BEARING DATUM BASED ON _____ ARLINGTON HEIGHTS, AS ACCORDING TO THE PLAT THEREOF RECORDED IN PLAT BOOK 4, PAGE 19

FIELD BOOK NO. N/A PAGE(S) N/A
COMPUTER FILE NAME 112404 WHITLOCK AVE.dwg
LEGAL N/A
SCALE 1" = 40'
WORK ORDER NO: 11-24-04
FILE NO S-7024

Exhibit 1
Page 3 of 3