

PROJECT SUMMARY

THE EXISTING SITE IS UNDEVELOPED. THE PROPOSED USE IS MULTIFAMILY RESIDENTIAL 4-UNIT VILLAS, STORMWATER MANAGEMENT WILL BE PROVIDED WITHIN ON-SITE DETENTION AREAS.

PARCEL NO. 001774-0000
 TOTAL PHASES ONE (1)
 TOTAL SITE AREA (ACRES) 4.35
 TOTAL LOTS 16

TOTAL DWELLING UNITS 64 UNITS
 DENSITY (UNITS/ACRE) 14.7
 100-YR FLOODPLAIN ZONE X

EXISTING/REQ'D	PROPOSED
CSC	MDR
CO	PUD
MIN. LOT SIZE (SF)	5,100
MIN. LOT WIDTH (FT)	60
LOT COVERAGE	50%
BUILDING IMP. SURFACE	75%
SETBACKS (FEET)	
FRONT	15
SIDE	10
REAR	20
MAX. HEIGHT (FEET)	35
PARKING	133

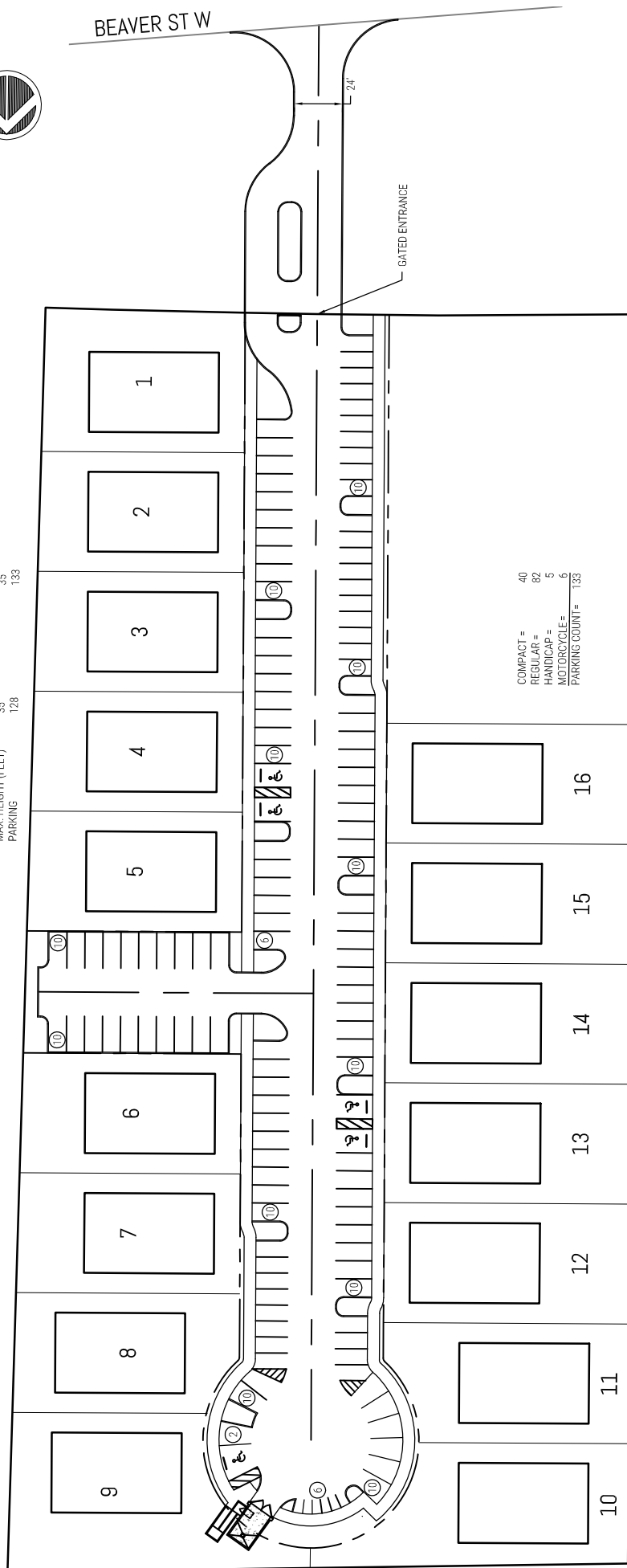

COMPACT = 40
 REGULAR = 82
 HANDICAP = 5
 MOTORCYCLE = 6
 PARKING COUNT = 133



HALSEMA VILLAS
 BEAVER ST W
 JACKSONVILLE, FL

PROJECT INFORMATION
 ENGINEER: GERALD JERRY PIONESSA, JR., PE
 JMJ GROUP, LLC
 5711 RICHARD ST., STE 4
 JACKSONVILLE, FL 32216
 (229) 516-0977
 OWNER: CREW LOIS BARKOSKIE FAMILY TRUST
 PO BOX 37172
 TALLAHASSEE, FL 32315-7172
 DEVELOPER: DANIEL BLANCHARD
 SOUTHERN IMPRESSION DEVELOPMENT LLC
 5711 RICHARD ST., STE 4
 JACKSONVILLE, FL 32216
 (904) 237-7781



ENGINEERING | CONSULTING | PLANNING
 5711 RICHARD ST., STE 4
 JACKSONVILLE, FL 32216
 (904) 237-7781
 FEDERAL REGISTERED PROFESSIONAL ENGINEER NO. 1605

CONCEPT

JOB NO. 01257 DATE 2-1-22

