

THE MASTER DEVELOPMENT PLAN IS A GENERAL REPRESENTATION OF THE APPROVED PLAN OF DEVELOPMENT AND IS NOT A CONTRACT. THE APPROVED PLAN OF DEVELOPMENT IS THE FINAL AUTHORITY. THIS DEVELOPMENT PLAN IS SUBJECT TO THE PLAN REVIEW PROCESS AND THE PLAN REVIEW BOARD'S REVIEW AND APPROVAL.

DATE: \_\_\_\_\_

REVISION NUMBER: \_\_\_\_\_

FILE NUMBER: \_\_\_\_\_

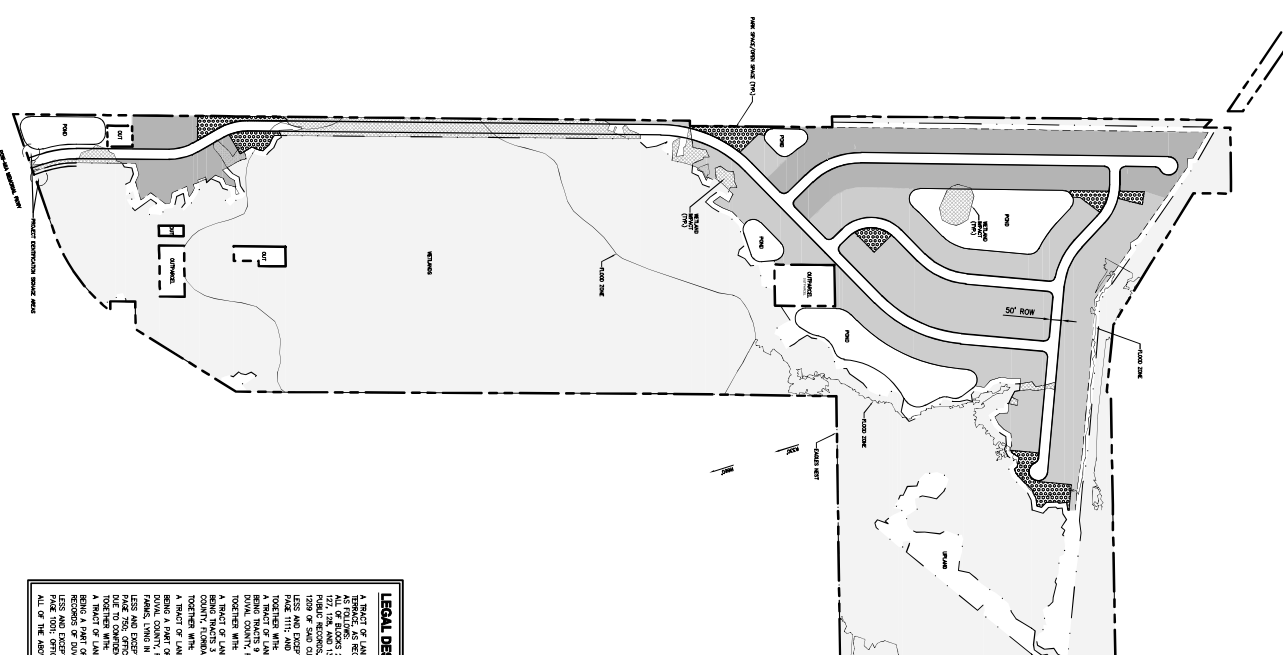

**SITE DATA TABLE**

1. ZONE DESIGNATION	DUVAL COUNTY RESIDENTIAL
2. OFFICIAL RECORDS BOOK AND PAGE	100, PAGE 100
3. SURFACE ELEVATION	AS SHOWN ON THE SURFACE ELEVATION SHEET
4. MAX. LOT COVER	45%
5. MIN. LOT AREA	3,000 SQ. FT.
6. MIN. LOT FRONT SETBACK	10 FEET
7. MIN. LOT SIDE SETBACK	5 FEET
8. MIN. LOT REAR SETBACK	5 FEET
9. MIN. LOT FRONT SETBACK TO FRONT YARD	5 FEET
10. MIN. LOT FRONT SETBACK TO SIDE YARD	5 FEET
11. MIN. LOT FRONT SETBACK TO REAR YARD	5 FEET
12. MIN. LOT FRONT SETBACK TO SIDE YARD	5 FEET
13. MIN. LOT FRONT SETBACK TO REAR YARD	5 FEET
14. MIN. LOT FRONT SETBACK TO SIDE YARD	5 FEET
15. MIN. LOT FRONT SETBACK TO REAR YARD	5 FEET
16. MIN. LOT FRONT SETBACK TO SIDE YARD	5 FEET
17. MIN. LOT FRONT SETBACK TO REAR YARD	5 FEET
18. MIN. LOT FRONT SETBACK TO SIDE YARD	5 FEET
19. MIN. LOT FRONT SETBACK TO REAR YARD	5 FEET
20. MIN. LOT FRONT SETBACK TO SIDE YARD	5 FEET

**LEGEND**

- FOOT BOUNDARY
- PROPERTY BOUNDARY
- WATER PRESERVATION AREA
- WATER MAIN
- SEWER MAIN
- ROAD
- UTILITY

**GENERAL NOTES:**

1. LOT LINES IN CONSTRUCTION SHALL BE SHOWN ON THE CONSTRUCTION DRINKINGS.
2. THE EXISTING ROAD SHALL BE SHOWN ON THE CONSTRUCTION DRINKINGS.
3. THE EXISTING ROAD SHALL BE SHOWN ON THE CONSTRUCTION DRINKINGS.
4. THE EXISTING ROAD SHALL BE SHOWN ON THE CONSTRUCTION DRINKINGS.
5. THE EXISTING ROAD SHALL BE SHOWN ON THE CONSTRUCTION DRINKINGS.
6. THE EXISTING ROAD SHALL BE SHOWN ON THE CONSTRUCTION DRINKINGS.
7. THE EXISTING ROAD SHALL BE SHOWN ON THE CONSTRUCTION DRINKINGS.
8. THE EXISTING ROAD SHALL BE SHOWN ON THE CONSTRUCTION DRINKINGS.
9. THE EXISTING ROAD SHALL BE SHOWN ON THE CONSTRUCTION DRINKINGS.
10. THE EXISTING ROAD SHALL BE SHOWN ON THE CONSTRUCTION DRINKINGS.
11. THE EXISTING ROAD SHALL BE SHOWN ON THE CONSTRUCTION DRINKINGS.
12. THE EXISTING ROAD SHALL BE SHOWN ON THE CONSTRUCTION DRINKINGS.
13. THE EXISTING ROAD SHALL BE SHOWN ON THE CONSTRUCTION DRINKINGS.
14. THE EXISTING ROAD SHALL BE SHOWN ON THE CONSTRUCTION DRINKINGS.
15. THE EXISTING ROAD SHALL BE SHOWN ON THE CONSTRUCTION DRINKINGS.
16. THE EXISTING ROAD SHALL BE SHOWN ON THE CONSTRUCTION DRINKINGS.
17. THE EXISTING ROAD SHALL BE SHOWN ON THE CONSTRUCTION DRINKINGS.
18. THE EXISTING ROAD SHALL BE SHOWN ON THE CONSTRUCTION DRINKINGS.
19. THE EXISTING ROAD SHALL BE SHOWN ON THE CONSTRUCTION DRINKINGS.
20. THE EXISTING ROAD SHALL BE SHOWN ON THE CONSTRUCTION DRINKINGS.

**LEGAL DESCRIPTION**

ALL THE FACILITIES AND UTILITIES OF THE SITE (INCLUDING THE FACILITIES AND UTILITIES SHOWN ON THE CONSTRUCTION DRINKINGS) SHALL BE SHOWN ON THE CONSTRUCTION DRINKINGS.

ALL THE FACILITIES AND UTILITIES OF THE SITE (INCLUDING THE FACILITIES AND UTILITIES SHOWN ON THE CONSTRUCTION DRINKINGS) SHALL BE SHOWN ON THE CONSTRUCTION DRINKINGS.

ALL THE FACILITIES AND UTILITIES OF THE SITE (INCLUDING THE FACILITIES AND UTILITIES SHOWN ON THE CONSTRUCTION DRINKINGS) SHALL BE SHOWN ON THE CONSTRUCTION DRINKINGS.

**NOTE:**

ALL THE FACILITIES AND UTILITIES OF THE SITE (INCLUDING THE FACILITIES AND UTILITIES SHOWN ON THE CONSTRUCTION DRINKINGS) SHALL BE SHOWN ON THE CONSTRUCTION DRINKINGS.

ALL THE FACILITIES AND UTILITIES OF THE SITE (INCLUDING THE FACILITIES AND UTILITIES SHOWN ON THE CONSTRUCTION DRINKINGS) SHALL BE SHOWN ON THE CONSTRUCTION DRINKINGS.

ALL THE FACILITIES AND UTILITIES OF THE SITE (INCLUDING THE FACILITIES AND UTILITIES SHOWN ON THE CONSTRUCTION DRINKINGS) SHALL BE SHOWN ON THE CONSTRUCTION DRINKINGS.

PLANS PREPARED UNDER THE DIRECTION OF:

**Exhibit 4**  
 Page 1 of 1

ETM  
 VISION • EXPERIENCE • RESULTS

**Boyd Property**  
 FOR  
**DUVAL COUNTY, FLORIDA**

**PUD VERIFICATION MAP**

ETM NO. 22-032  
 DRAWN BY: SAS  
 DESIGNED BY: SAS  
 CHECKED BY: DW  
 DATE: JULY 2022