

**MODIFICATION SUMMARY**

APARTMENT COUNT	EXISTING CONDITION	PROPOSED CONDITION
APARTMENT UNITS TO REMAIN	270	270
TOTAL UNIT COUNT	270	300
UNITS PER ACRE	154	221

**PARKING COUNT**

ADJ. SURFACE PARKING	ADJ. SURFACE PARKING
ADJ. SURFACE PARKING	459
ADJ. SURFACE PARKING	15
ADJ. SURFACE PARKING	17
ADJ. SURFACE PARKING	0
ADJ. SURFACE PARKING	62
ADJ. SURFACE PARKING	3
ADJ. SURFACE PARKING	499
ADJ. SURFACE PARKING	300
ADJ. SURFACE PARKING	146

**OPEN / RECREATIONAL SPACE**

OPEN / RECREATIONAL SPACE (SQ)	OPEN / RECREATIONAL SPACE (SQ)
OPEN / RECREATIONAL SPACE (SQ)	62,685
OPEN / RECREATIONAL SPACE (SQ)	209

**ACTIVE RECREATIONAL AREA**

ACTIVE RECREATIONAL AREA (SQ)	ACTIVE RECREATIONAL AREA (SQ)
ACTIVE RECREATIONAL AREA (SQ)	66,715
ACTIVE RECREATIONAL AREA (SQ)	66,715
ACTIVE RECREATIONAL AREA (SQ)	209
ACTIVE RECREATIONAL AREA (SQ)	189*

**NOTES**

\* COMPENSATING PLAN REQUIRES 100 SF PER UNIT OF ACTIVE RECREATIONAL AREA AS THE SF > 150 SF THIS REQUIREMENT IS MET.

**LEGEND**

THIS SPACE WAS ORIGINALLY DEVELOPED UNDER ORDINANCE 2007-28-FC  
RECREATIONAL AREA

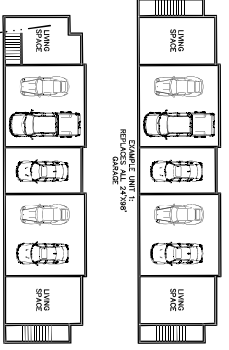

1. DEMOLISH EXISTING 8 UNIT CARriage UNITS (DRAWN)
2. CONSTRUCT NEW STRUCTURES MORE OR LESS AS SHOWN (A) EACH NEW STRUCTURE WILL CONTAIN TWO HIGH CARriage STYLE DWELLING UNITS (B) ONE UNIT OF EACH CARriage UNIT WILL BE A CARriage UNIT WITH A CAR (C) THE REMAINING SPACE ON THE SECOND FLOOR ABOVE THE CARriages WILL BE A CARriage UNIT WITH A CAR (D) THE REMAINING SPACE ON THE SECOND FLOOR WILL CONTAIN ONE NEW SINGLE BAY, TWO CARriage UNITS

<p>Scale: 1 OF 1</p>	<p>POINTE AT JAMES ISLAND</p> <p>DUVAL COUNTY</p> <p>PREPARED FOR THE DERMOT COMPANY</p>	<p>PUD MODIFICATION</p>	<p><b>Connelly &amp; Wicker Inc.</b></p> <p>Planning • Engineering • Landscape Architecture</p> <p>10060 Skinner Lake Drive, Suite 500 Jacksonville, Florida 32246 (904) 265-3030 FAX: (904) 265-3031 www.cwieng.com Florida Registry #650 L.A. Number: LC26000311</p>
	<p>ERIC D. EVANS P.E. NUMBER: 92585 Reg. Engineer</p>	<p>DATE: 09/29/2023</p> <p>BY: EDC</p> <p>CHK: EDC</p> <p>APP: EDC</p> <p>DATE: 09/29/2023</p>	<p>THIS DRAWING IS THE PROPERTY OF CONNELLY &amp; WICKER INC. AND IS NOT TO BE REPRODUCED OR COPIED IN WHOLE OR IN PART. IT IS NOT TO BE USED ON ANY OTHER PROJECT AND IS TO BE RETURNED ON REQUEST.</p>