



VICINITY MAP
N.T.S.

DEVELOPMENT SUMMARY	
A. PROJECT NAME	ONE MORE CHILD CAMPUS
B. ZONING DESIGNATION/PUD	COMMERCIAL
C. CITY DEVELOPMENT NUMBER	2000
D. CITY DEVELOPMENT NUMBER	2000
E. OWNER/DEVELOPER NAME, ADDRESS, PHONE NUMBER	FLORIDA BAPTIST CHILDREN'S HOME + ONE MORE CHILD 2300 BARTRAM ROAD, JACKSONVILLE, FL 32258 PHONE: (904) 721-2711
F. ENGINEER NAME, ADDRESS, PHONE NUMBER	ENGLAND-THIMS & MILLER, INC. 14775 OLD ST. AUGUSTINE ROAD JACKSONVILLE, FLORIDA 32258 PHONE: (904) 642-8990
G. DATA SUMMARY	1. TOTAL PROJECT AREA: 11.0 AC± 2. TOTAL LOT AREA: 11.0 AC± 3. TOTAL LOT NUMBER: 15087-0080
H. SITE DESCRIPTION	1. FEMA FLOOD ZONE: X 2. UTILITY SERVICES: WATER, SEWER, GAS, ELECTRICITY 3. WATER SUPPLY: JEA 4. LOT REQUIREMENTS: 7,000 s.f. 5. MIN. LOT WIDTH: 70' 6. MIN. LOT DEPTH: 70' 7. MIN. LOT COVERAGE: 0.3 FAR AGGREGATE OVER PUD 8. SETBACK FROM PARENT PARCEL: 20' 9. MIN. SIDE SETBACK: 10' 10. MIN. REAR SETBACK: 10' 11. MAX. HEIGHT OF STR.: 50'

PARKING REQUIREMENTS	
OFF-STREET PARKING REQUIREMENTS	
OFFICE & RESOURCE CENTER	3 SPACES PER 1000 SF GROSS FLOOR AREA
COMPASSION CENTER	1 SPACES PER 2000 SF GROSS FLOOR AREA
ACCESSIBLE PARKING REQUIREMENTS	** PER FLORIDA STATUTE 316.1955 & 316.1956 ** PER ADAA 2002
BICYCLE PARKING REQUIREMENTS	** 2% OF THE REQUIRED OFF STREET PARKING (PER COU)
RESIDENTIAL PARKING REQUIREMENTS	2 SPACES PER UNIT

NOTES	
1.	PROPOSED DRIVEWAY LOCATIONS ARE SUBJECT TO CITY AND FDOT APPROVAL
2.	WETLAND MITIGATION REQUIRED
3.	OUTPARCEL BUILDINGS ARE SHOWN FOR ILLUSTRATION PURPOSES ONLY
4.	STORMWATER POND #1 MAY BE LOCATED IN THE PARCEL NO. SETBACK PERMITTING
5.	FINAL BUILDING CONFIGURATIONS IS SUBJECT TO FINAL DESIGN AND PERMITTING

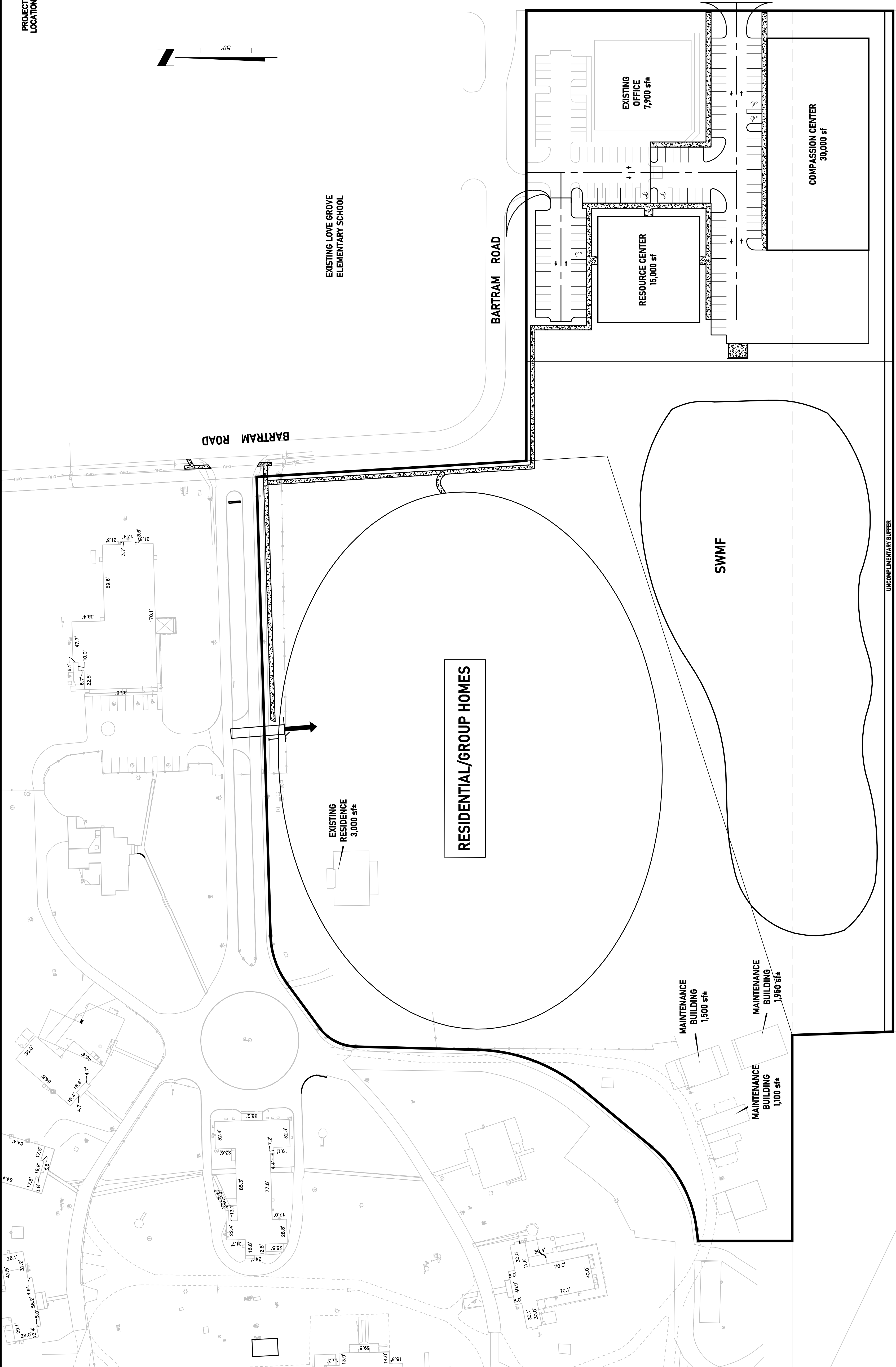

June 30, 2021

Exhibit 4
Page 1 of 1

PUD SITE PLAN

**ONE MORE CHILD CAMPUS
JACKSONVILLE**

England-Thims & Miller, Inc.
14775 Old St. Augustine Road
Jacksonville, FL 32258
TEL: (904) 642-8990
FAX: (904) 646-9485
REG - 2584 LC - 0000316

ETM
VISION • EXPERIENCE • RESULTS

EXISTING MULTI-FAMILY
COMPLEX